

REQUESTED BY
Stewart Title of Douglas County
IN OFFICIAL RECORDS OF
DOUGLAS CO., NEVADA

2004 OCT -7 AM 10:15

WERNER CHRISTEN
RECORDER

\$17⁰⁰ PAID *CF* DEPUTY

APN 1320-29-211-006

AFTER RECORD MAIL TO:
MR. AND MRS FRANK
1099 WISTERIA DRIVE
MINDEN, NV 89423

RPTT #3

GRANT, BARGAIN, SALE DEED
(Title of Document)

THIS DEED IS BEING RE-RECORDED TO SHOW CORRECT LEGAL DESCRIPTION

This page added to provide additional information required by NRS 111.312 Sections 1-2.
(Additional recording fee applies)

This cover page must be typed.

0626015

BK1004PG02370

EXHIBIT "A"

LEGAL DESCRIPTION

ESCROW NO.: S40802037

The land referred to herein is situated in the
State of Nevada, County of DOUGLAS
City of GARDNERVILLE described as follows:

~~Lot 944, as shown on the map of GARDNERVILLE RANCHOS UNIT
NO. 7, filed for record in the office of the County
Recorder of Douglas County, Nevada, on March 27, 1974, as
Document No. 72456.~~

~~Assessors Parcel No. 1220 22 410-132~~

0626015

0623857

BK1004PG02372

BK0904PG03729

EXHIBIT "A"

LEGAL DESCRIPTION

ESCROW NO.: 040802029

The land referred to herein is situated in the State of Nevada, County of Douglas described as follows:

Lot 240 as shown on the official plat of WINHAVEN, UNIT NO. 6, filed for record in the office of the County Recorder of Douglas County, Nevada on August 4, 1994, in Book 894 of Official Records at page 692, as Document No. 343273.

Assessor's Parcel No. 1320-29-211-006

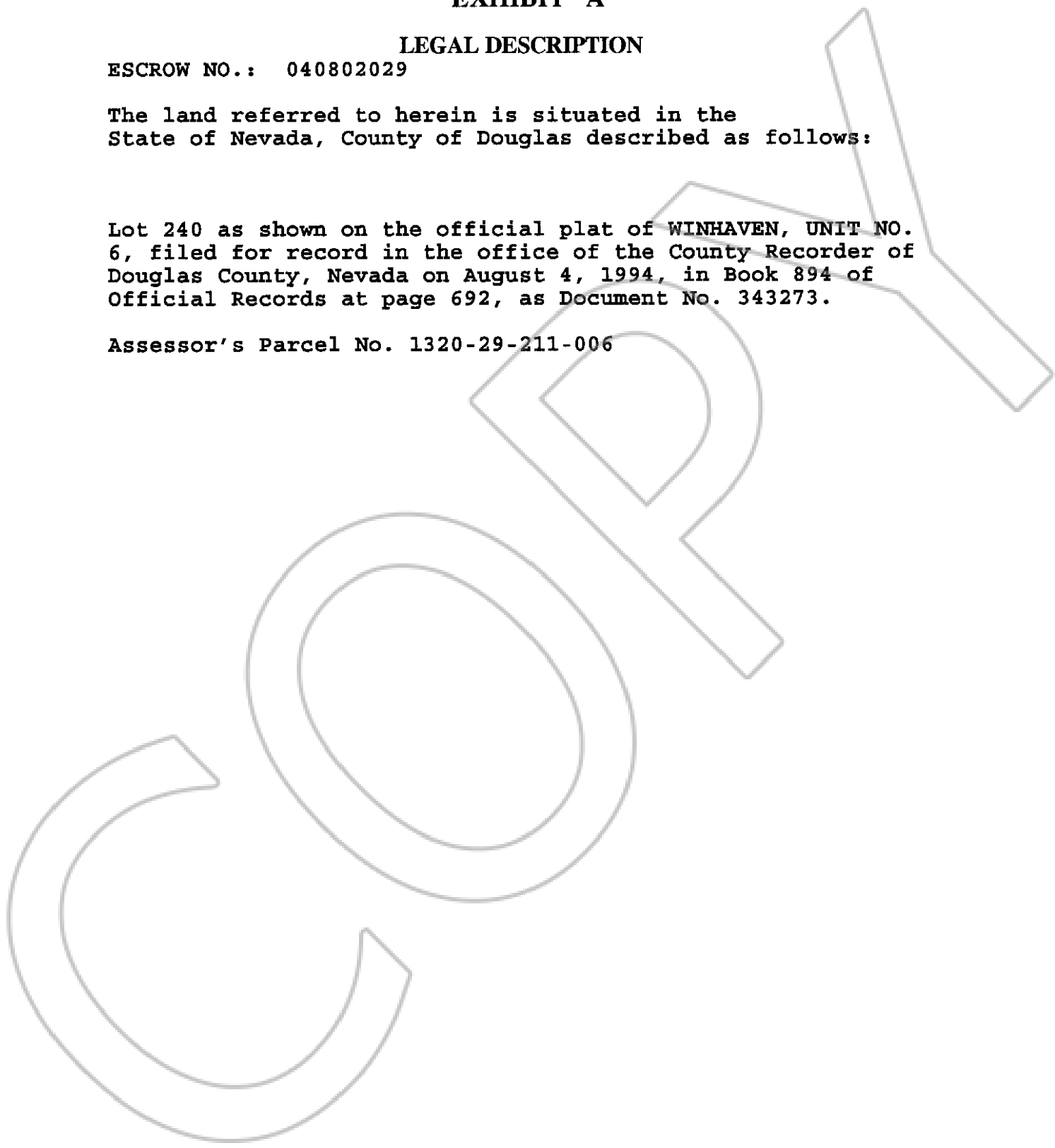

0626015

BK1004PG02373