

REQUESTED BY
WESTERN TITLE COMPANY, INC.
IN OFFICIAL RECORDS OF
DOUGLAS CO., NEVADA

2004 OCT -8 PM 3:47

WERNER CHRISTEN
RECORDER

\$16⁰⁰ PAID. *KJ* DEPUTY

APN: 1220-16-810-080
RPTT \$0.00 #5

WHEN RECORDED MAIL TO:
Name MIGUEL DUARTE
Street 1392 LANGLEY DRIVE
Address
City, State GARDNERVILLE, NV 89460
Zip

MAIL TAX STATEMENTS TO:
Name MIGUEL DUARTE
Street 1392 LANGLEY DRIVE
Address
City, State GARDNERVILLE, NV 89460
Zip
Order No. 00090301-201- LS

(SPACE ABOVE THIS LINE FOR RECORDERS USE)

GRANT, BARGAIN AND SALE DEED

THIS INDENTURE WITNESSETH: That LILIANA DUARTE, a married woman, in consideration of \$10.00, the receipt of which is hereby acknowledged, does hereby Grant, Bargain, Sell and Convey to MIGUEL DUARTE, a married man as his sole and separate property all that real property situated in the City of N/A, County of Douglas, State of Nevada described as follows:

See Exhibit A attached hereto and made a part hereof.

TOGETHER with all and singular the tenements, hereditaments and appurtenances, if any, thereto belonging or appertaining, and any reversions, remainders, rents, issues or profits thereof.

Grantor and Grantee are wife and husband. It is the intention of Grantor that Grantee shall henceforth have and hold said real property as his sole and separate property. By this conveyance, Grantor releases any community interest that she might now have or be presumed to hereafter acquire in the above described property.

Dated: October 5, 2004

0626206

BK1004PG03296

Liliana Duarte Liliana Duarte
LILIANA DUARTE

STATE OF NEVADA

} ss

COUNTY OF DOUGLAS

This instrument was acknowledged before me on

OCTOBER 6 2004

by LILIANA DUARTE

Lori Mae Silva
Notary Public



0626206

BK1004PG03297

Exhibit A

All that real property situate in the County of Douglas, State of Nevada, described as follows:

Lot 23, in Block H, as said lot and block are shown on the map of GARDNERVILLE RANCHOS UNIT NO. 4, filed in the office of the County Recorder of Douglas County, State of Nevada, on April 10, 1967, in Map Book 1, Page 055, Filing No. 35914.

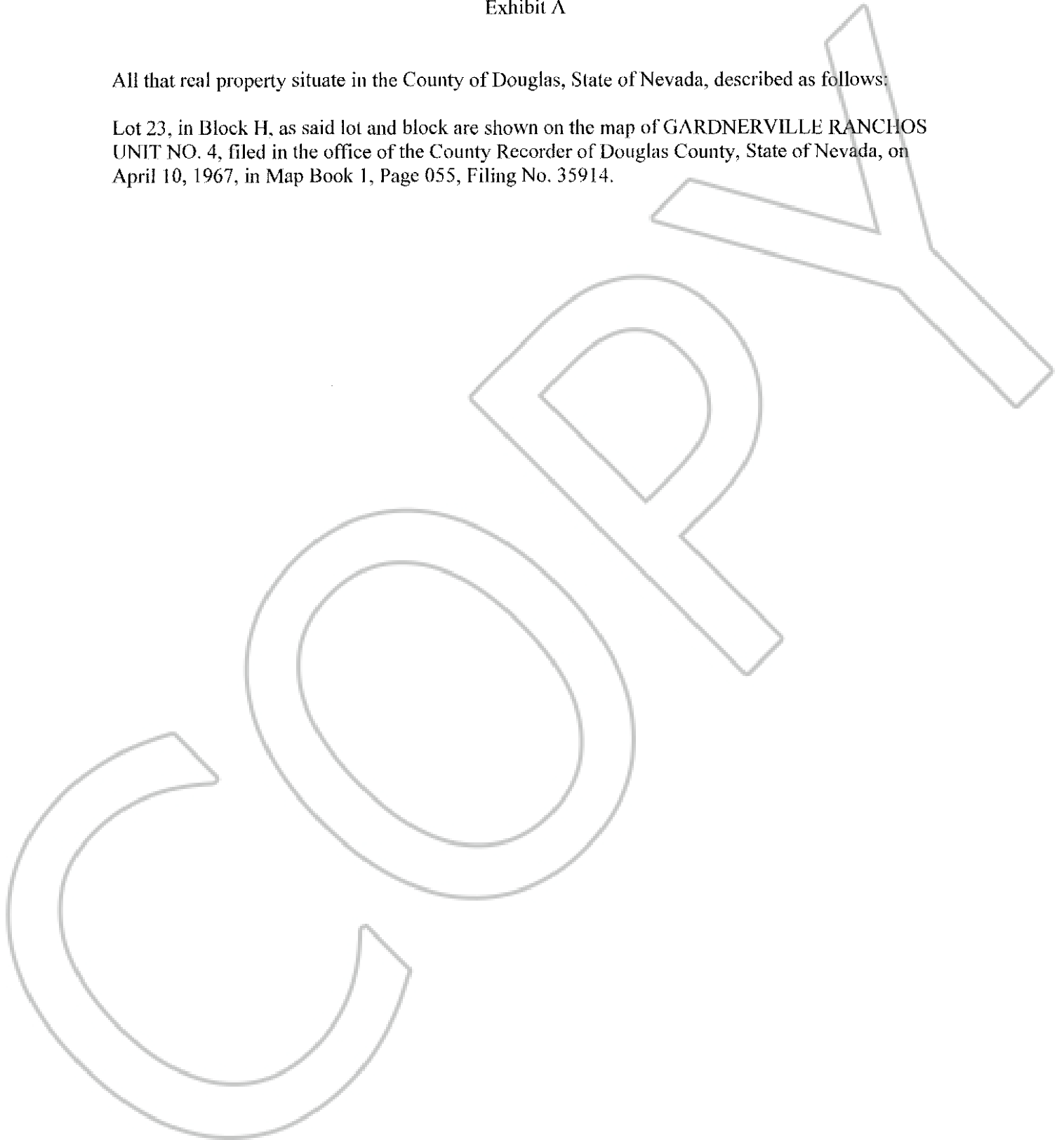

0626206
BK 1004 PG 03298