

A.P.N. # 1220-17-311-008

R.P.T.T.S. 2827-509 #9

ESCROW NO. 040701746

RECORDING REQUESTED BY:  
**STEWART TITLE COMPANY**  
MAIL TAX STATEMENTS TO:  
**SAME AS BELOW**

WHEN RECORDED MAIL TO:  
**GRANTOR**  
**1100 AMARILLO DRIVE**  
**MINDEN, NV 89410**

REQUESTED BY  
**Stewart Title of Douglas County**  
IN OFFICIAL RECORDS OF  
DOUGLAS CO., NEVADA

2004 OCT 11 PM 3:50

WERNER CHRISTEN  
RECORDER

\$ 15.00 PAID Kj DEPUTY

(Space Above for Recorder's Use Only)

### GRANT, BARGAIN, SALE DEED

THIS INDENTURE WITNESSETH: That **PHILIP L. ELLIS, EXECUTOR FOR THE ESTATES OF JERROLD L. JOHNSON AND LAUREEN E. JOHNSON, BOTH DECEASED**

in consideration of \$10.00, the receipt of which is hereby acknowledged, does hereby Grant, Bargain Sell and Convey to **RUSSELL L. JOHNSON, AN UNMARRIED MAN**

and to the heirs and assigns of such Grantee forever, all that real property situated in the County of **Douglas** State of Nevada, bounded and described as:

**SEE EXHIBIT "A" ATTACHED HERETO AND MADE A PART HEREOF**

Together with all and singular the tenements, hereditaments and appurtenances thereunto belonging or in anywise appertaining, and any reversions, remainders, rents, issues or profits thereof.

DATE: **July 12, 2004** **ESTATE OF JERROLD L. JOHNSON AND LAUREEN E. JOHNSON, DECEASED**

BY: Philip L. Ellis  
**PHILIP L. ELLIS**  
**EXECUTOR**

BY: \_\_\_\_\_

STATE OF Nevada }  
COUNTY OF Douglas } ss.



This instrument was acknowledged before me on 8-23-04  
by, **PHILIP L. ELLIS**

Signature [Signature]  
Notary Public (One Inch Margin on all sides of Document for Recorders Use Only)

0626352  
BK1004PG03990

**EXHIBIT "A"**

**LEGAL DESCRIPTION**

ESCROW NO.: 040701746

The land referred to herein is situated in the  
State of Nevada, County of Douglas  
City of GARDNERVILLE described as follows:

Lot 5, Block B, as shown on the Official Map of CHAMBERS  
FIELD SUBDIVISION, filed in the office of the County  
Recorder of Douglas County, State of Nevada, on January 9,  
1979, as Document No. 28862.

Assessors Parcel No. 1220-17-311-008

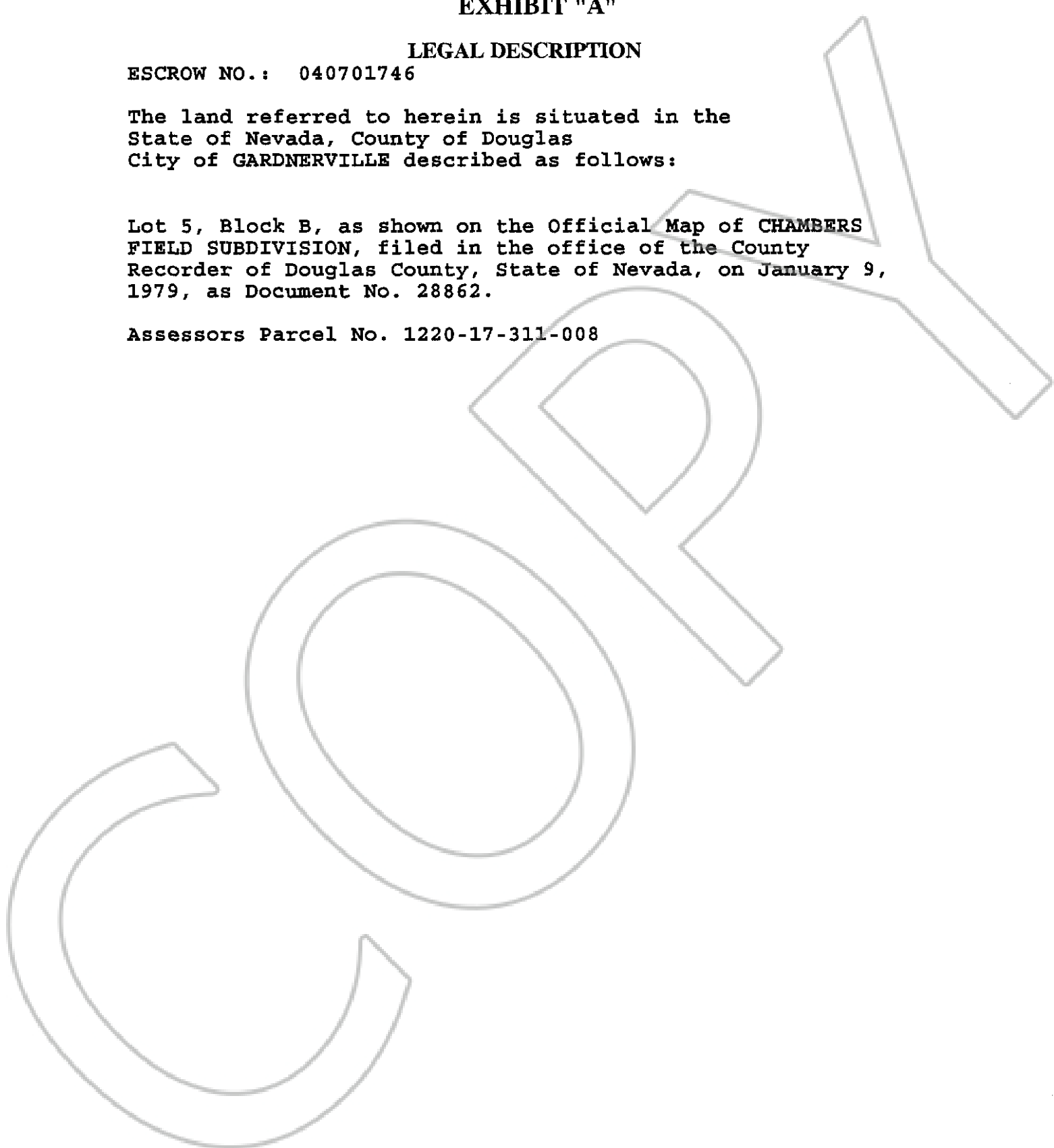

0626352

BK1004PG03991