

EXHIBIT "A"

LEGAL DESCRIPTION

ESCROW NO.: 040302859

The land referred to herein is situated in the State of Nevada, County of DOUGLAS described as follows:

Lot 4, Block 7, as shown on the map of Mountain View Estates Unit No. 3, recorded May 21, 1985, in Book 585, Page 1696, Document No. 117600, Official Records of Douglas County, State of Nevada.

Assessors Parcel No. 1420-33-611-004

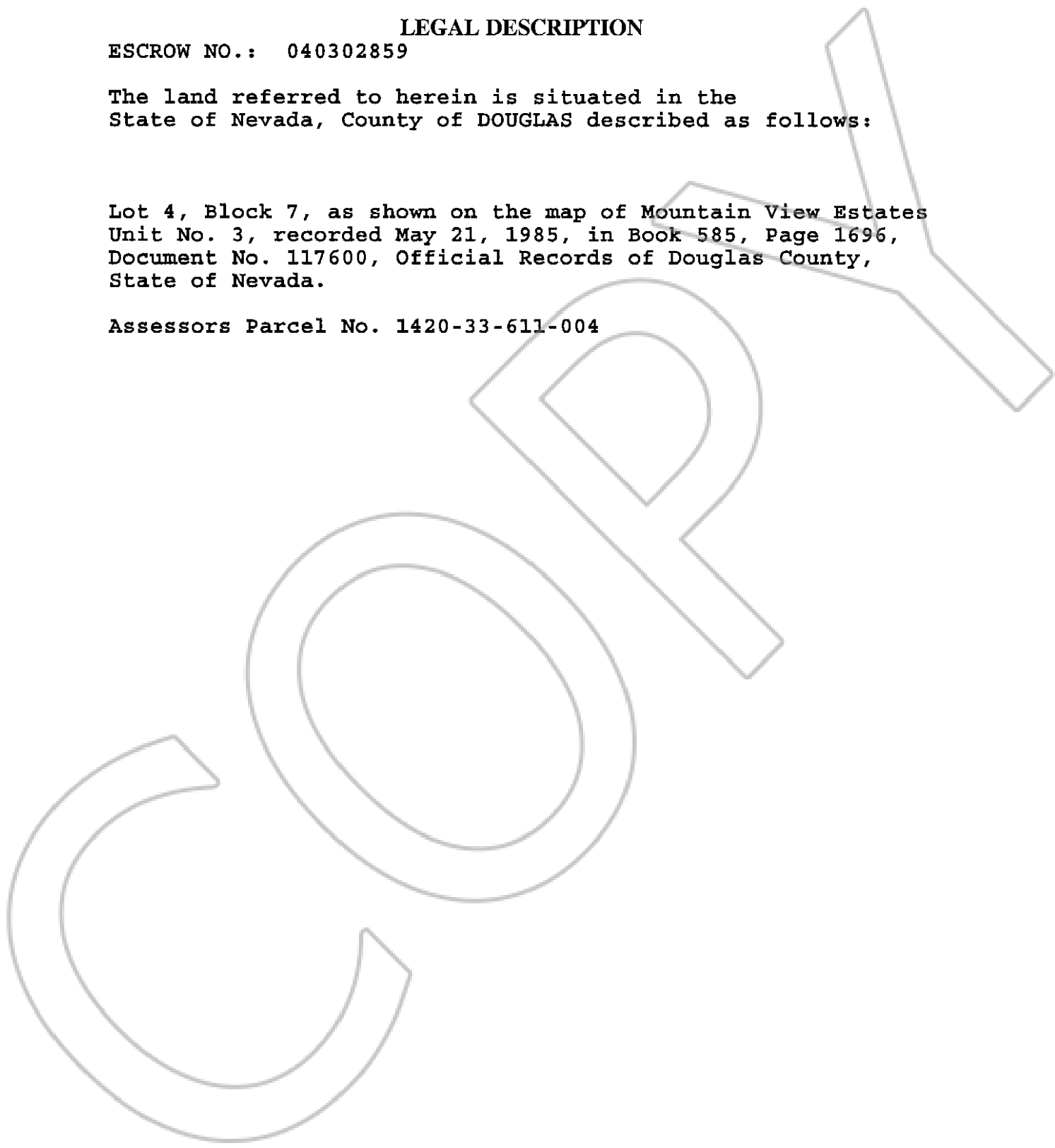

0626473
BK1004PG04610