

A.P.N. # 1420-08-210-029

R.P.T.T. \$ 1015.95  
ESCROW NO. 040702715

RECORDING REQUESTED BY:  
**STEWART TITLE COMPANY**  
MAIL TAX STATEMENTS TO:  
**SAME AS BELOW**

WHEN RECORDED MAIL TO:  
**GRANTEE**  
**1350 RABBITBRUSH**  
**GARDNERVILLE, NV 89410**

REQUESTED BY  
**Stewart Title of Douglas County**  
IN OFFICIAL RECORDS OF  
DOUGLAS CO., NEVADA

2004 OCT 14 AM 10:30

WERNER CHRISTEN  
RECORDER

\$ 15.00 PAID. KJ DEPUTY

(Space Above for Recorder's Use Only)

**GRANT, BARGAIN, SALE DEED**

THIS INDENTURE WITNESSETH: That **RICHARD R. COSTA, TRUSTEE UNDER**  
**DECLARATION OF TRUST DATE SEPTEMBER 17, 1997**

in consideration of \$10.00, the receipt of which is hereby acknowledged, does hereby Grant, Bargain Sell  
and Convey to **CARVALEEN M ELODI BLANTON, AN UNMARRIED WOMAN**

and to the heirs and assigns of such Grantee forever, all that real property situated in the  
**unincorporated area** County of **DOUGLAS** State of Nevada, bounded and described as:

**SEE EXHIBIT "A" ATTACHED HERETO AND MADE A PART HEREOF**

Together with all and singular the tenements, hereditaments and appurtenances thereunto belonging or in  
anywise appertaining, and any reversions, remainders, rents, issues or profits thereof.

DATE: **September 23, 2004** ~~DECLARATION OF TRUST DATE~~  
~~SEPTEMBER 17, 1997~~

BY: *[Signature]*  
**RICHARD R. COSTA**  
**TRUSTEE**

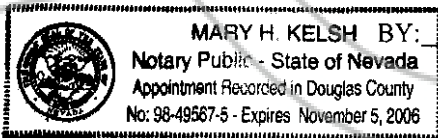

STATE OF Nevada }  
COUNTY OF Douglas } ss.

This instrument was acknowledged before me on 9-24-04  
by RICHARD R. COSTA

Signature *Mary H Kelsch*  
Notary Public (One Inch Margin on all sides of Document for Recorders Use Only)

0626654

BK1004PG05468

**EXHIBIT "A"**

**LEGAL DESCRIPTION**

ESCROW NO.: 040702715

The land referred to herein is situated in the State of Nevada, County of DOUGLAS unincorporated area described as follows:

Lot 5, in Block E, as set forth on that certain Final Map of SUNRIDGE HEIGHTS, PHASE 3, a Planned Unit Development, recorded in the office of the Douglas County Recorder on June 1, 1994 in Book 694, Page 1, as Document No. 338607, Official Records.

Assessor's Parcel No. 1420-08-210-029.

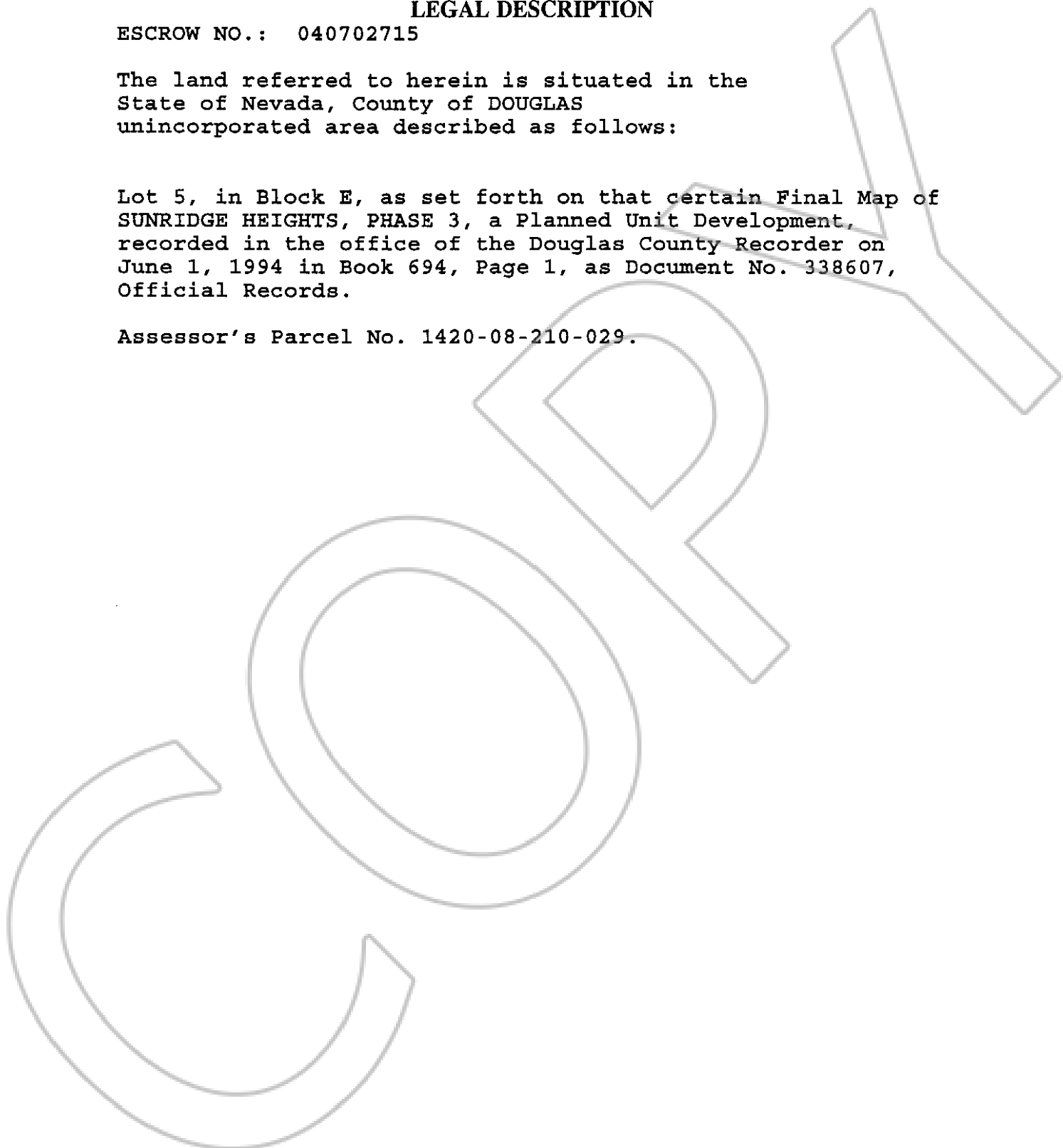

0626654  
BK1004PG05469