

EXHIBIT "A"

LEGAL DESCRIPTION

The land referred to herein is situated in the State of Nevada, County of DOUGLAS described as follows:

Lot 21, Block D, as set forth on FINAL SUBDIVISION MAP No. 1006-12 for CHICHESTER ESTATES, PHASE 12, filed in the office of the County Recorder of Douglas County, Nevada and recorded January 8, 2004, in Book 0104, Page 2012, as Document No. 601490.

Assessor's Parcel No. 1320-33-817-021

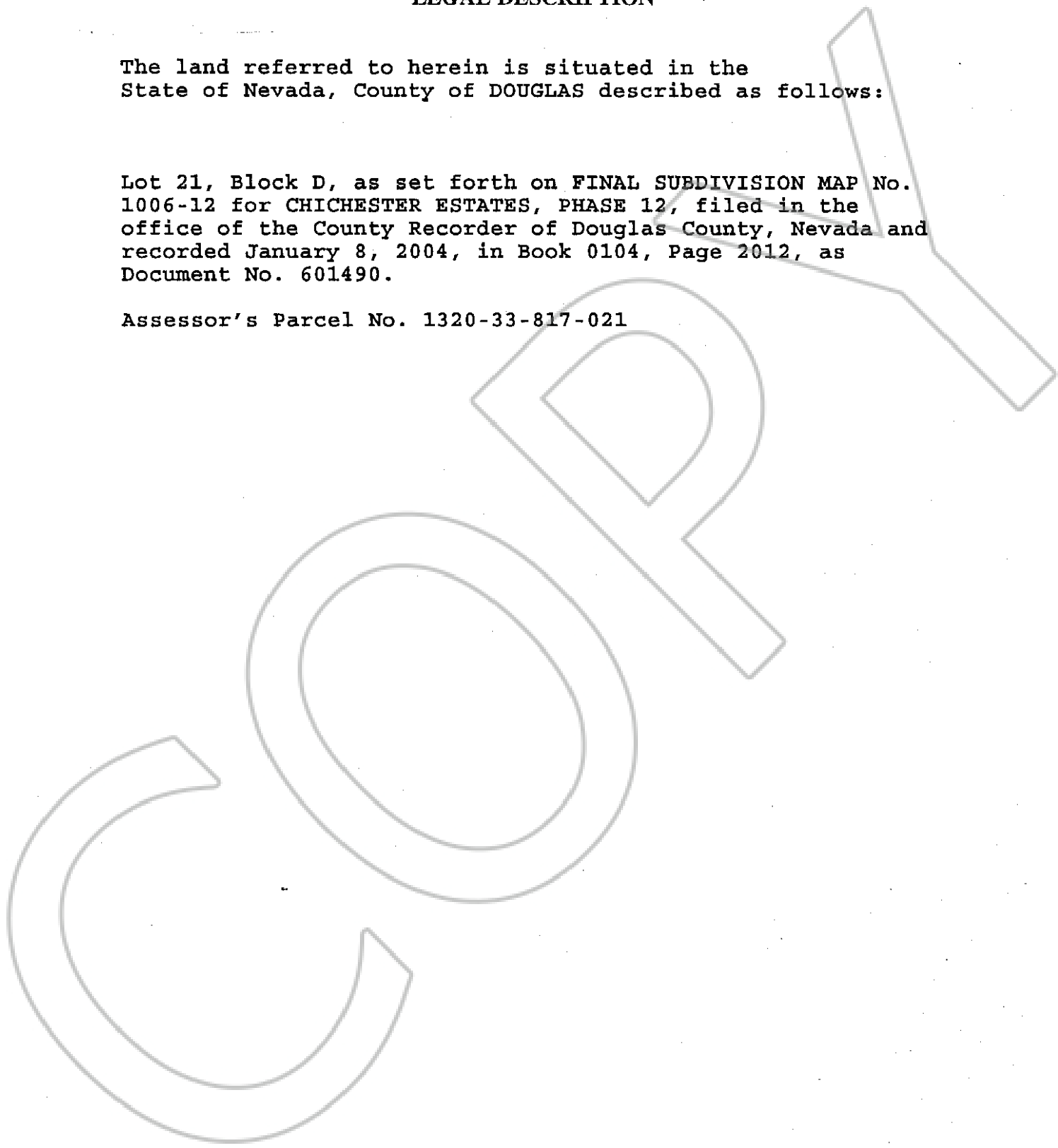

0627031

BK1004PG07545