

A.P.N. # 1320-33-817-021

R.P.T.T. \$ 00.00 #5

RECORDING REQUESTED BY:

MAIL TAX STATEMENTS TO:  
SAME AS BELOW

WHEN RECORDED MAIL TO:  
PETER M. BEEKHOF, JR.  
1528 HIGHWAY 395, STE. 215  
GARDNERVILLE, NV 89410

(Space Above for Recorder's Use Only)

REQUESTED BY  
*Peter Beechhof*  
IN OFFICIAL RECORDS OF  
DOUGLAS CO., NEVADA  
  
2004 OCT 18 PM 4:31  
  
WERNER CHRISTEN  
RECORDER  
  
\$15<sup>00</sup> PAID *31* DEPUTY

**GRANT, BARGAIN, SALE DEED**

THIS INDENTURE WITNESSETH: That LINDA S. BEEKHOF, SPOUSE OF  
GRANTEE HEREIN

in consideration of \$10.00, the receipt of which is hereby acknowledged, does hereby Grant, Bargain Sell  
and Convey to PETER M. BEEKHOF, JR., A MARRIED MAN AS HIS SOLE  
AND SEPARATE PROPERTY

and to the heirs and assigns of such Grantee forever, all that real property situated in the  
County of DOUGLAS State of Nevada, bounded and described as:

SEE EXHIBIT "A" ATTACHED HERETO AND MADE A PART HEREOF

Together with all and singular the tenements, hereditaments and appurtenances thereunto belonging or in  
anywise appertaining, and any reversions, remainders, rents, issues or profits thereof.

DATE: October 14, 2004

*Linda Beechhof*  
LINDA S. BEEKHOF

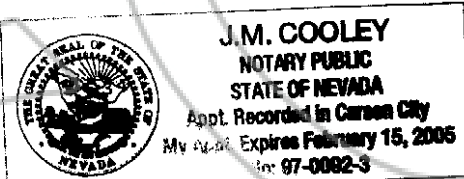

STATE OF NEVADA }  
COUNTY OF DOUGLAS } ss.

This instrument was acknowledged before me on 10-18-04  
by LINDA S. BEEKHOF

Signature *J.M. Cooley*  
Notary Public (One inch margin on all sides of document for Recorder's Use Only)

0627032  
BK1004PG07546

**EXHIBIT "A"**

**LEGAL DESCRIPTION**

The land referred to herein is situated in the State of Nevada, County of DOUGLAS described as follows:

Lot 21, Block D, as set forth on FINAL SUBDIVISION MAP No. 1006-12 for CHICHESTER ESTATES, PHASE 12, filed in the office of the County Recorder of Douglas County, Nevada and recorded January 8, 2004, in Book 0104, Page 2012, as Document No. 601490.

Assessor's Parcel No. 1320-33-817-021

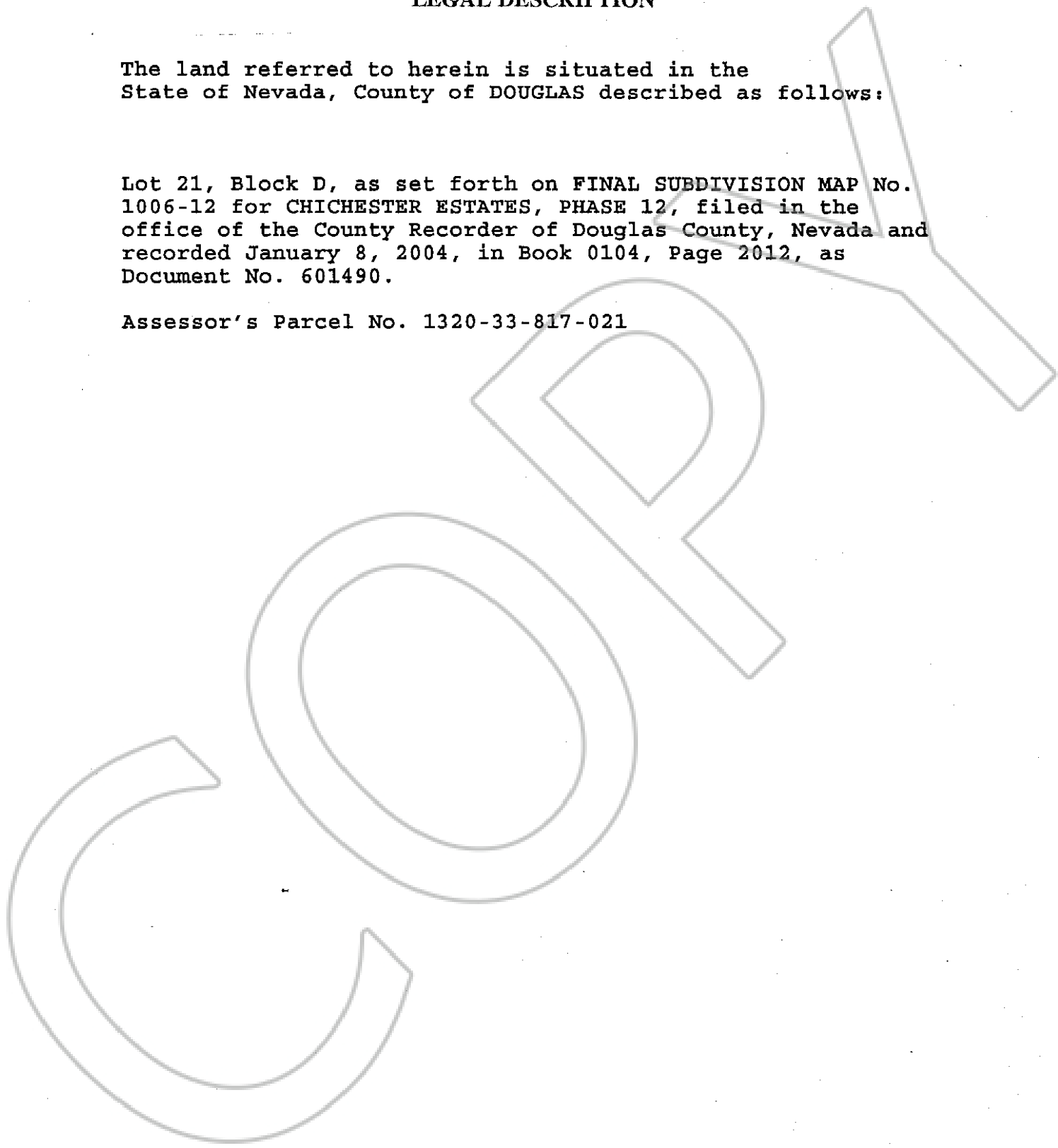

0627032

BK1004PG07547