



**EXHIBIT "A"**

**LEGAL DESCRIPTION**

ESCROW NO.: 040102341

The land referred to herein is situated in the State of Nevada, County of Douglas described as follows:

Lot 139, of Block A, as shown on the plat of SILVERADO HEIGHTS NO. 2, filed for record in the office of the County Recorder of Douglas County, Nevada, as Document No. 33717.

Assessor's Parcel No. 1420-18-113-009

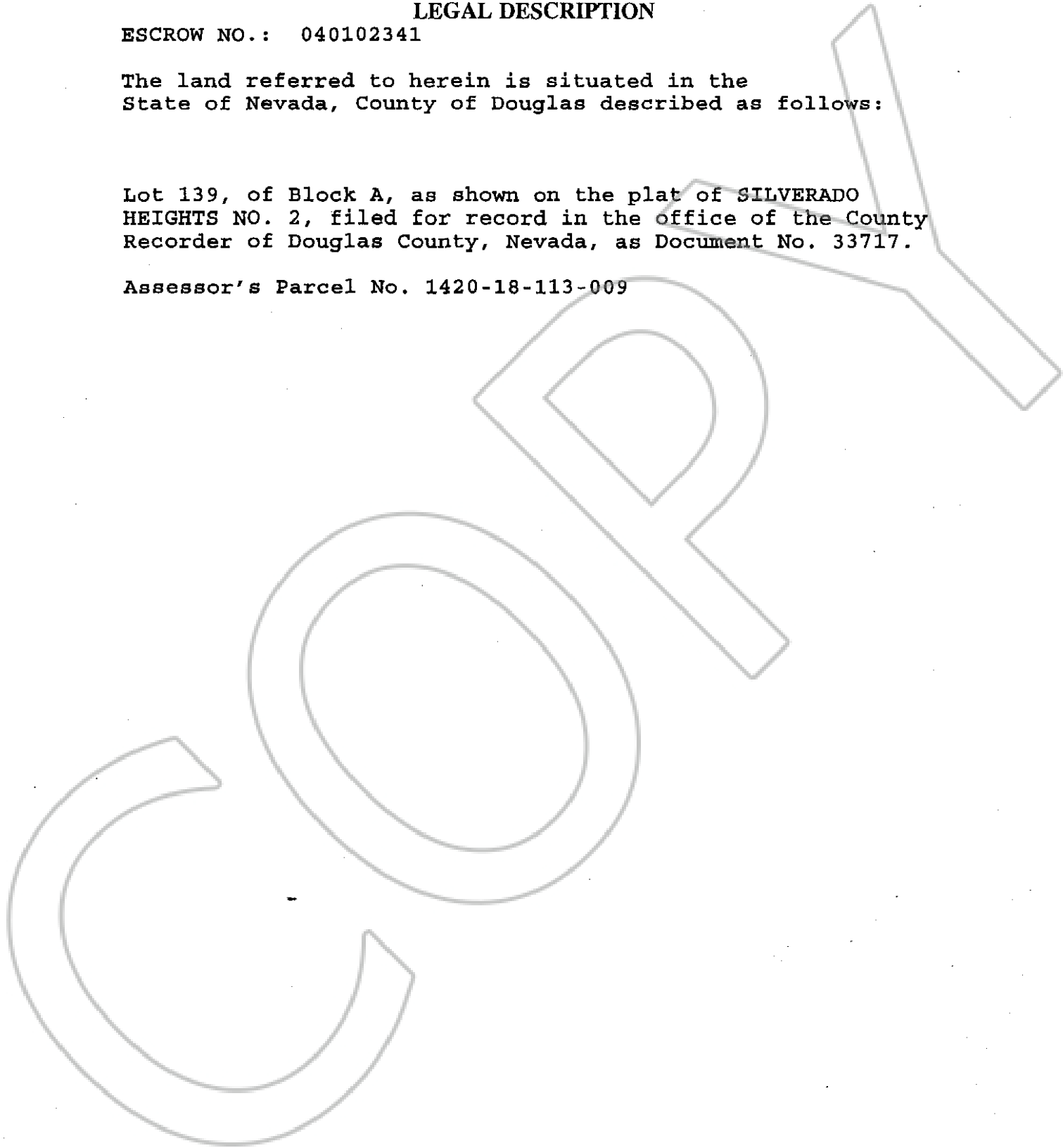

0627162

BK1004PG08121