

EXHIBIT "A"

LEGAL DESCRIPTION

ESCROW NO.: 040702727

The land referred to herein is situated in the State of Nevada, County of Douglas described as follows:

Lot 2, Block A, as set forth upon that Plat of SUNRIDGE HEIGHTS UNIT 1, PHASE A recorded December 15, 1982 in Book 1282 at page 999 of Official Records of Douglas County, Nevada as Document No. 74054.

Assessors Parcel No. 1420-07-710-002

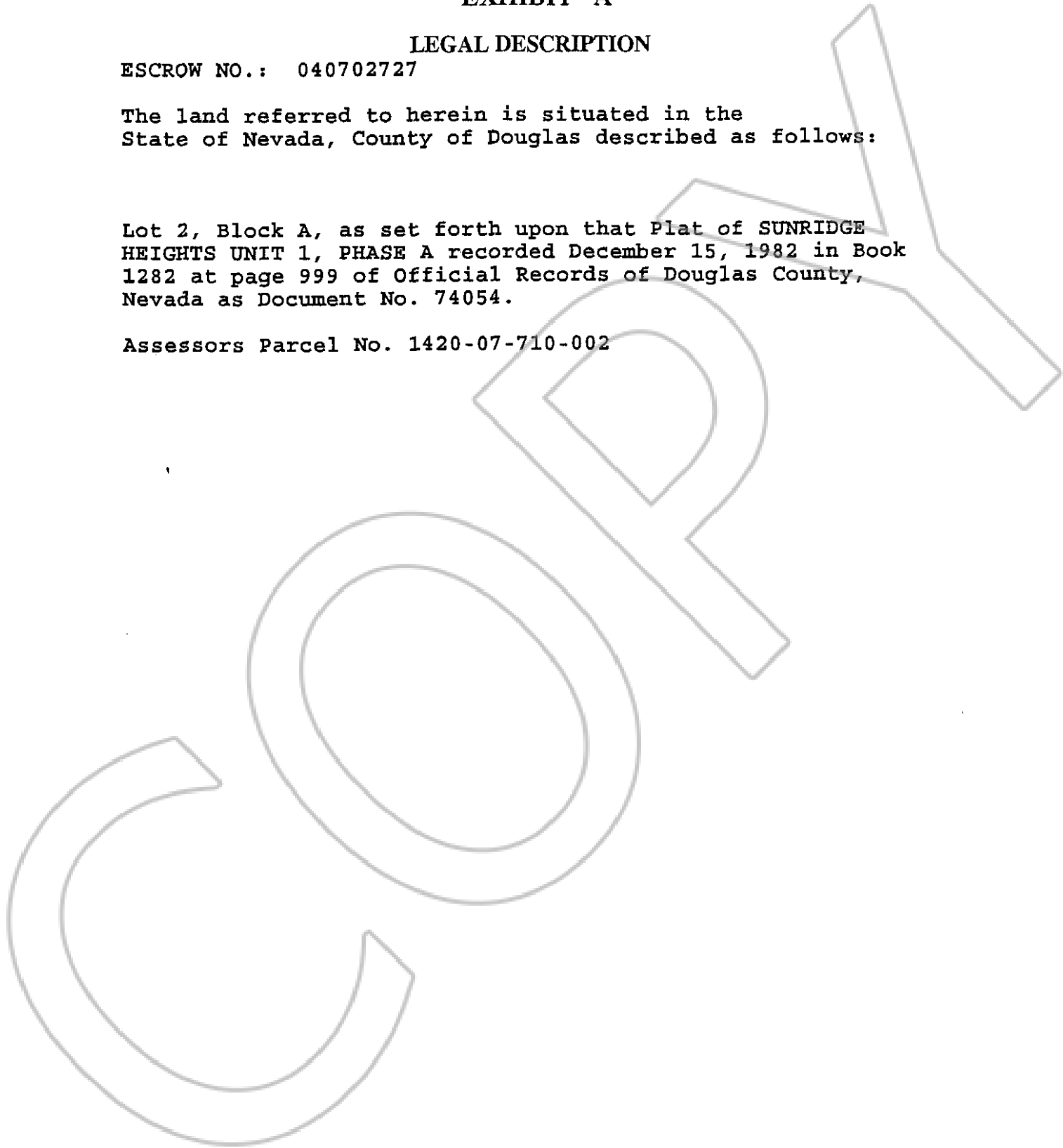

0627431

BK1004PG09502