

EXHIBIT "A"

LEGAL DESCRIPTION

ESCROW NO.: 040802407

**The land referred to herein is situated in the
State of Nevada, County of Douglas described as follows:**

**Lot 184, as shown on the map of GARDNERVILLE RANCHOS UNIT
NO. 7, filed for record in the office of the County
Recorder of Douglas County, Nevada, on March 27, 1974, as
Document No. 72456.**

Assessors Parcel No. 1220-21-810-088

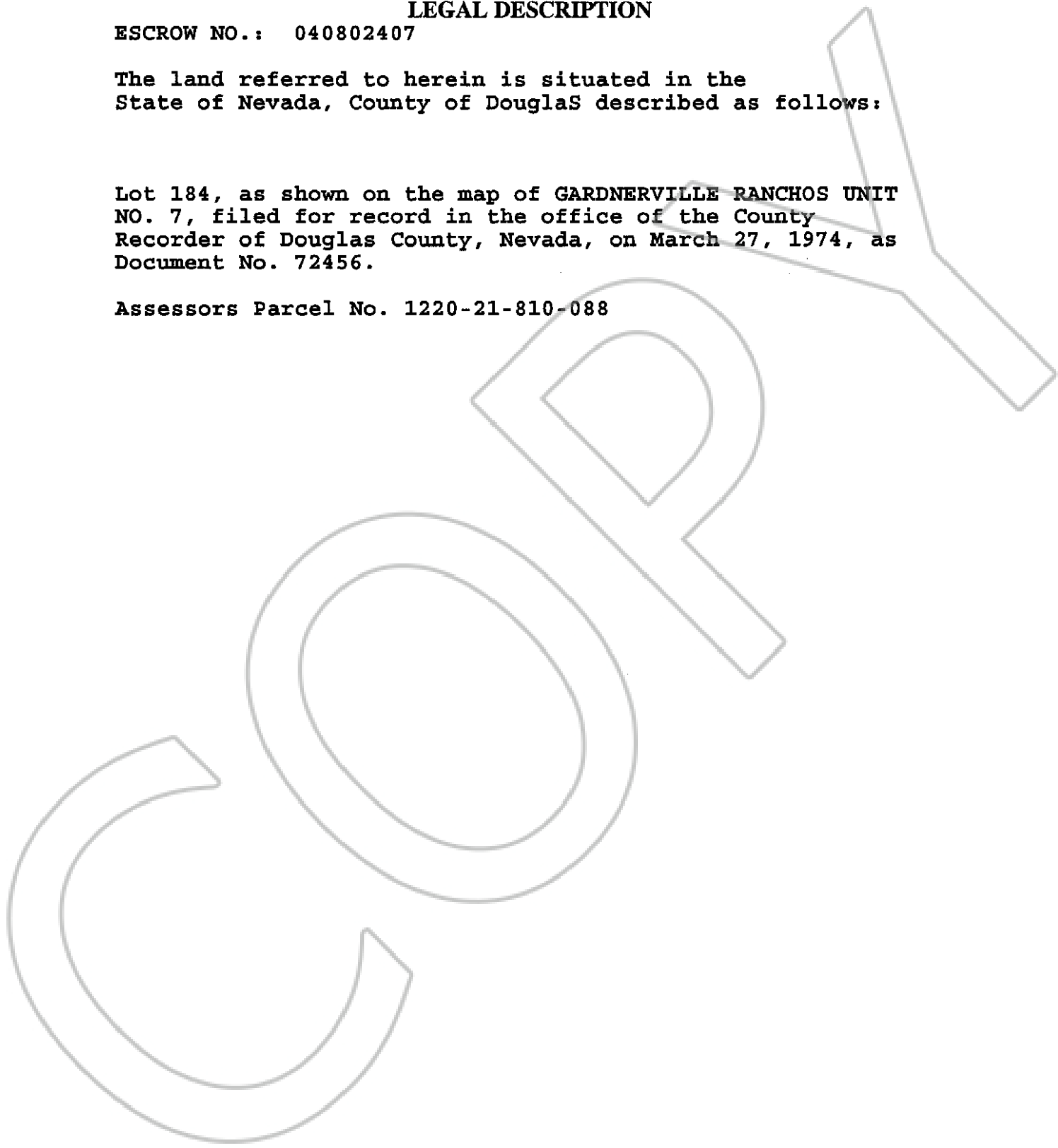

0627676

BK1004PG10720