

EXHIBIT "A"

LEGAL DESCRIPTION

ESCROW NO.: 040702708

The land referred to herein is situated in the State of Nevada, County of DOUGLAS unincorporated area described as follows:

Being a portion of the Northeast 1/4 of Section 24, Township 12, Range 20, M.D.B.&M., further described as follows:

Parcel B as shown on that Parcel Map for LINDA RUSH recorded March 5, 1992, in Book 392, of Official Records, at Page 642, Douglas County, Nevada, as Document No. 272599.

ASSESSOR'S PARCEL NO. 1220-24-601-053

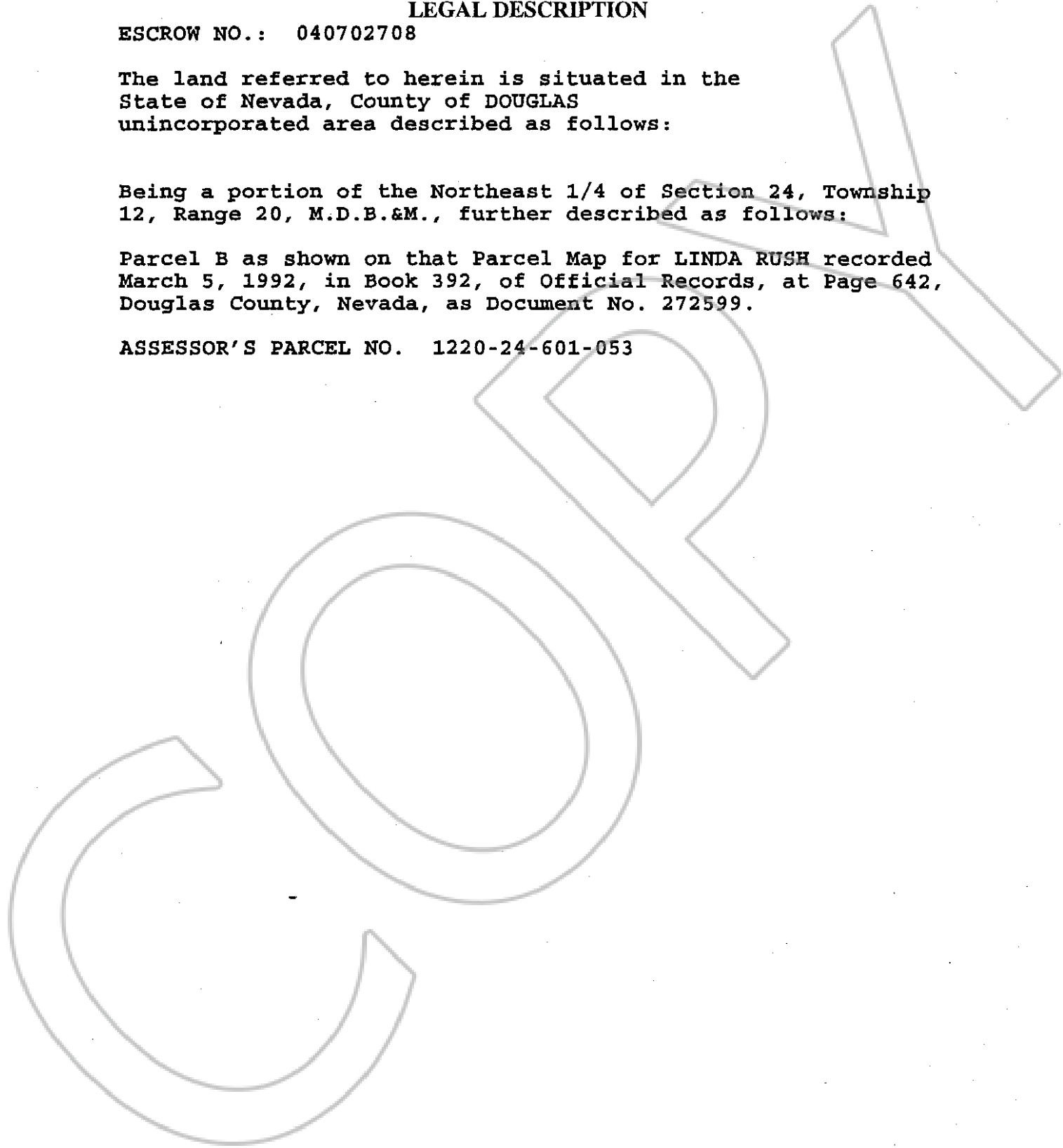

0627848

BK1004PG11964