

A.P.N. # 1319-30-712-005

R.P.T.T. \$ 2242.50

ESCROW NO. 040802393

RECORDING REQUESTED BY:  
**STEWART TITLE COMPANY**

MAIL TAX STATEMENTS TO:  
**SAME AS BELOW**

WHEN RECORDED MAIL TO:  
**GRANTEE**  
**1285 WILLOW LAKE ROAD**  
**BYRON, CA.**

REQUESTED BY  
**Stewart Title of Douglas County**

IN OFFICIAL RECORDS OF  
DOUGLAS CO., NEVADA

2004 NOV -1 PM 4:30

WERNER CHRISTEN  
RECORDER

\$ 16.00 PAID 32 DEPUTY

(Space Above for Recorder's Use Only)

### GRANT, BARGAIN, SALE DEED

THIS INDENTURE WITNESSETH: That **EVIE VIERA, A MARRIED WOMAN AS HER SOLE AND SEPARATE PROPERTY**, and **JUDITH CUTHBERTSON, A MARRIED WOMAN AS HER SOLE AND SEPARATE PROPERTY**

in consideration of \$10.00, the receipt of which is hereby acknowledged, does hereby Grant, Bargain Sell and Convey to **JACK P HERNANDEZ and LINDA G. HERNANDEZ, Husband and Wife; DENISE KALISZ, an Unmarried Woman and GARY MCELROY, an Unmarried Man, all as Joint Tenants with Right of Survivorship**

and to the heirs and assigns of such Grantee forever, all that real property situated in the County of **Douglas** State of Nevada, bounded and described as:

**SEE EXHIBIT "A" ATTACHED HERETO AND MADE A PART HEREOF**

Together with all and singular the tenements, hereditaments and appurtenances thereunto belonging or in anywise appertaining, and any reversions, remainders, rents, issues or profits thereof.

DATE: **September 20, 2004**

  
\_\_\_\_\_  
EVIE VIERA

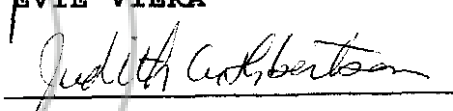
  
\_\_\_\_\_  
JUDITH CUTHBERTSON

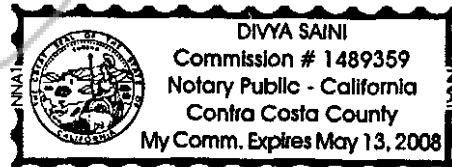

STATE OF California } ss.

COUNTY OF Contra Costa }

This instrument was acknowledged before me on 9/23/04  
by EVIE VIERA

Signature Divya Saini  
Notary Public (One inch margin on all sides of document for Recorder's Use Only)

SEAL

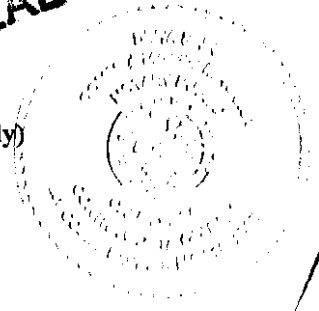

0628180

BK1104PG00647

STATE OF Nevada }  
COUNTY OF Douglas } SS.

This instrument was acknowledged before me on 9-25-04, by  
Judith Cuthbertson

WITNESS my hand and official seal.

Signature Dena Reed



COPY

0628180  
BK1104PG00648

**EXHIBIT "A"**

**LEGAL DESCRIPTION**

**ESCROW NO.: 040802393**

The land referred to herein is situated in the State of Nevada, County of Douglas described as follows:

Lot 146, A, TAHOE VILLAGE NO. 1, an amended map of Alpine Village Unit No. 1, filed in the office of the County Recorder of Douglas County, Nevada, on December 7, 1971, as Document No. 55769.

Assessor's Parcel No. 1319-30-712-005

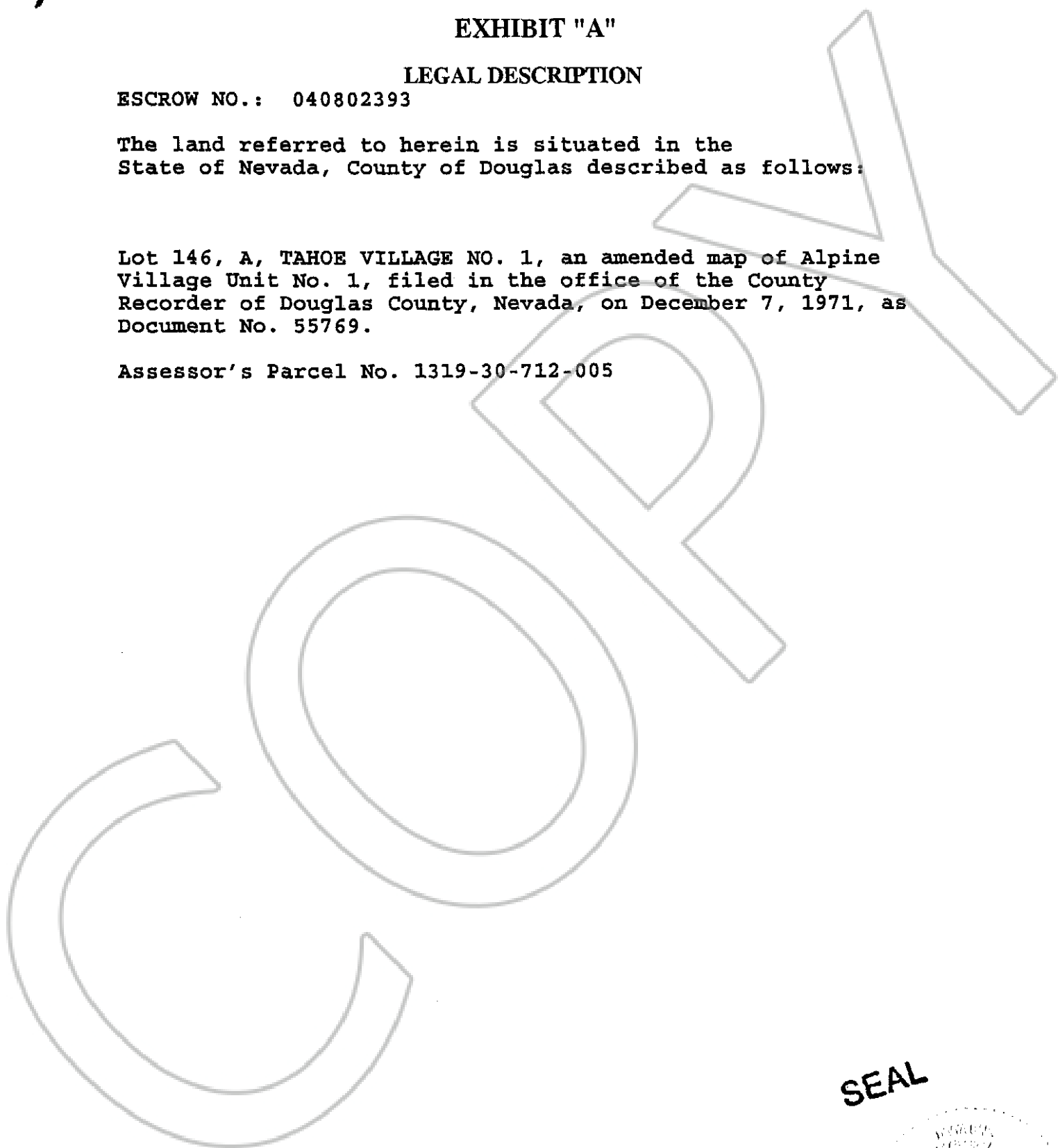

**SEAL**

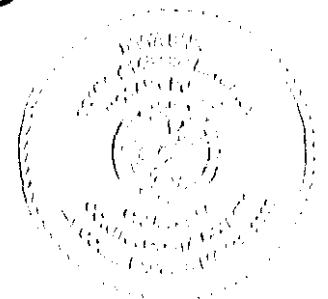

**0628180**

**BK1104PG00649**