

EXHIBIT "A"

LEGAL DESCRIPTION

ESCROW NO.: 040201768

The land referred to herein is situated in the
State of Nevada, County of DOUGLAS
City of GARDNERVILLE described as follows:

Lot 240, as shown on the map of GARDNERVILLE RANCHOS UNIT
NO. 7, filed for record in the office of the County
Recorder of Douglas County, Nevada, on March 27, 1974, as
Document No. 72456.

Assessors Parcel No. 1220-21-810-100

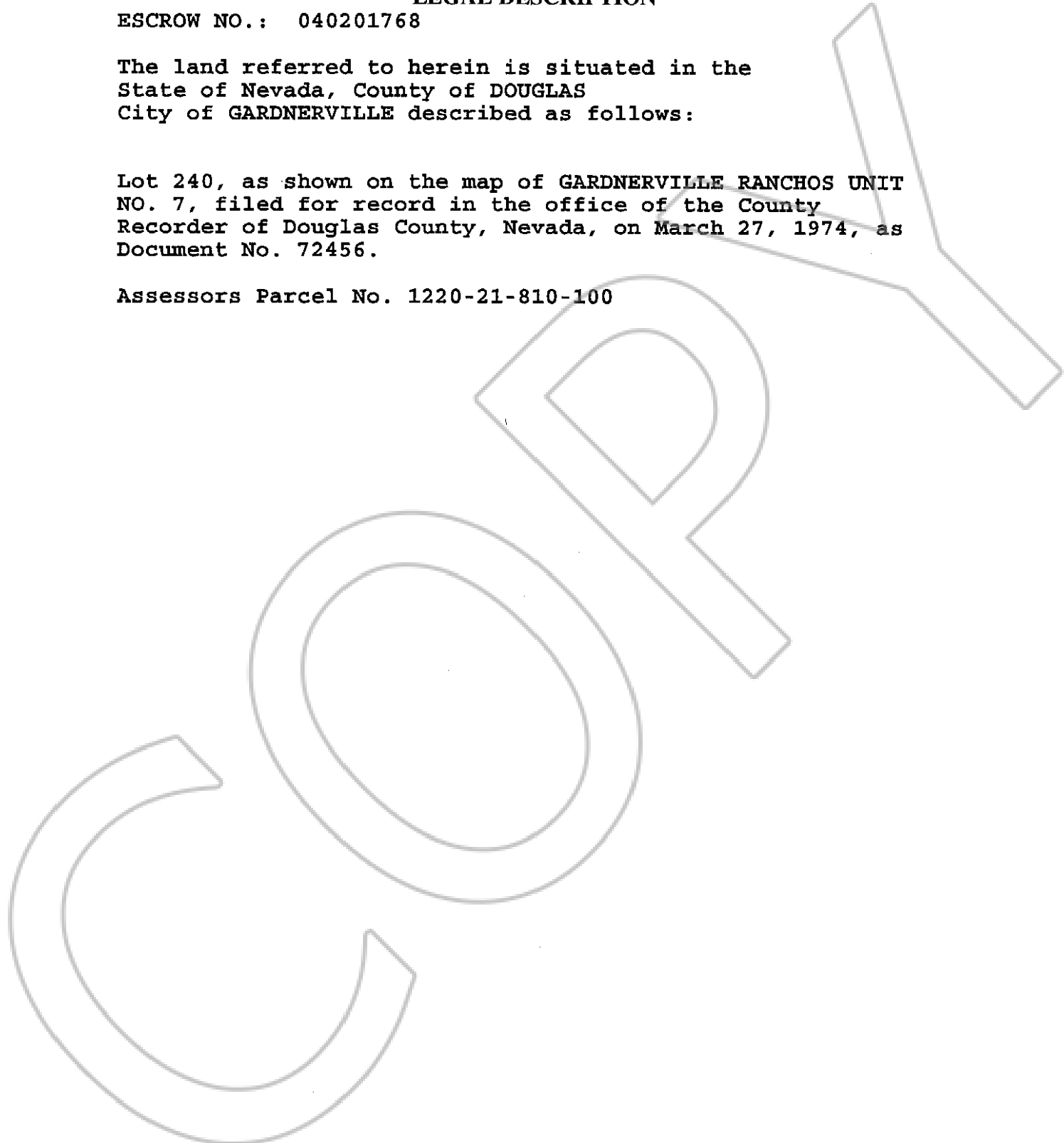

0628326

BK1104PG01682