

A.P.N. # 1320-33-817-042
 R.P.T.T. \$ 0.00 # 6
 ESCROW NO. _____
 RECORDING REQUESTED BY: _____

MAIL TAX STATEMENTS TO:
SAME AS BELOW

WHEN RECORDED MAIL TO:
 ✓ GRANTEE MARGARET C. DRAKE
1380 BROOKE WAY
GARDNERVILLE, NV 89410

REQUESTED BY
Mary January
 IN OFFICIAL RECORDS OF
 DOUGLAS CO., NEVADA
 2004 NOV -3 AM 10:34
 WERNER CHRISTEN
 RECORDER
 \$ 15.00 PAID AS DEPUTY

(Space Above for Recorder's Use Only)

GRANT, BARGAIN, SALE DEED

THIS INDENTURE WITNESSETH: That **MARGARET C. DRAKE, AN UNMARRIED WOMAN**

in consideration of \$10.00, the receipt of which is hereby acknowledged, does hereby Grant, Bargain Sell and Convey to **MARGARET C. DRAKE, CO-TRUSTEE AND MARY L. JANUARY, CO-TRUSTEE OF THE DRAKE FAMILY TRUST DATED MAY 25, 2000**

and to the heirs and assigns of such Grantee forever, all that real property situated in the **unincorporated area** County of **DOUGLAS** State of Nevada, bounded and described as:
SEE EXHIBIT "A" ATTACHED HERETO AND MADE A PART HEREOF

Together with all and singular the tenements, hereditaments and appurtenances thereunto belonging or in anywise appertaining, and any reversions, remainders, rents, issues or profits thereof.

DATE: **November 02, 2004**

Margaret C. Drake
 MARGARET C. DRAKE

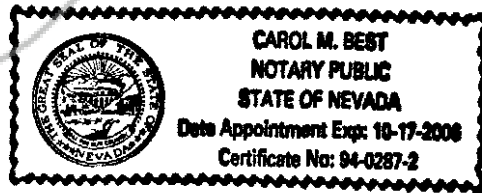

STATE OF NEVADA }
 } ss.
 COUNTY OF WASHOE }

This instrument was acknowledged before me on November 2, 2004
 by MARGARET C. DRAKE

Signature Carol M. Best
 Notary Public (One inch margin on all sides of document for Recorder's Use Only)

0628381
 BK 1104 PG 01846

EXHIBIT "A"

LEGAL DESCRIPTION

The land referred to herein is situated in the State of Nevada, County of DOUGLAS described as follows:

Lot 42, in Block E, as set forth on FINAL SUBDIVISION MAP No. 1006-12 for CHICHESTER ESTATES, PHASE 12, filed in the office of the County Recorder of Douglas County, Nevada and recorded January 8, 2004 in Book 0104, Page 2012, as Document No. 601490.

Assessors Parcel Nos: 1320-33-817-042

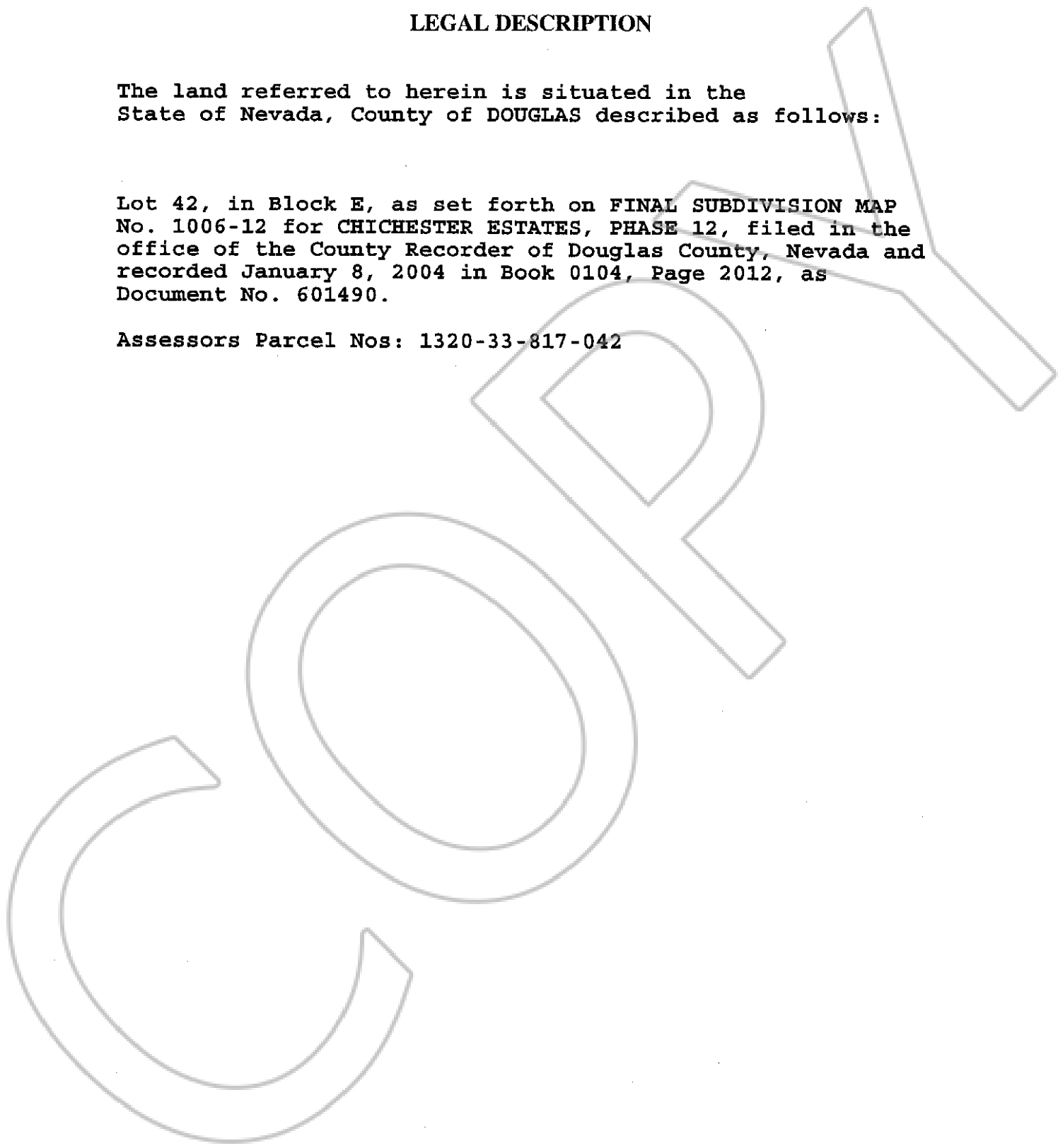

0628381

BK1104PG01847