

151

A.P.N. 1220-24-401-008  
Escrow No. 247211  
R.P.T.T. Sexempt #3

When recorded Mail To:  
(Tax Statement Same)

Shawn W. Goodner  
631 Clydesdale Court  
Gardnerville, NV 89410

REQUESTED BY  
Katherine Pacheco  
IN OFFICIAL RECORDS OF  
DOUGLAS CO., NEVADA

2004 NOV -9 PM 12:09

WERNER CHRISTEN  
RECORDER

\$ 15.00 PAID KJ DEPUTY

**GRANT, BARGAIN AND SALE DEED**

**THIS INDENTURE WITNESSETH:** That for a valuable consideration, receipt of which is hereby acknowledged,  
SHAWN W. GOODNER , an unmarried man, and KATHERINE PACHECO, a single woman  
do(es) hereby **GRANT, BARGAIN, SELL and CONVEY** to  
SHAWN W. GOODNER , an unmarried man, and KATHERINE<sup>m</sup> PACHECO, a single woman, as joint tenants  
all that real property situated in the County of Douglas, State of Nevada, being Assessor's Parcel Number **1220-24-401-008**, specifically described as follows:

See "EXHIBIT A" attached hereto and made a part of.

TOGETHER with all and singular the tenements, hereditaments and appurtenances, including easements and water rights, if any, thereto belonging or in anywise appertaining, and any reversions, remainders, rents, issues of profits thereof.

WITNESS my hand this 15th day of October, 2004

  
\_\_\_\_\_  
Shawn W. Goodner

  
\_\_\_\_\_  
KATHERINE<sup>m</sup> PACHECO

STATE OF NEVADA  
COUNTY OF Douglas

On 10-15, 2004, SHAWN W. GOODNER and KATHERINE PACHECO personally appeared before me, a Notary Public, who acknowledged that he/ executed the above instrument.

  
\_\_\_\_\_  
Notary Public

 SUSAN LAPIN  
Notary Public - State of Nevada  
Appointment Recorded in Douglas County  
No: 02-74883-6 - Expires March 21, 2006

0628874

BK 1104 PG 04458

**EXHIBIT "A"**

A Parcel of land located with in a portion of the Southwest  $\frac{1}{4}$  of Section 24, Township 12 North, Range 20 East, M.D.B. & M., Douglas County, Nevada, being more particularly described as follows:

Parcel C-2, as shown Parcel Map No. 3 for Don and Francie Lockman, Recorded May 23, 1990, in Book 590, Page 3603, as document No. 226670 of Official Records Douglas County, Nevada, being a re-subdivision of Parcel D as shown on the parcel map for Don and Francie Lockman, Recorded December 14, 1989 in Book 1289, Page 1422, as Document 216450 of Official Records Douglas County, Nevada.

Assessor's Parcel No. 1220-24-401-008

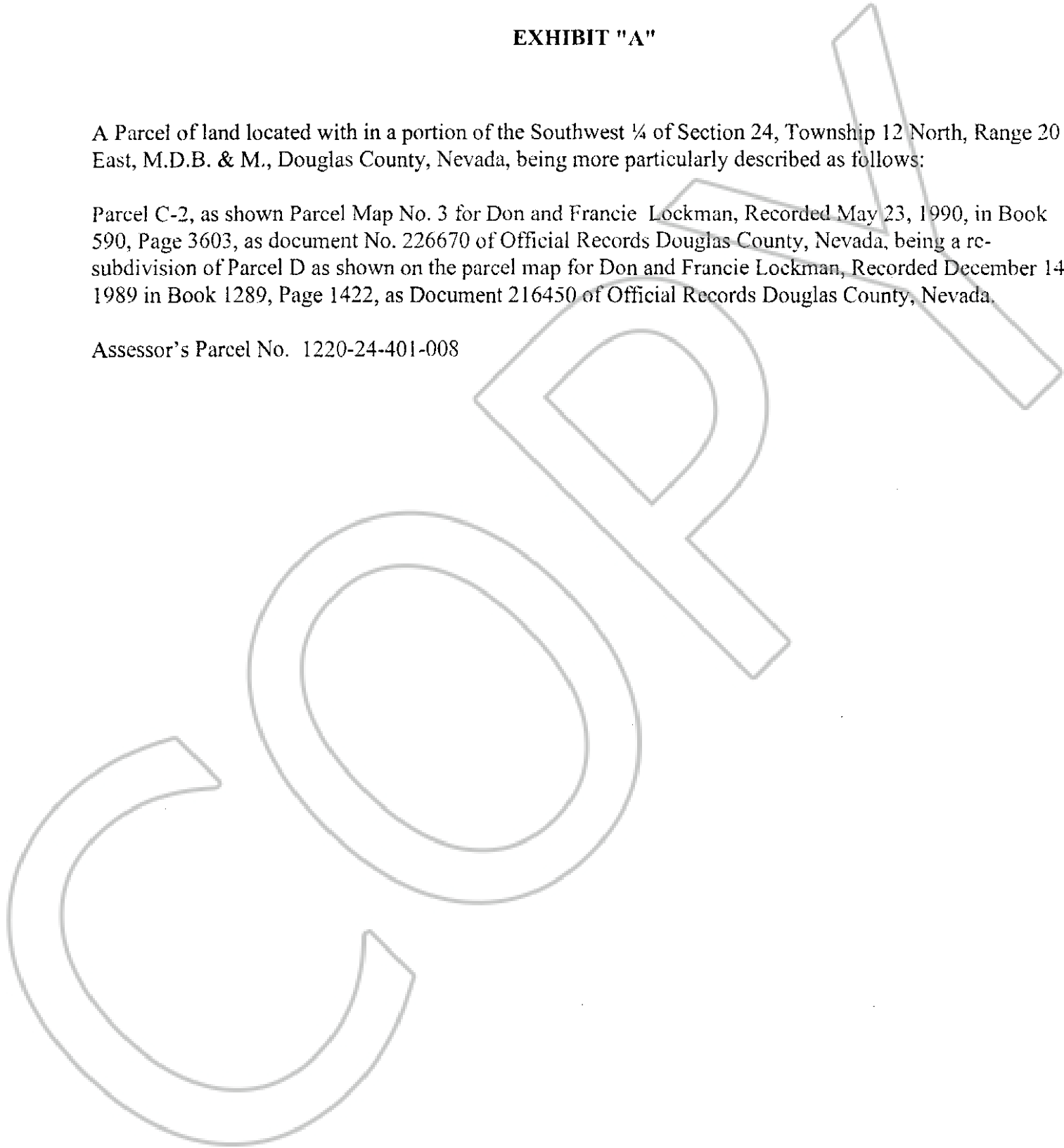

0628874

BK 1104 PG 04459