

A.P.N. # 1420-07-310-006

R.P.T.T. \$ 351.00

ESCROW NO. 40802372

RECORDING REQUESTED BY:
STEWART TITLE COMPANY

MAIL TAX STATEMENTS TO:
SAME AS BELOW

WHEN RECORDED MAIL TO:
GRANTEE
470 BERKSHIRE
CRYSTAL LAKE, IL 60014
EXECUTRIX

REQUESTED BY
Stewart Title of Douglas County
IN OFFICIAL RECORDS OF
DOUGLAS CO., NEVADA

2004 NOV 10 AM 10:17

WERNER CHRISTEN
RECORDER

\$15⁰⁰ PAID KJ DEPUTY

(Space Above for Recorder's Use Only)

GRANT, BARGAIN, SALE DEED

THIS INDENTURE WITNESSETH: That **BONNEY SPRAFKA, EXECUTRIX OF THE ESTATE OF MARTHA G. MARTIN, DECEASED, PURSUANT TO COURT ORDER APPROVING SALE**

in consideration of \$10.00, the receipt of which is hereby acknowledged, does hereby Grant, Bargain Sell and Convey to **RODERICK DUNN AN UNMARRIED MAN**

and to the heirs and assigns of such Grantee forever, all that real property situated in the County of **Douglas** State of Nevada, bounded and described as:

SEE EXHIBIT "A" ATTACHED HERETO AND MADE A PART HEREOF

Together with all and singular the tenements, hereditaments and appurtenances thereunto belonging or in anywise appertaining, and any reversions, remainders, rents, issues or profits thereof.

DATE: **October 20, 2004** **ESTATE OF MARTHA G. MARTIN, DECEASED**

BY: Bonney Sprafka, Executrix
BONNEY SPRAFKA
EXECUTRIX

BY: _____

STATE OF Ohio }
COUNTY OF Madison } ss.

This instrument was acknowledged before me on October 25 2004
by, **BONNEY SPRAFKA**

Signature Rebecca J. McCoy

Notary Public (One Inch Margin on all sides of Document for Recorders Use Only)



REBECCA J. MCCOY
NOTARY PUBLIC, STATE OF OHIO
MY COMMISSION EXPIRES APRIL 1, 2006

0628931

BK1104PG04878

SEAL

EXHIBIT "A"

LEGAL DESCRIPTION

ESCROW NO.: 40802372

The land referred to herein is situated in the State of Nevada, County of Douglas described as follows:

Lot 2, in Block J, as shown on the map of VISTA GRANDE SUBDIVISION UNIT NO. 1, filed for record in the office of the County Recorder of Douglas County, Nevada, on November 9, 1964, as Document No. 26518.

Assessors Parcel No. 1420-07-310-006

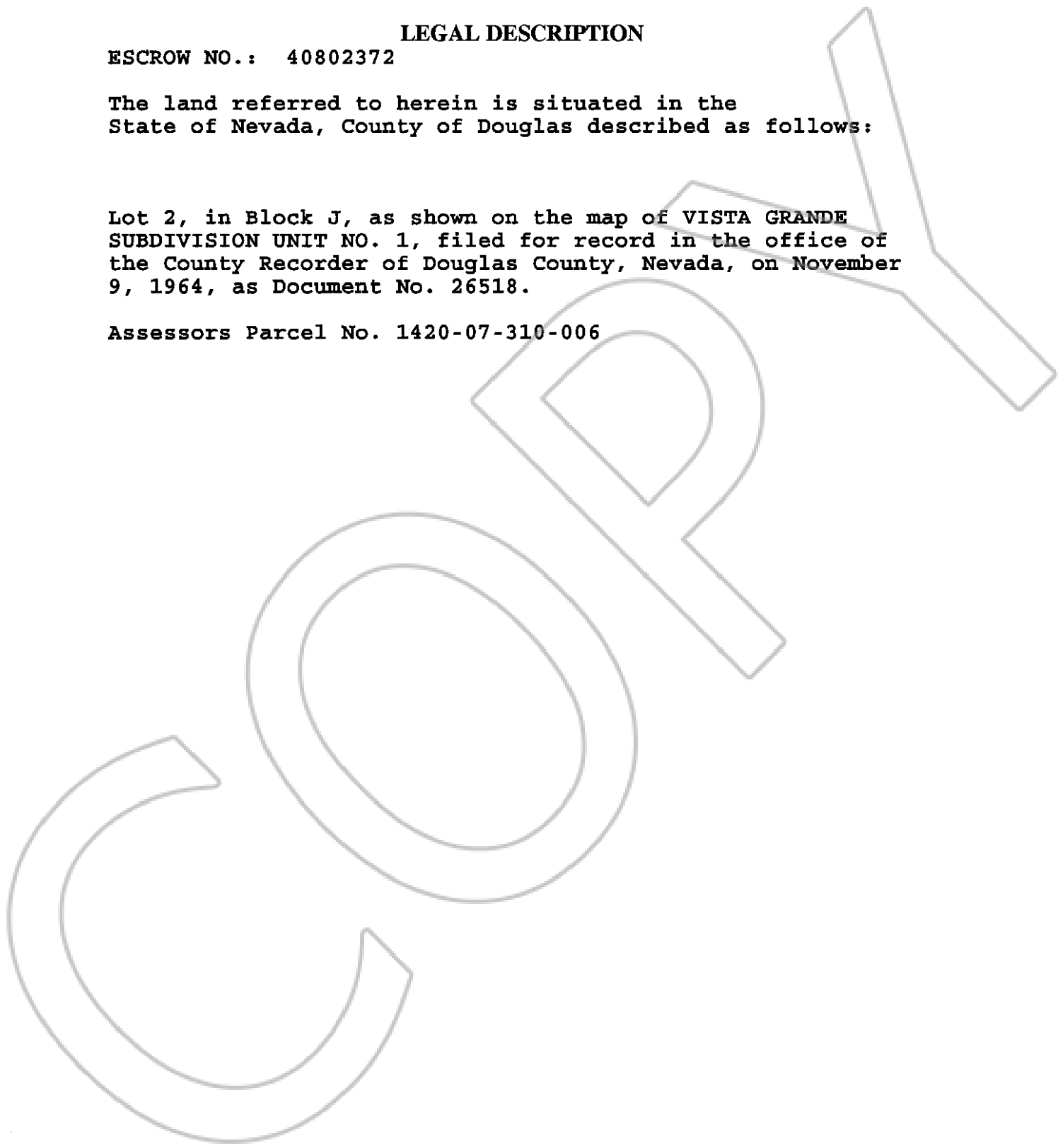

0628931

BK1104PG04879