

A.P.N. # 1420-34-710-009

R.P.T.T. \$ 2 5  
ESCROW NO. 04042814

RECORDING REQUESTED BY:  
**STEWART TITLE COMPANY**  
MAIL TAX STATEMENTS TO:  
**SAME AS BELOW**

WHEN RECORDED MAIL TO:  
**GRANTEE**  
946 Harst  
SLT CA 96150

REQUESTED BY  
**Stewart Title of Douglas County**

IN OFFICIAL RECORDS OF  
DOUGLAS CO., NEVADA

2004 NOV 15 AM 10:17

WERNER CHRISTEN  
RECORDER

\$15<sup>00</sup> PAID KJ DEPUTY

(Space Above for Recorder's Use Only)

### GRANT, BARGAIN, SALE DEED

THIS INDENTURE WITNESSETH: That **SANDRA J. HUGHES\*** \*A Married woman

in consideration of \$10.00, the receipt of which is hereby acknowledged, does hereby Grant, Bargain Sell and Convey to **GREGORY T. HUGHES\* AND SANDRA J. HUGHES\***  
Husband & wife as joint tenants

and to the heirs and assigns of such Grantee forever, all that real property situated in the County of **Douglas** State of Nevada, bounded and described as :

**SEE EXHIBIT "A" ATTACHED HERETO AND MADE A PART HEREOF**

IT IS THE EXPRESS INTENT OF THE GRANTOR, BEING THE SPOUSE OF THE GRANTEE, TO CONVEY ALL RIGHT, TITLE AND INTEREST OF THE GRANTOR, COMMUNITY OR OTHERWISE, IN AND TO THE HEREIN DESCRIBED PROPERTY TO THE GRANTEE AS GRANTEE'S SOLE AND SEPARATE PROPERTY.

Together with all and singular the tenements, hereditaments and appurtenances thereunto belonging or in anywise appertaining, and any reversions, remainders, rents, issues or profits thereof.

DATE: **October 26, 2004**

SANDRA J. HUGHES

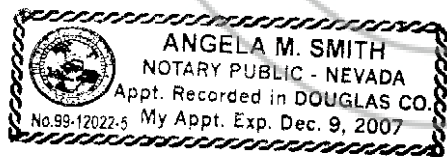

STATE OF N }  
COUNTY OF Douglas } ss.

This instrument was acknowledged before me on 11-2-04  
by, **SANDRA J. HUGHES**

Signature Angela M. Smith

Notary Public (One Inch Margin on all sides of Document for Recorder's Use Only)

0629202  
BK 1104 PG 06480

**LEGAL DESCRIPTION**

The land referred to herein is situated in the State of Nevada,  
County of DOUGLAS, described as follows:

Lot 9, as shown on the map of SIERRA VIEW SUBDIVISION,  
filed in the office of the Douglas County Recorder, State  
of Nevada on April 18, 1960, under File No. 15897.

Assessors Parcel No. 1420-34-710-009

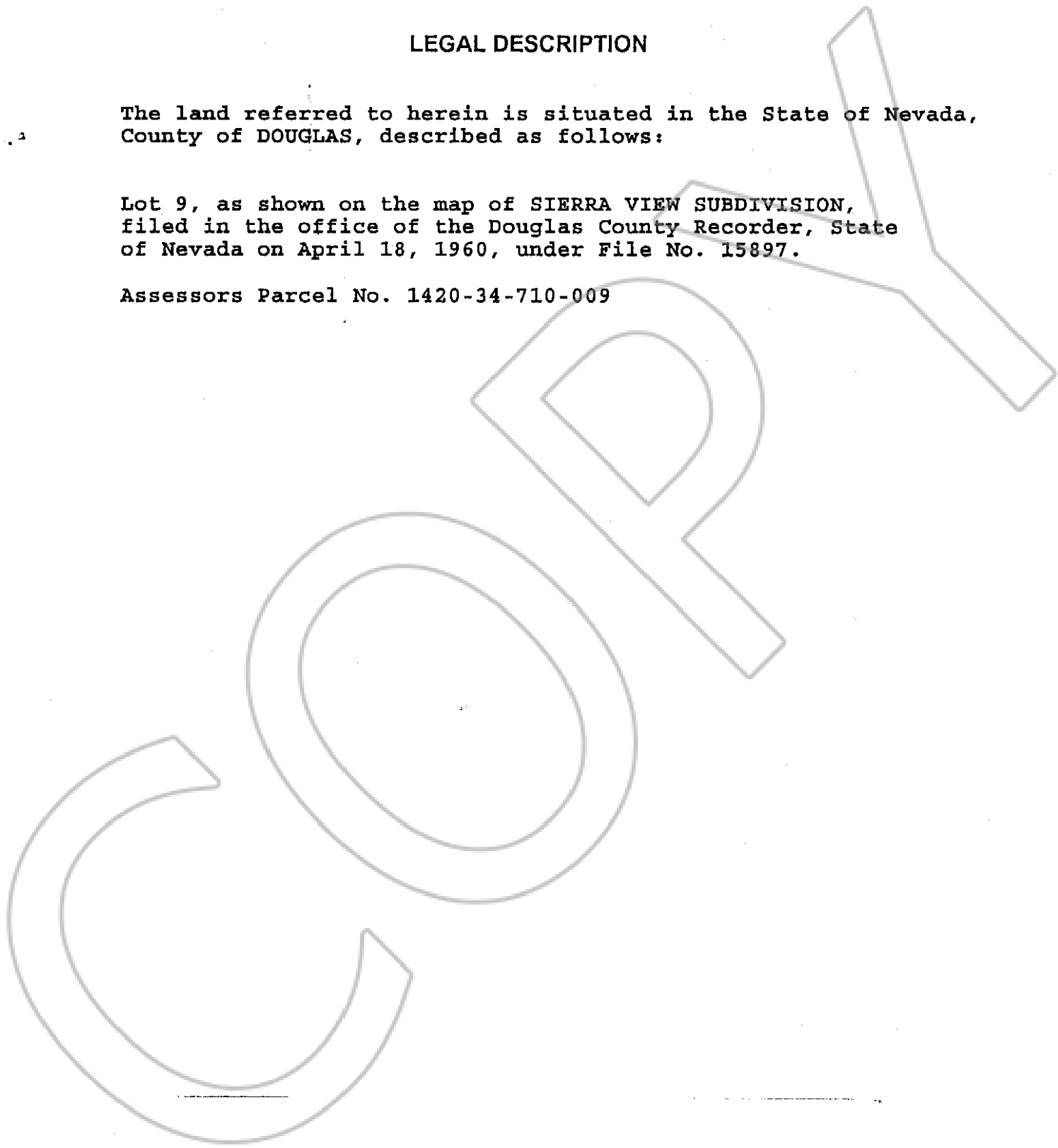

0629202

BK1104PG06481