

APN # 1418-34-211-035

Recording Requested by:

Name TSI TITLE & ESCROW INC.

Address BOX 7197

City/State/Zip STATELINE, NEVADA 89449

R.P.T.T. \$ \$6

GRANT DEED

(Title of Document)

REQUESTED BY
TSI TITLE & ESCROW

IN OFFICIAL RECORDS OF
DOUGLAS CO., NEVADA

2004 NOV 16 AM 9:33

WERNER CHRISTEN
RECORDER

\$16⁰⁰ PAID KJ DEPUTY

(for Recorder's use only)

This page added to provide additional information required by NRS 111.312 Sections 1-2.
(Additional recording fee applies)

This cover page must be typed or printed.

0629359

BK 1104 PG 07392

APN 1418-34-211-035

RECORDING REQUESTED BY:

Fidelity National Title Company
Escrow No.: 04-811072-DB
Locate No.: CAFNT0921-0921-0005-0000811072
Title No.: 04-50144 70

**When Recorded Mail Document
and Tax Statement To:**

Jeffrey G. Kaiser
2684 Maplewood Lane
Santa Clara, CA 95051

APN: 1418-34-211-035

SPACE ABOVE THIS LINE FOR RECORDER'S USE

GRANT DEED

The undersigned grantor(s) declare(s)

Documentary transfer tax is \$ 0 ~~6~~ City Transfer Tax is \$

- computed on full value of property conveyed, or
- computed on full value less value of liens or encumbrances remaining at time of sale,
- Unincorporated Area City of Zephyr Cove,

"The grantors and the grantees in this conveyance are comprised of the same parties who continue to hold the same proportionate interest in the property, R & T 11923(d)."

FOR A VALUABLE CONSIDERATION, receipt of which is hereby acknowledged, Jeffrey G. Kaiser in Trust, as Trustee of the Jeffrey G. Kaiser 1999 Trust, dated May 5, 1999

hereby GRANT(S) to Jeffrey G. Kaiser, an unmarried man

the following described real property in the City of Zephyr Cove, County of Douglas, State of Nevada:

THIS INSTRUMENT IS BEING RECORDED AS AN ACCOMMODATION ONLY. NO LIABILITY, EXPRESS, OR IMPLIED, IS ASSUMED AS TO ITS REGULARITY OR SUFFICIENCY NOR AS TO ITS AFFECT, IF ANY, UPON TITLE TO ANY REAL PROPERTY DESCRIBED THEREIN.

DATED: November 1, 2004

STATE OF CALIFORNIA
COUNTY OF Santa Clara
ON November 8, 2004 before me,
the undersigned Notary Public personally appeared
Jeffrey G. Kaiser

Jeffrey G. Kaiser
Jeffrey G. Kaiser

personally known to me (or proved to me on the basis of satisfactory evidence) to be the person(s) whose name(s) ~~is/are~~ subscribed to the within instrument and acknowledged to me that ~~he/she/they~~ executed the same in ~~his/her/their~~ authorized capacity(ies), and that by ~~his/her/their~~ signature(s) on the instrument the person(s), or the entity upon behalf of which the person(s) acted, executed the instrument.

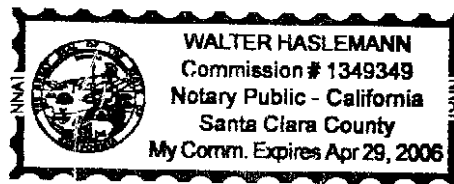

Witness my hand and official seal.

Signature Walter Haslemann

SEAL

MAIL TAX STATEMENTS AS DIRECTED ABOVE

EXHIBIT A

and is described as follows:

Lot 28 as shown on the **MAP OF LAKERIDGE ESTATES NO. 2**, filed in the Office of the County Recorder of Douglas County, Nevada on June 13, 1957

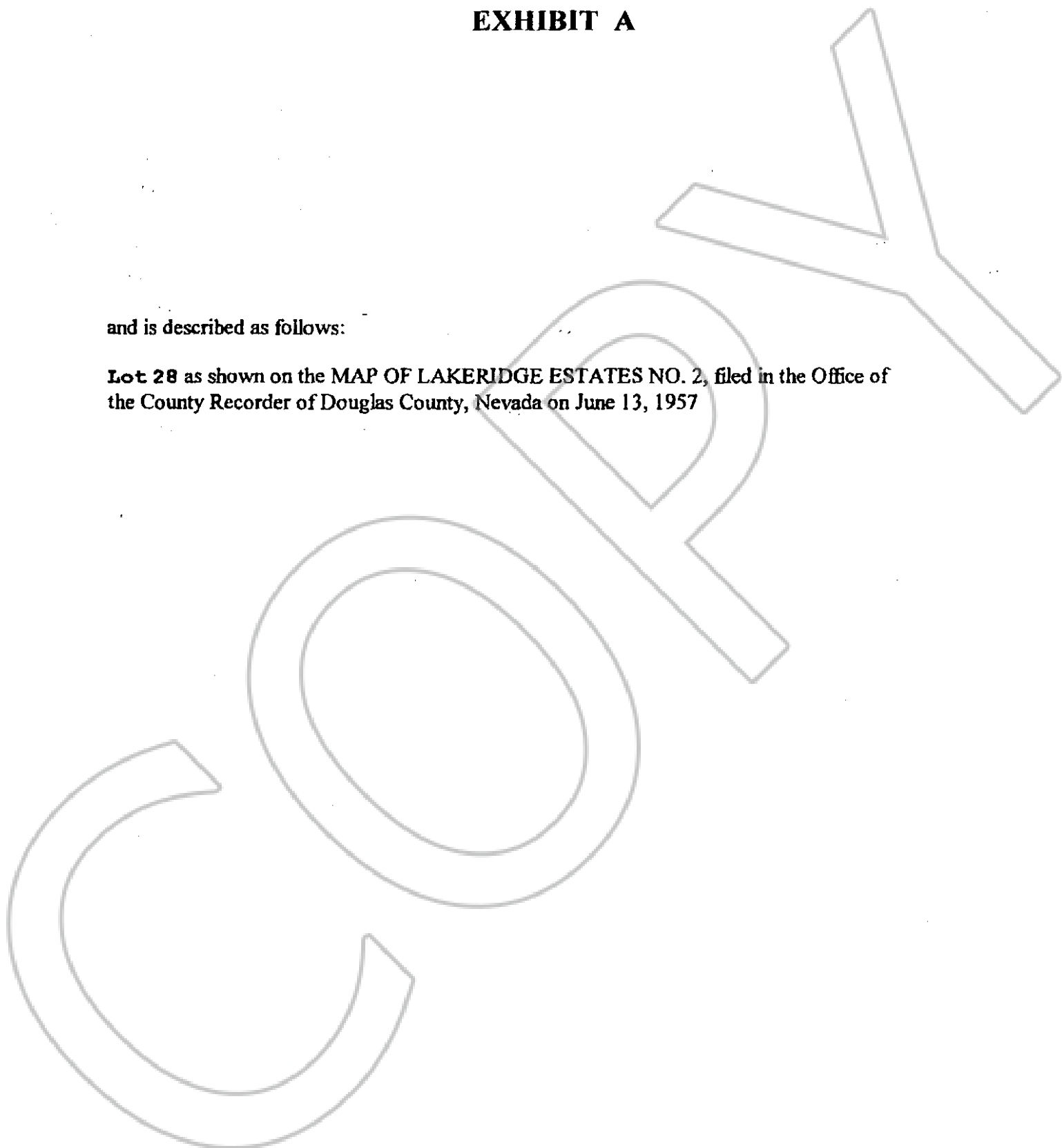

0629359
BK1104PG07394