

A.P.N. # 1022-10-002-064

R.P.T.T. \$ 0 #6
ESCROW NO. 04052897

RECORDING REQUESTED BY:
STEWART TITLE COMPANY
MAIL TAX STATEMENTS TO:
SAME AS BELOW

WHEN RECORDED MAIL TO:
ANGELO R. NIEVE, TRUSTEE
1320 LIMESTONE ROAD
WELLINGTON, NV 89444

REQUESTED BY
Stewart Title of Douglas County
IN OFFICIAL RECORDS OF
DOUGLAS CO., NEVADA

2004 NOV 16 AM 10:27

WERNER CHRISTEN
RECORDER

\$15⁰⁰ PAID KJ DEPUTY

(Space Above for Recorder's Use Only)

GRANT, BARGAIN, SALE DEED

THIS INDENTURE WITNESSETH: That **ANGELO R. NIEVE, AN UNMARRIED MAN**

in consideration of \$10.00, the receipt of which is hereby acknowledged, does hereby Grant, Bargain Sell and Convey to **ANGELO RICHARD NIEVE, SUCCESSOR TRUSTEE OF THE NIEVE FAMILY TRUST DATED FEBRUARY 9, 1988**

and to the heirs and assigns of such Grantee forever, all that real property situated in the County of **DOUGLAS** State of Nevada, bounded and described as:

SEE EXHIBIT "A" ATTACHED HERETO AND MADE A PART HEREOF

Together with all and singular the tenements, hereditaments and appurtenances thereunto belonging or in anywise appertaining, and any reversions, remainders, rents, issues or profits thereof.

DATE: **November 05, 2004**

Angelo R. Nieve
ANGELO R. NIEVE

J. MAYO
NOTARY PUBLIC
STATE OF NEVADA
Appt. Recorded in Carson City
My Appt. Expires March 19, 2008
No: 96-1682-3

STATE OF NEVADA }
 } Douglas } ss.
COUNTY OF CARSON CITY }

This instrument was acknowledged before me on 11/8/04
by **ANGELO R. NIEVE**

Signature *J Mayo*
Notary Public (One inch margin on all sides of document for Recorder's Use Only)

0629405

BK1104PG07580

LEGAL DESCRIPTION

The land referred to herein is situated in the State of Nevada,
County of DOUGLAS, described as follows:

Lot 23, as shown on the map of TOPAZ RANCH ESTATES UNIT NO.
2, filed in the Office of the County Recorder of Douglas
County, Nevada, on February 20, 1967, as Document No. 35464.

Assessor's Parcel No. 1022-10-002-064.

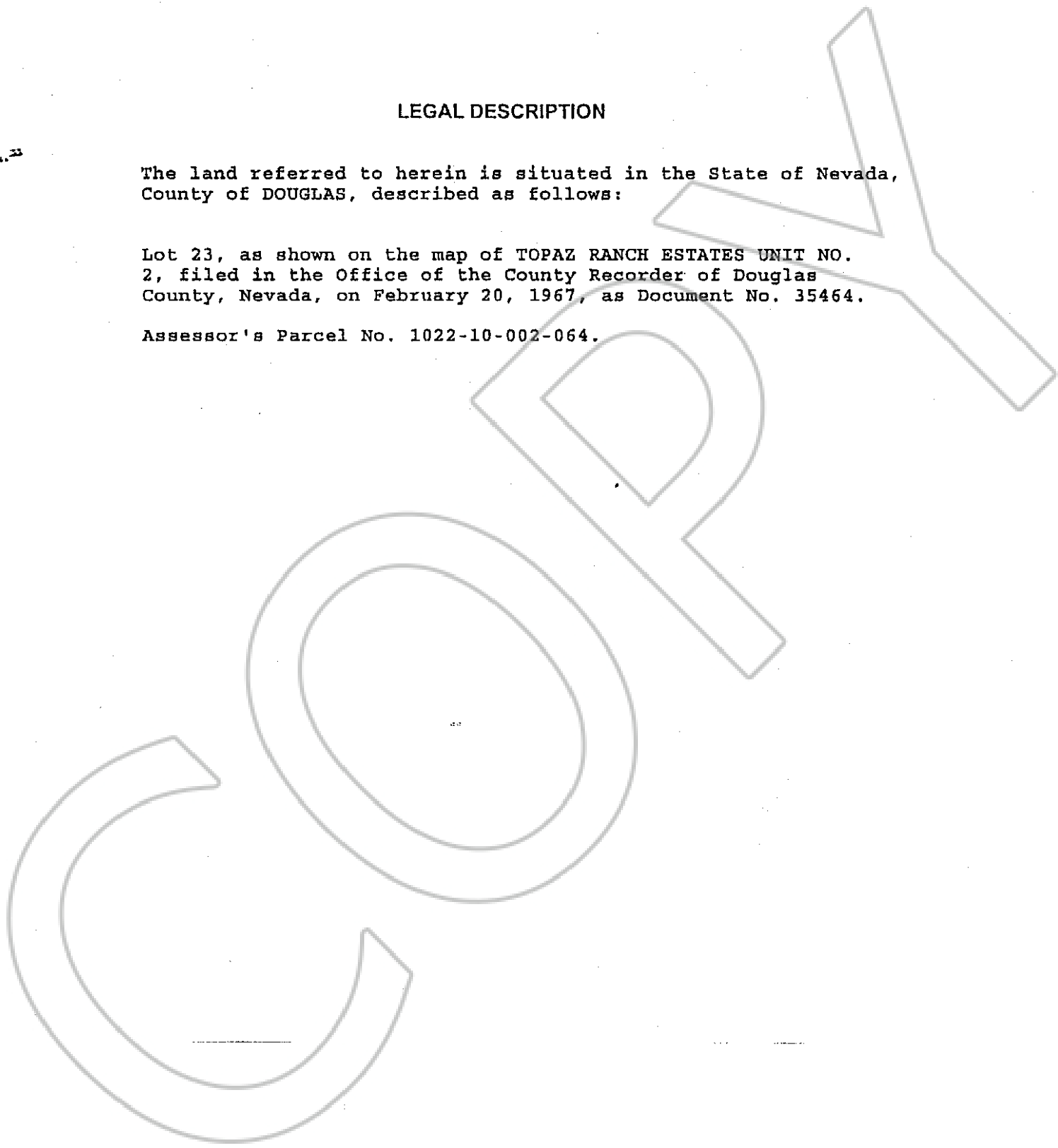

0629405

BK 1104 PG 07581