



**EXHIBIT "A"**

**LEGAL DESCRIPTION**

**ESCROW NO.: 040202535**

**The land referred to herein is situated in the State of Nevada, County of Douglas described as follows:**

**Lot 712, as shown on the map of GARDNERVILLE RANCHOS UNIT NO. 7, filed for record in the office of the County Recorder of Douglas County, Nevada, on March 27, 1974, as Document No. 72456.**

**Assessors Parcel No. 1220-22-310-089**

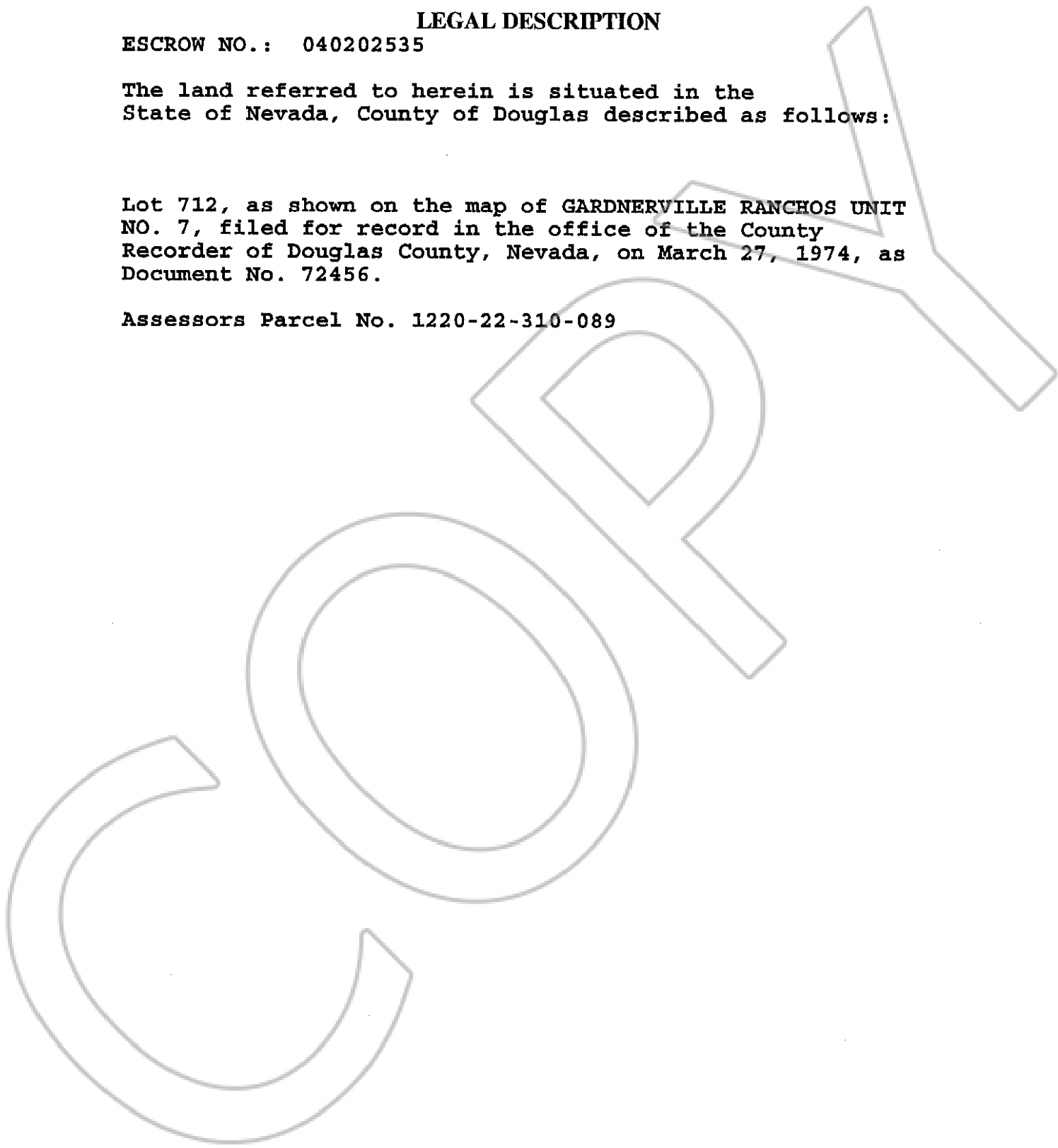

0629467

BK1104PG07898