



**EXHIBIT "A"  
LEGAL DESCRIPTION**

Order No.: 040302902

The land referred to herein is situated in the State of Nevada,  
County of DOUGLAS, described as follows:

Lot 190, Block D, as shown on the Final Map #PD99-02-06 for  
SARATOGA SPRINGS ESTATES UNIT 6, A PLANNED DEVELOPMENT,  
recorded in the Office of the County Recorder of Douglas  
County, Nevada, on June 28, 2002, in Book 0602, at Page  
10142, as Document No. 546028.

ASSESSOR'S PARCEL NUMBER: 1420-28-212-014

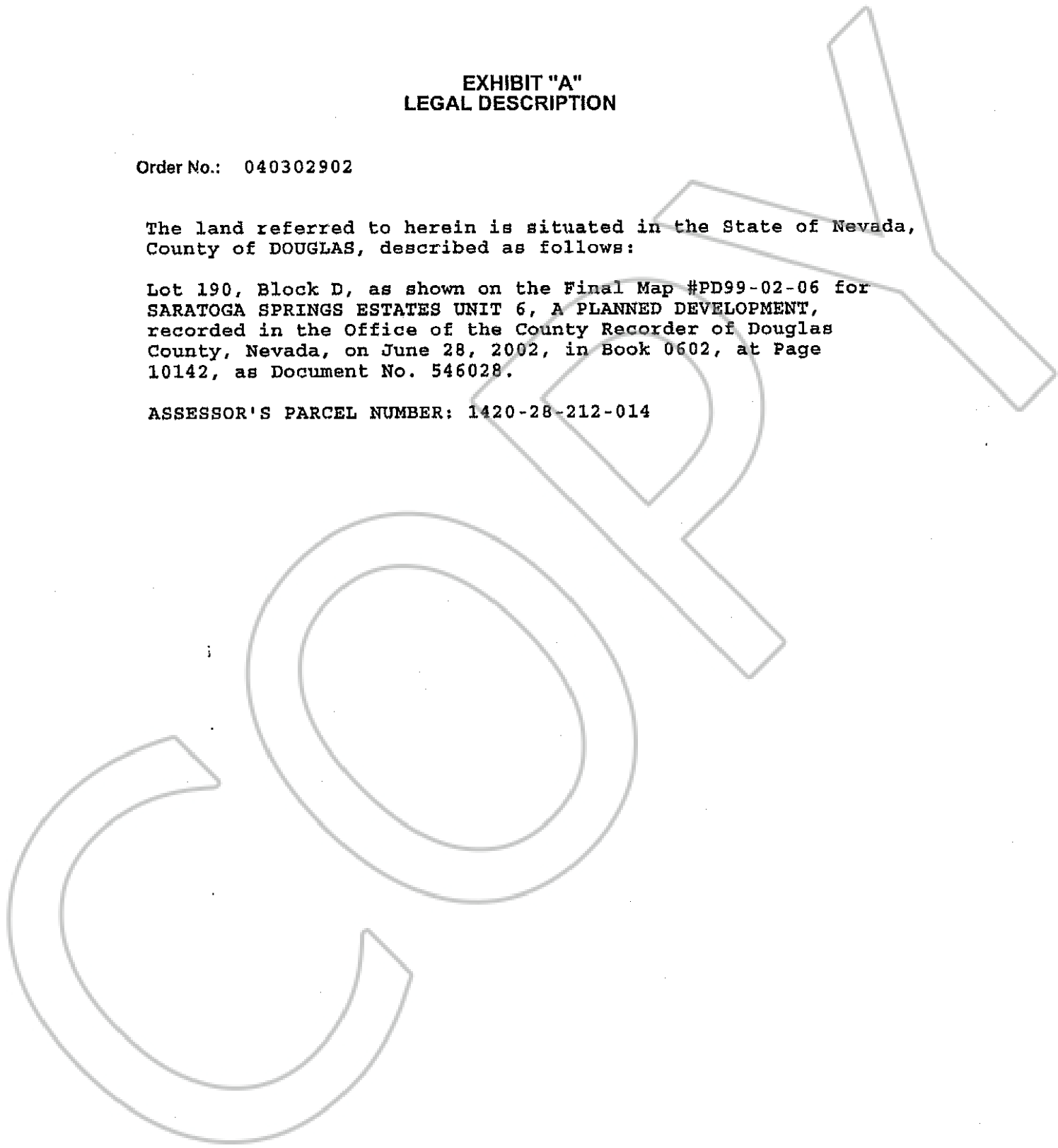

0629470

BK1104PG07922