

A.P.N. # 1220-22-310-089

R.P.T.T. \$ 565.50
ESCROW NO. 040202535

RECORDING REQUESTED BY:
STEWART TITLE COMPANY

MAIL TAX STATEMENTS TO:
MR DAHILI
680 LONG VALLEY ROAD
GARDNERVILLE NV 89460

WHEN RECORDED MAIL TO:
MR DAHILI
680 LONG VALLEY ROAD
GARDNERVILLE NV 89460

REQUESTED BY
Stewart Title of Douglas County

IN OFFICIAL RECORDS OF
DOUGLAS CO., NEVADA

2004 NOV 18 AM 10: 56

WERNER CHRISTEN
RECORDER

\$ 15.00 PAID Be DEPUTY

(Space Above for Recorder's Use Only)

GRANT, BARGAIN, SALE DEED

THIS INDENTURE WITNESSETH: That **JERRY DAHILI, A SINGLE MAN**

in consideration of \$10.00, the receipt of which is hereby acknowledged, does hereby Grant, Bargain Sell and Convey to **JERRY DAHILI, A SINGLE MAN AND CHEYANNE MILES, A SINGLE WOMAN AS JOINT TENANTS**

and to the heirs and assigns of such Grantee forever, all that real property situated in the **unincorporated area** County of **DOUGLAS** State of Nevada, bounded and described as:

SEE EXHIBIT "A" ATTACHED HERETO AND MADE A PART HEREOF

Together with all and singular the tenements, hereditaments and appurtenances thereunto belonging or in anywise appertaining, and any reversions, remainders, rents, issues or profits thereof.

DATE: **November 08, 2004**

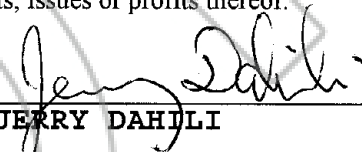

JERRY DAHILI

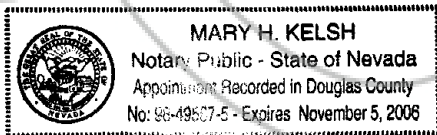

STATE OF Nevada
COUNTY OF Douglas } ss.

THIS DOCUMENT IS RECORDED AS AN ACCOMMODATION ONLY and without liability for the consideration therefor, or as to the validity or sufficiency of said instrument, or for the effect of such recording on the title of the property involved.

This instrument was acknowledged before me on 11-8-04
by **JERRY DAHILI**

Signature Mary H. Kelsh

Notary Public (One inch margin on all sides of document for Recorder's Use Only)

0629729

BK 1104 PG 08931

EXHIBIT "A"

LEGAL DESCRIPTION

ESCROW NO.: 040202535

The land referred to herein is situated in the State of Nevada, County of Douglas described as follows:

Lot 712, as shown on the map of GARDNERVILLE RANCHOS UNIT NO. 7, filed for record in the office of the County Recorder of Douglas County, Nevada, on March 27, 1974, as Document No. 72456.

Assessors Parcel No. 1220-22-310-089

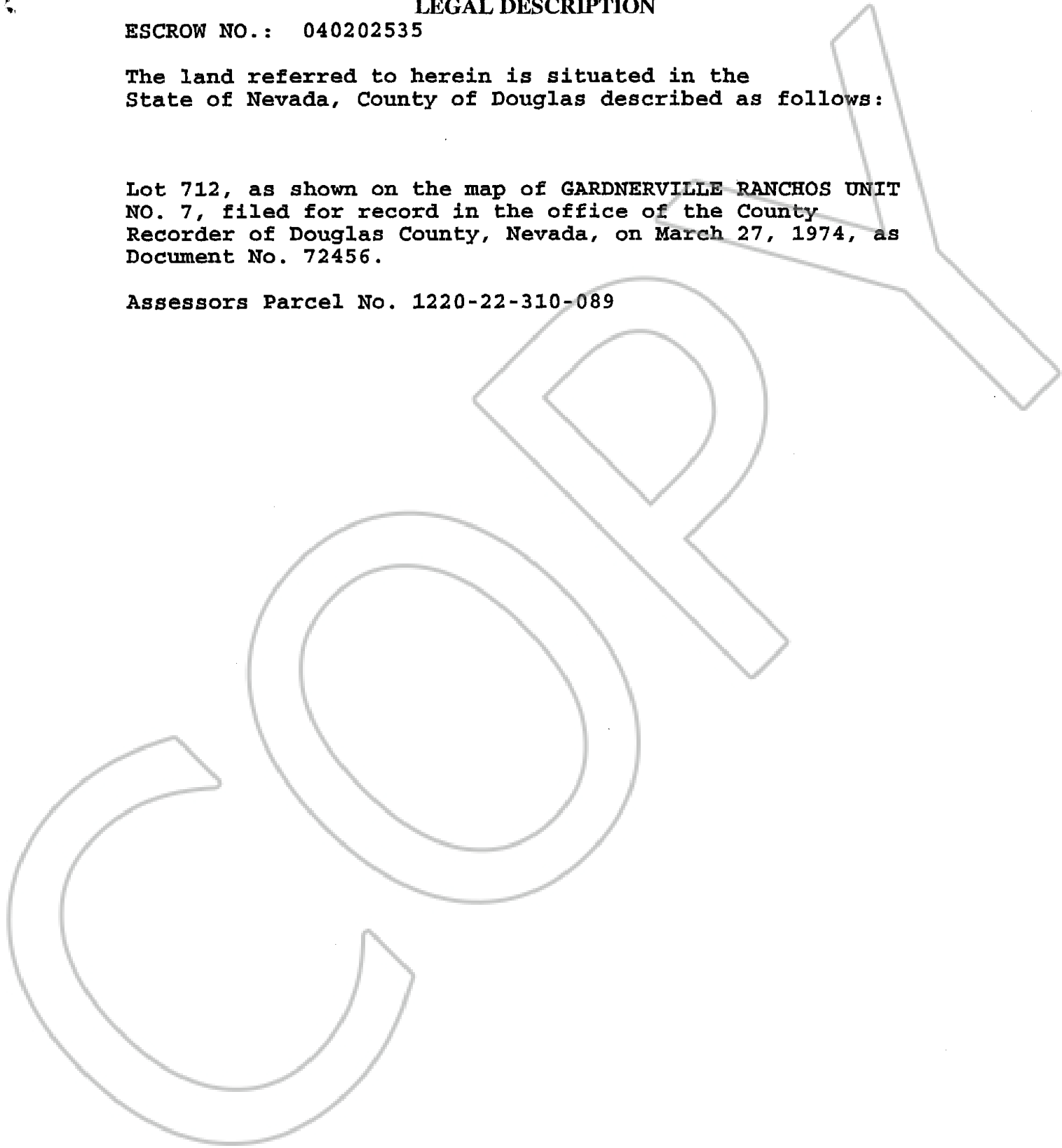

0629729
BK1104PG08932