

A.P.N. # 1022-18-002-039

R.P.T.T. \$ 00.00 #6

ESCROW NO. 040302905

RECORDING REQUESTED BY:
STEWART TITLE COMPANY

MAIL TAX STATEMENTS TO:
SAME AS BELOW

WHEN RECORDED MAIL TO:
CRAIG LODATO
P.O. BOX 619
GENOA, NV 89411

REQUESTED BY
Stewart Title of Douglas County
IN OFFICIAL RECORDS OF
DOUGLAS CO., NEVADA

2004 NOV 19 AM 10:55

WERNER CHRISTEN
RECORDER

\$ 15.50 PAID KY DEPUTY

(Space Above for Recorder's Use Only)

GRANT, BARGAIN, SALE DEED

THIS INDENTURE WITNESSETH: That **CRAIG LODATO, Successor Trustee of the JOSEPH S. LODATO TRUST, dated May 18, 1993**

in consideration of \$10.00, the receipt of which is hereby acknowledged, does hereby Grant, Bargain Sell and Convey to **CRAIG LODATO, Trutee of the C. LODATO TRUST, dated June 21, 2001**

and to the heirs and assigns of such Grantee forever, all that real property situated in the County of **DOUGLAS** State of Nevada, bounded and described as:

SEE EXHIBIT "A" ATTACHED HERETO AND MADE A PART HEREOF

Together with all and singular the tenements, hereditaments and appurtenances thereunto belonging or in anywise appertaining, and any reversions, remainders, rents, issues or profits thereof.

DATE: **November 10, 2004 JOSEPH S. LODATO TRUST**
DATED MAY 18, 1993

BY: Craig Lodato, Successor Trustee
CRAIG LODATO
SUCCESSOR TRUSTEE

 **D. STEPHENS**
NOTARY PUBLIC
STATE OF NEVADA
Appt. Recorded in Douglas County
My Appt. Expires June 6, 2006
No: 02-75828-5

BY: _____

THIS INSTRUMENT IS BEING RECORDED AS AN ACCOMMODATION ONLY. NO LIABILITY, EXPRESS OR IMPLIED, IS ASSUMED AS TO ITS REGULARITY OR SUFFICIENCY NOR AS TO ITS AFFECT, IF ANY, UPON TITLE TO ANY REAL PROPERTY DESCRIBED HEREIN.

STATE OF Nevada
COUNTY OF DOUGLAS } ss.

STFWART TITLE OF DOUGLAS COUNTY

This instrument was acknowledged before me on 11-18-04
by, **CRAIG LODATO**

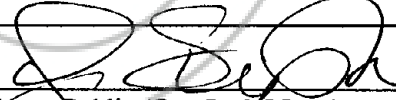
Signature 

Notary Public (One Inch Margin on all sides of Document for Recorders Use Only)

0629872

BK 1104 PG 09507

EXHIBIT "A"
LEGAL DESCRIPTION

Order No.: 040302905

The land referred to herein is situated in the State of Nevada,
County of DOUGLAS, described as follows:

Lot 20, Block B, as shown on the Map of HOLBROOK HIGHLANDS,
filed in the Office of the County Recorder of Douglas
County, Nevada, on March 22, 1978, as Document No. 18825.

Assessors Parcel No. 1022-18-002-039

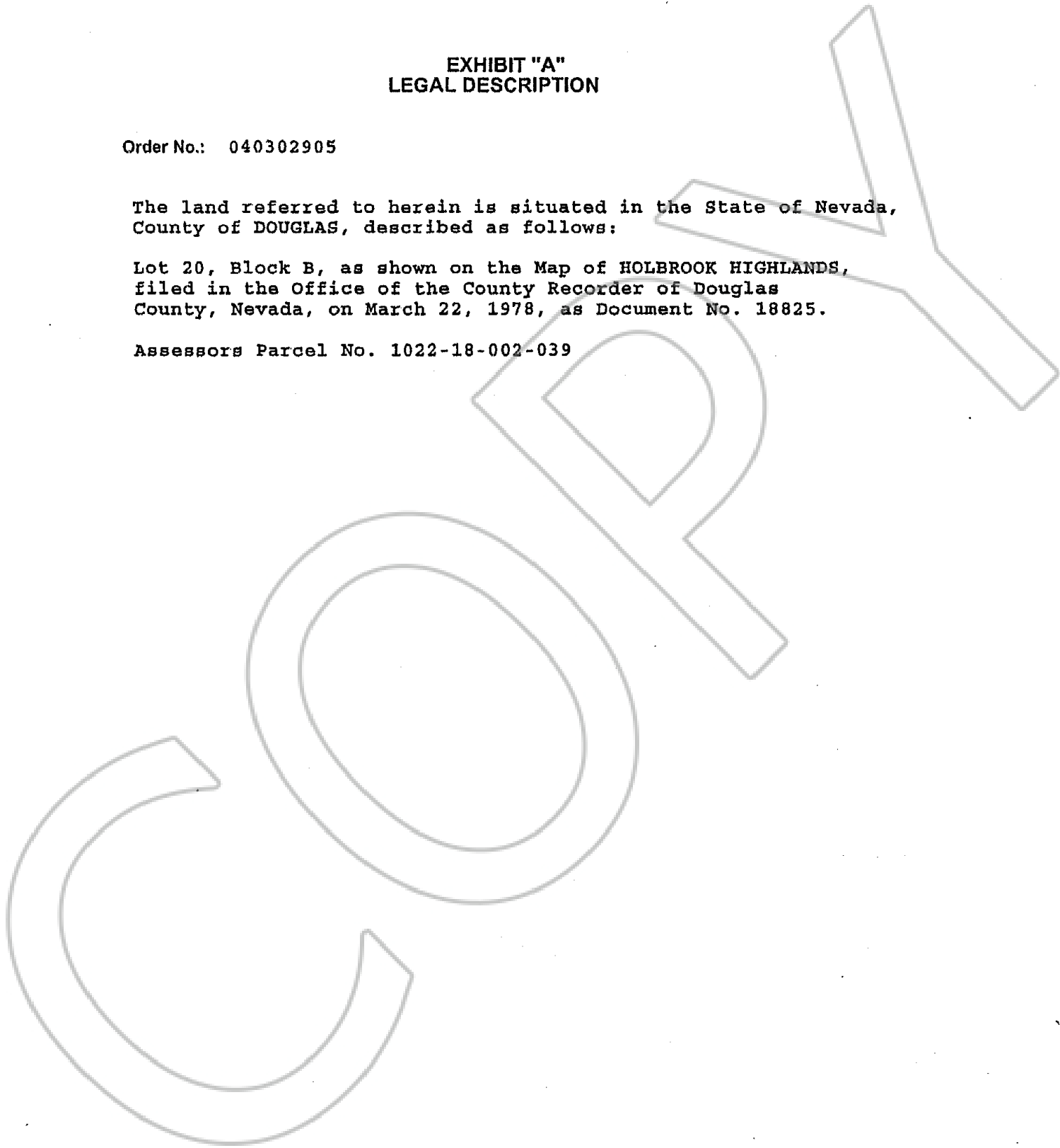

0629872

BK1104PG09508