



EXHIBIT "A"  
LEGAL DESCRIPTION

Order No.: 040302905

The land referred to herein is situated in the State of Nevada,  
County of DOUGLAS, described as follows:

Lot 20, Block B, as shown on the Map of HOLBROOK HIGHLANDS,  
filed in the Office of the County Recorder of Douglas  
County, Nevada, on March 22, 1978, as Document No. 18825.

Assessors Parcel No. 1022-18-002-039

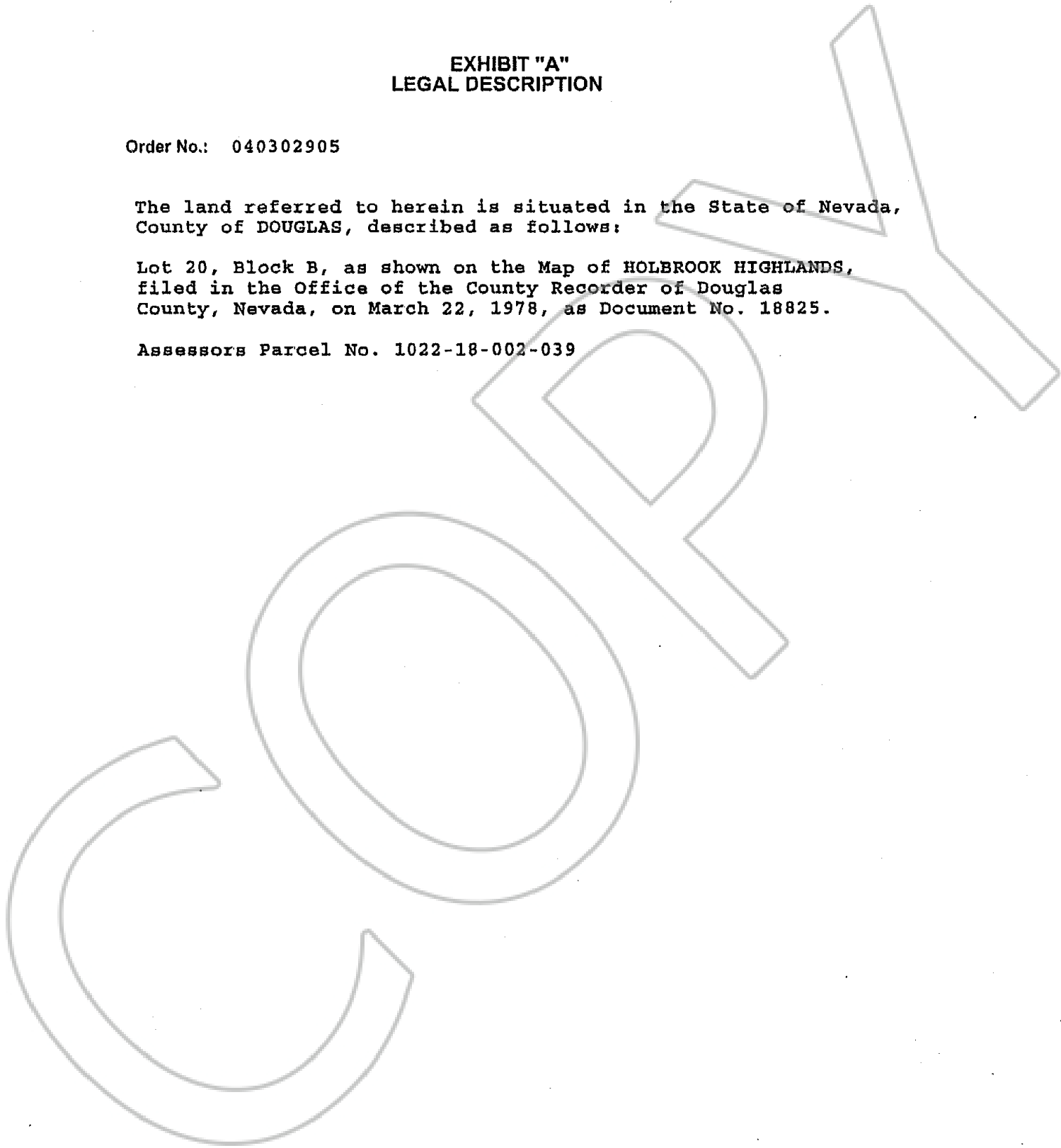

0629873

BK1104PG09510