

A.P.N. # 1220-16-117-006

R.P.T.T. \$ 0.00 # 6

ESCROW NO. 040303063

RECORDING REQUESTED BY:
STEWART TITLE COMPANY
MAIL TAX STATEMENTS TO:
SAME AS BELOW

WHEN RECORDED MAIL TO:
MR. AND MRS. NAFIE
1280 TOPAZ LANE
GARDNERVILLE, NV 89460

REQUESTED BY
Stewart Title of Douglas County
IN OFFICIAL RECORDS OF
DOUGLAS CO., NEVADA

2004 NOV 19 PM 3:31

WERNER CHRISTEN
RECORDER

\$15⁰⁰ PAID KJ DEPUTY

(Space Above for Recorder's Use Only)

GRANT, BARGAIN, SALE DEED

THIS INDENTURE WITNESSETH: That **RODNEY WILLIAM NAFIE AND CHERYL SUE GIEDT-NAFIE, TRUSTEES OF THE RODNEY WILLIAM NAFIE AND CHERYL SUE GIEDT-NAFIE REVOCABLE LIVING TRUST DATED AUGUST 6, 1997**

in consideration of \$10.00, the receipt of which is hereby acknowledged, does hereby Grant, Bargain Sell and Convey to **RODNEY W. NAFIE AND CHERYL S. NAFIE, HUSBAND AND WIFE AS JOINT TENANTS**

and to the heirs and assigns of such Grantee forever, all that real property situated in the County of **DOUGLAS** State of Nevada, bounded and described as:

SEE EXHIBIT "A" ATTACHED HERETO AND MADE A PART HEREOF

Together with all and singular the tenements, hereditaments and appurtenances thereunto belonging or in anywise appertaining, and any reversions, remainders, rents, issues or profits thereof.

DATE: **November 15, 2004**

Rodney W. Nafie - Trustee
RODNEY W. NAFIE, TRUSTEE

Cheryl S. Nafie - Trustee
CHERYL S. NAFIE, TRUSTEE

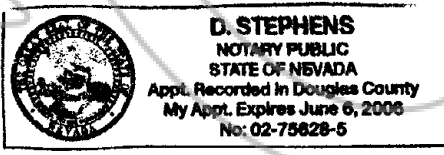

STATE OF NEVADA }
COUNTY OF DOUGLAS } SS.

This instrument was acknowledged before me on Nov 15, 2004,
by RODNEY W. NAFIE, TRUSTEE and CHERYL S. NAFIE, TRUSTEE

Signature *[Signature]*
Notary Public (One inch margin on all sides of document for Recorder's Use Only)

0629933
BK 1104 PG 09793

EXHIBIT "A"

LEGAL DESCRIPTION

ESCROW NO.: 040303063

The land referred to herein is situated in the State of Nevada, County of DOUGLAS described as follows:

Lot 12, in Block A, as shown on the initial final Subdivision Map #1003 for ASHLEY PARK filed for record in the office of the County Recorder of Douglas County, State of Nevada on June 02, 1995 in Book 695 at page 385 as Document No. 363385.

Assessors Parcel No. 1220-16-117-006.

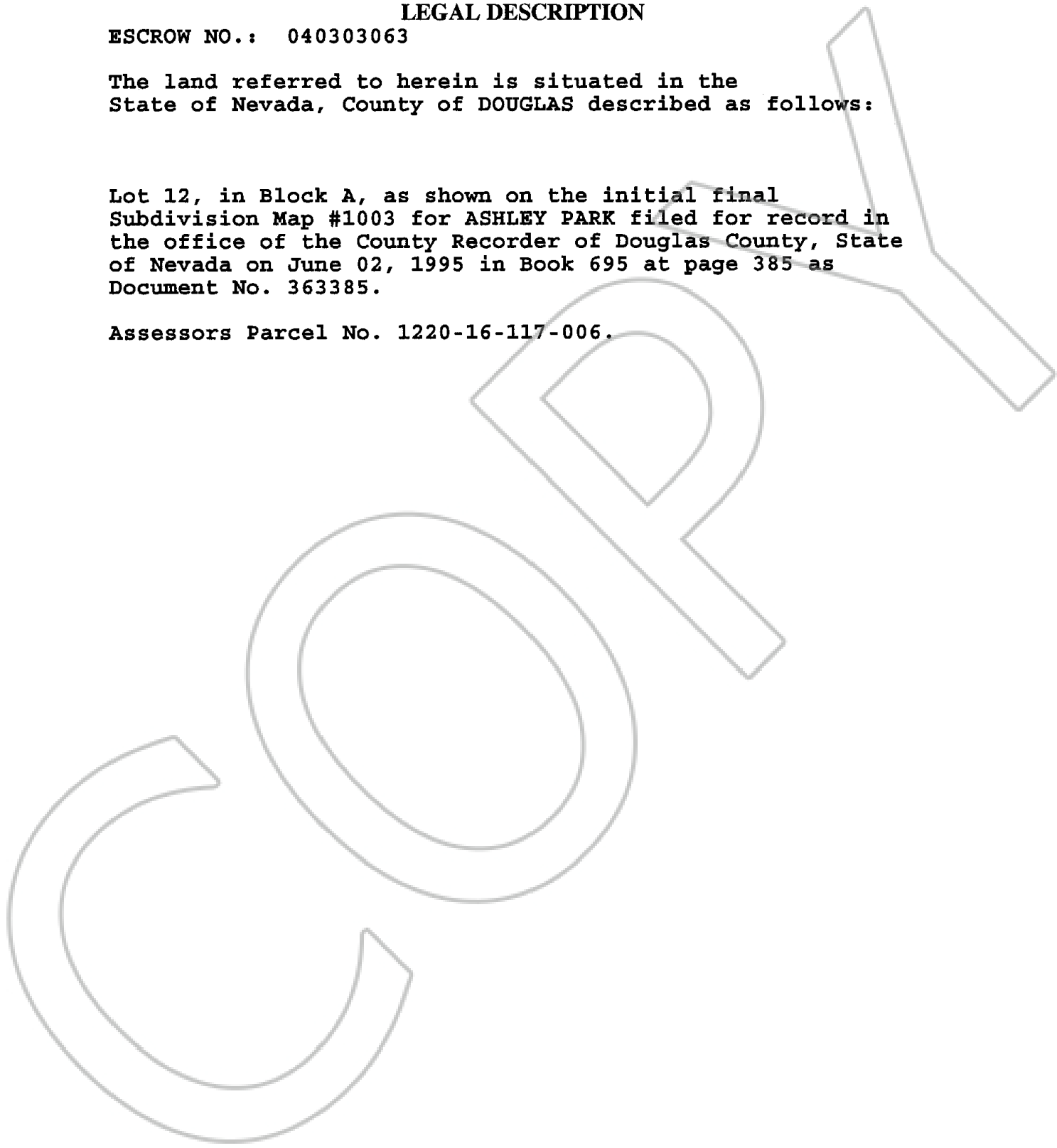

**0629933
BK1104PG09794**