



**EXHIBIT "A"**

**LEGAL DESCRIPTION**

ESCROW NO.: 040202516

The land referred to herein is situated in the State of Nevada, County of DOUGLAS unincorporated area described as follows:

Lot 37, in Block 2, as shown on the Official Map of OLIVER PARK, and filed in the Office of the County Recorder of Douglas County, Nevada, on February 2, 1958, in Book 1 of Maps, as Document No. 14034 Douglas County, Nevada Records.

Assessor's Parcel No. 1318-22-002-082

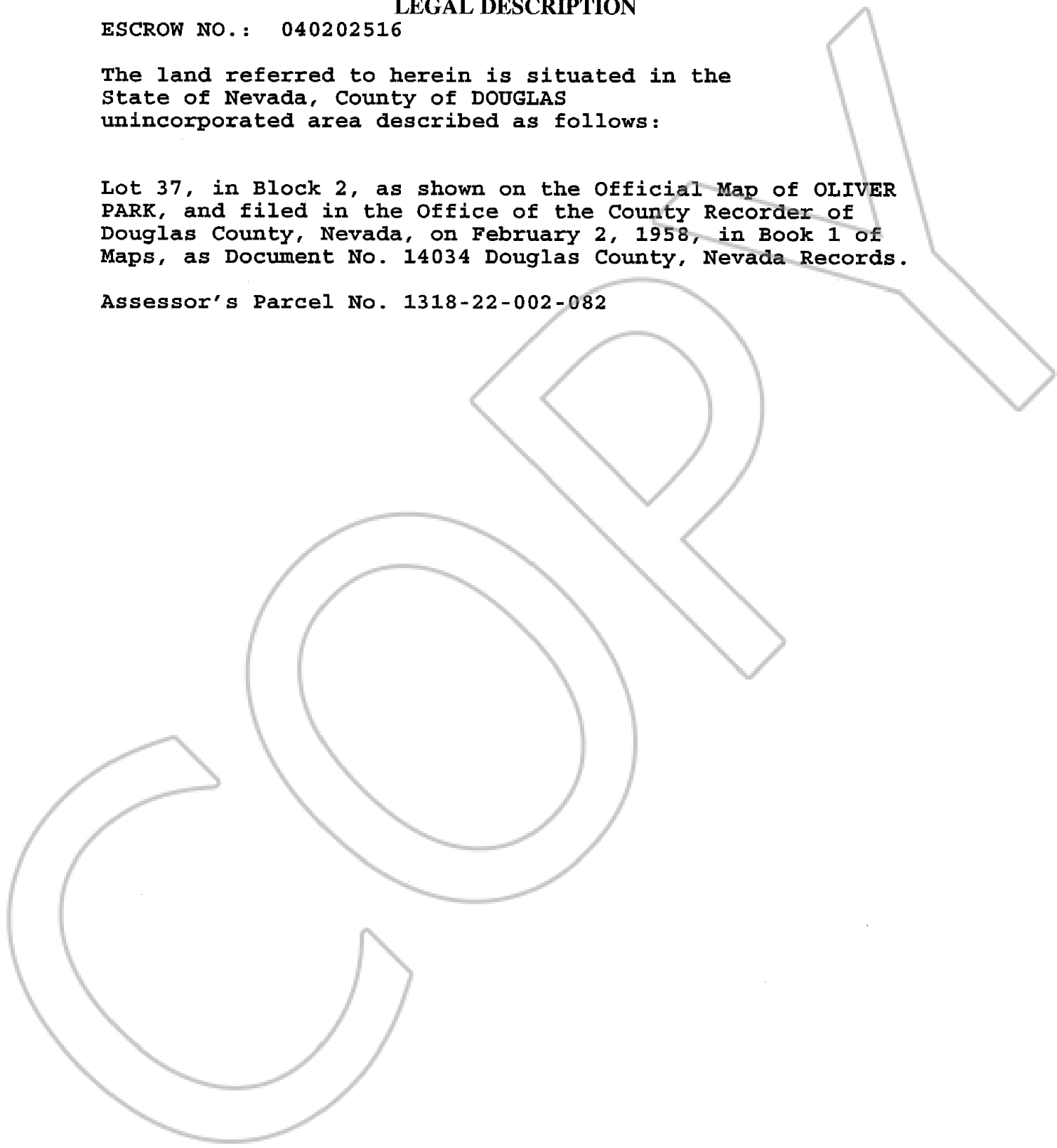

0629936

BK1104PG09818