



**EXHIBIT "A"**

**LEGAL DESCRIPTION**

ESCROW NO.: 040203164

The land referred to herein is situated in the State of Nevada, County of Douglas described as follows:

Lot 69, as shown on the map of TOPAZ RANCH ESTATES, UNIT NO. 3, filed in the Office of the County Record of Douglas County, State of Nevada, on March 31, 1969, as Document No. 44091.

ASSESSOR'S PARCEL NO. 1022-09-001-068

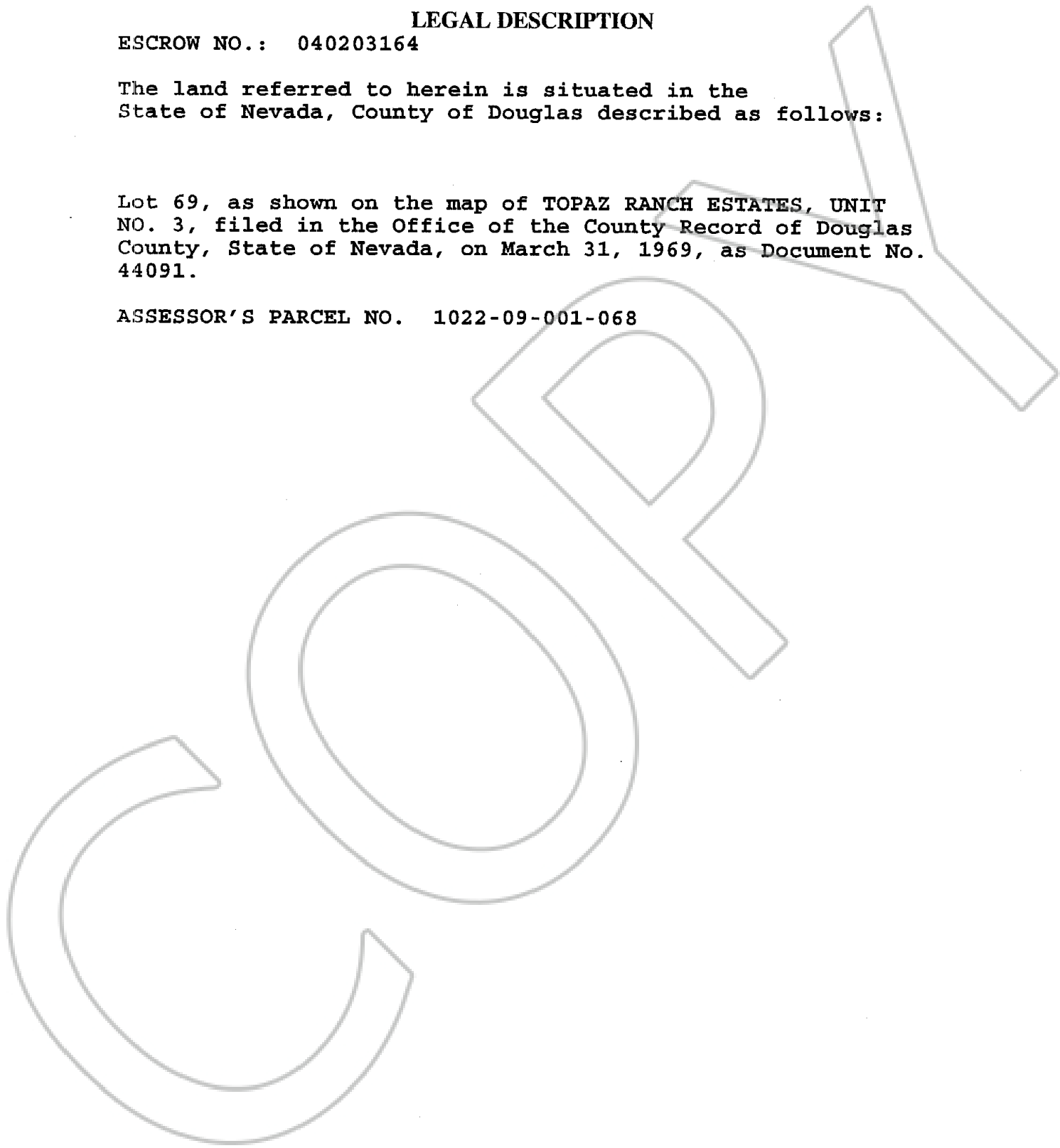

0629950

BK 1104 PG 09970