

A.P.N. # 1220-03-211-001

2004 NOV 23 AM 10:55

R.P.T.T. \$ 854.10
ESCROW NO. 040302646
RECORDING REQUESTED BY:
STEWART TITLE COMPANY
MAIL TAX STATEMENTS TO:
SAME AS BELOW

WERNER CHRISTEN
RECORDER
\$ 15.00 PAID KO DEPUTY

WHEN RECORDED MAIL TO:
ANITA L. MCGILLIVRAY
1351 SCARLET OAK DRIVE
GARDNERVILLE, NV 89410

(Space above for Recorder's Use Only)

CORPORATION
GRANT, BARGAIN, SALE DEED

THIS INDENTURE WITNESSETH: That
SYNCON HOMES, a Nevada Corporation, who acquired title as
SYNCON HOMES, INC.

in consideration of \$10.00, the receipt of which is hereby acknowledged, does hereby Grant, Bargain Sell
and Convey to
ANITA L. MCGILLIVRAY, an unmarried woman

and to the heirs and assigns of such Grantee forever, all that real property situated in the
County of **DOUGLAS** State of Nevada,
bounded and described as follows:

SEE EXHIBIT "A" ATTACHED HERETO AND MADE A PART HEREOF

Together with all and singular the tenements, hereditaments and appurtenances thereunto belonging or in
anywise appertaining, and any reversions, remainders, rents, issues or profits thereof.

DATE: **November 16, 2004** **SYNCON HOMES**
A NEVADA CORPORATION

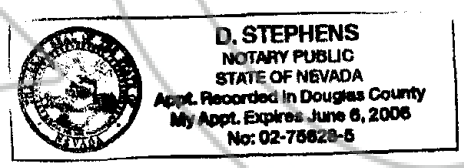

BY: Andrew W. Mitchell Pres
ANDREW W. MITCHELL
PRESIDENT

BY: _____

STATE OF Nevada }
COUNTY OF DOUGLAS } ss.

This instrument was acknowledged before me on 11.22.04
by, **ANDREW W. MITCHELL**

Signature [Handwritten Signature]

Notary Public (One Inch Margin on all sides of Document for Recorder's Use Only)

0630165
BK1104PG11059

EXHIBIT "A"

LEGAL DESCRIPTION

ESCROW NO.: 040302646

The land referred to herein is situated in the State of Nevada, County of DOUGLAS described as follows:

Lot 1, Block A, as set forth on Final Subdivision Map LDA 01-047, Planned Unit Development for Arbor Gardens, Phase 2, filed for record in the office of the County Recorder of Douglas County, State of Nevada on June 30, 2004 in Book 0604, Page 14661, as Document No. 617515.

ASSESSOR'S PARCEL NO. 1220-03-211-001

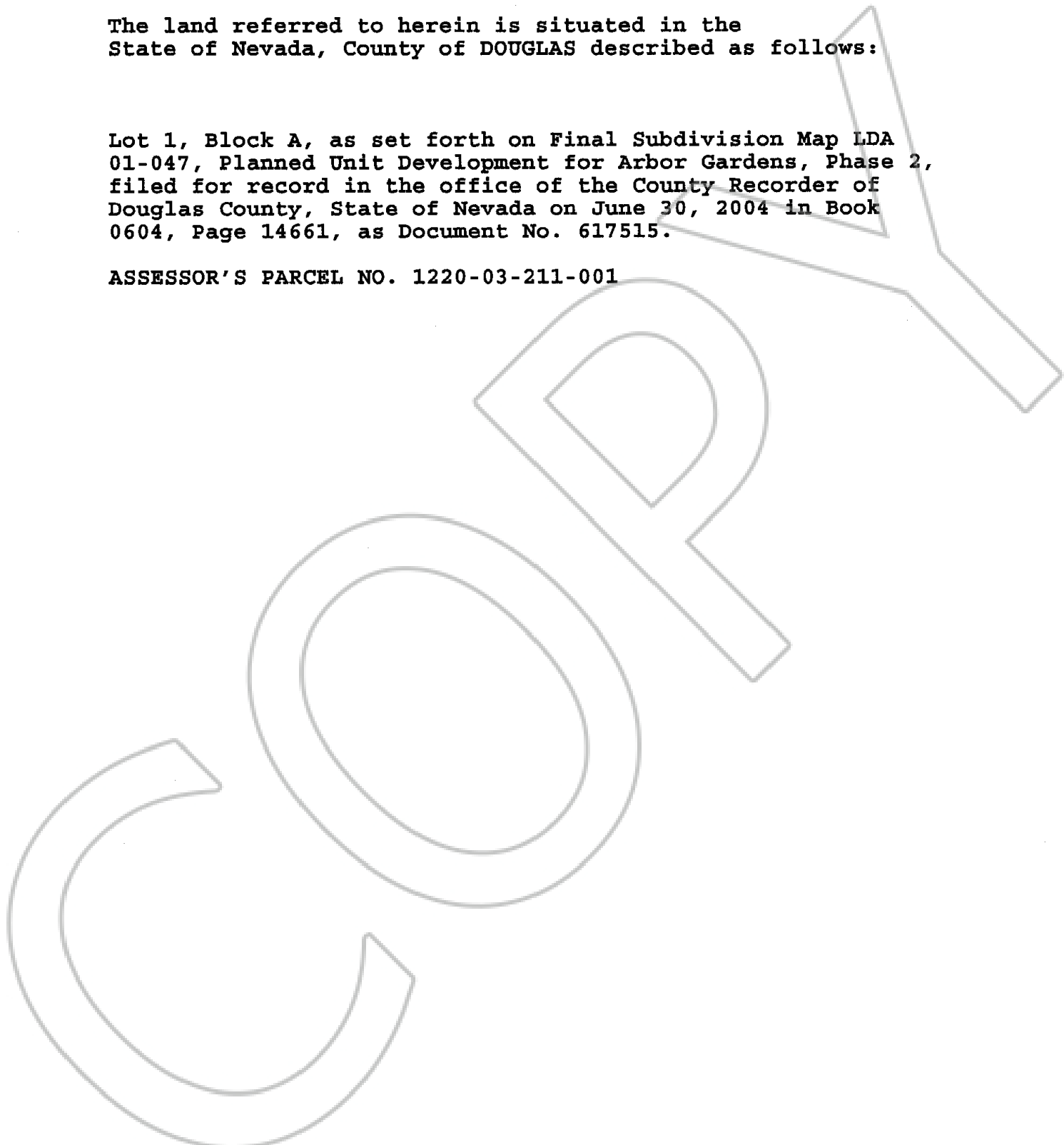

0630165

BK1104PG11060