





**EXHIBIT "A"**

**LEGAL DESCRIPTION**

ESCROW NO.: 040202536

The land referred to herein is situated in the State of Nevada, County of DOUGLAS unincorporated area described as follows:

Lot 442, as shown on the official map of GARDNERVILLE RANCHOS UNIT NO. 6, filed for record on May 29, 1973, in the office of the County Recorder of Douglas County, Nevada as Document No. 66512.

Assessors Parcel No. 1220-21-610-039

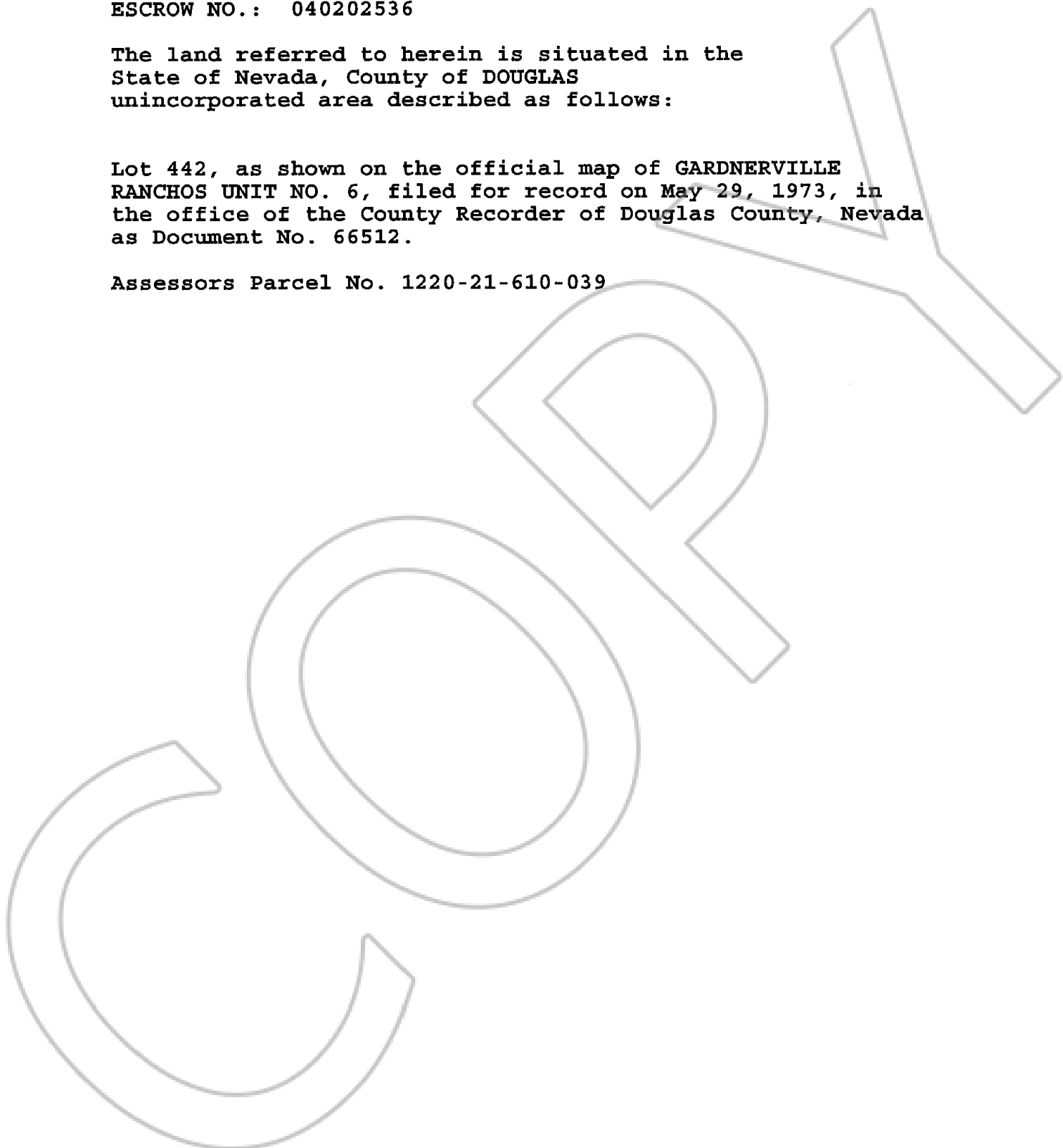

0630254

BK1104PG11640