

A.P.N. # 1320-33-817-017

R.P.T.T. \$ #5

ESCROW NO. 040301926

RECORDING REQUESTED BY:
STEWART TITLE COMPANY
MAIL TAX STATEMENTS TO:
SAME AS BELOW

WHEN RECORDED MAIL TO:
RAMAKRISHNA COMMURI
1376 CHICHESTER DRIVE
GARDNERVILLE, NV 89410

REQUESTED BY
Stewart Title of Douglas County

IN OFFICIAL RECORDS OF
DOUGLAS CO., NEVADA

2004 NOV 24 AM 11:53

WERNER CHRISTEN
RECORDER

\$15⁰⁰ PAID KJ DEPUTY

(Space Above for Recorder's Use Only)

GRANT, BARGAIN, SALE DEED

THIS INDENTURE WITNESSETH: That **SANDHYA RANI COMMURI**, spouse of
Grantee herein

in consideration of \$10.00, the receipt of which is hereby acknowledged, does hereby Grant, Bargain Sell
and Convey to **RAMAKRISHNA COMMURI**, a married man as his sole and
separate property

and to the heirs and assigns of such Grantee forever, all that real property situated in the
County of **DOUGLAS** State of Nevada, bounded and described as :

SEE EXHIBIT "A" ATTACHED HERETO AND MADE A PART HEREOF

IT IS THE EXPRESS INTENT OF THE GRANTOR, BEING THE SPOUSE OF THE GRANTEE, TO
CONVEY ALL RIGHT, TITLE AND INTEREST OF THE GRANTOR, COMMUNITY OR OTHERWISE,
IN AND TO THE HEREIN DESCRIBED PROPERTY TO THE GRANTEE AS GRANTEE'S SOLE AND
SEPARATE PROPERTY.

Together with all and singular the tenements, hereditaments and appurtenances thereunto belonging or in
anywise appertaining, and any reversions, remainders, rents, issues or profits thereof.

DATE: November 3, 2004
October 20, 2004

S. Sandhya Rani
SANDHYA RANI COMMURI

STATE OF NEVADA }
COUNTY OF DOUGLAS } ss.

PEGGY BRISTOL
Notary Public, State of Nevada
Appointment No. 02-74663-5
My Appt. Expires Apr. 22, 2006

This instrument was acknowledged before me on 11-3-04
by, SANDHYA RANI COMMURI

Signature PEGGY BRISTOL
Notary Public (One Inch Margin on all sides of Document for Recorder's Use Only)

0630279

BK1104PG11785

EXHIBIT "A"

LEGAL DESCRIPTION

ESCROW NO.: 040301926

The land referred to herein is situated in the State of Nevada, County of DOUGLAS described as follows:

Lot 17, in Block D, as set forth on FINAL SUBDIVISION MAP No. 1006-12 for CHICHESTER ESTATES, PHASE 12, filed in the office of the County Recorder of Douglas County, Nevada and recorded January 8, 2004 in Book 0104, Page 2012, as Document No. 601490.

ASSESSOR'S PARCEL NO. 1320-33-817-017

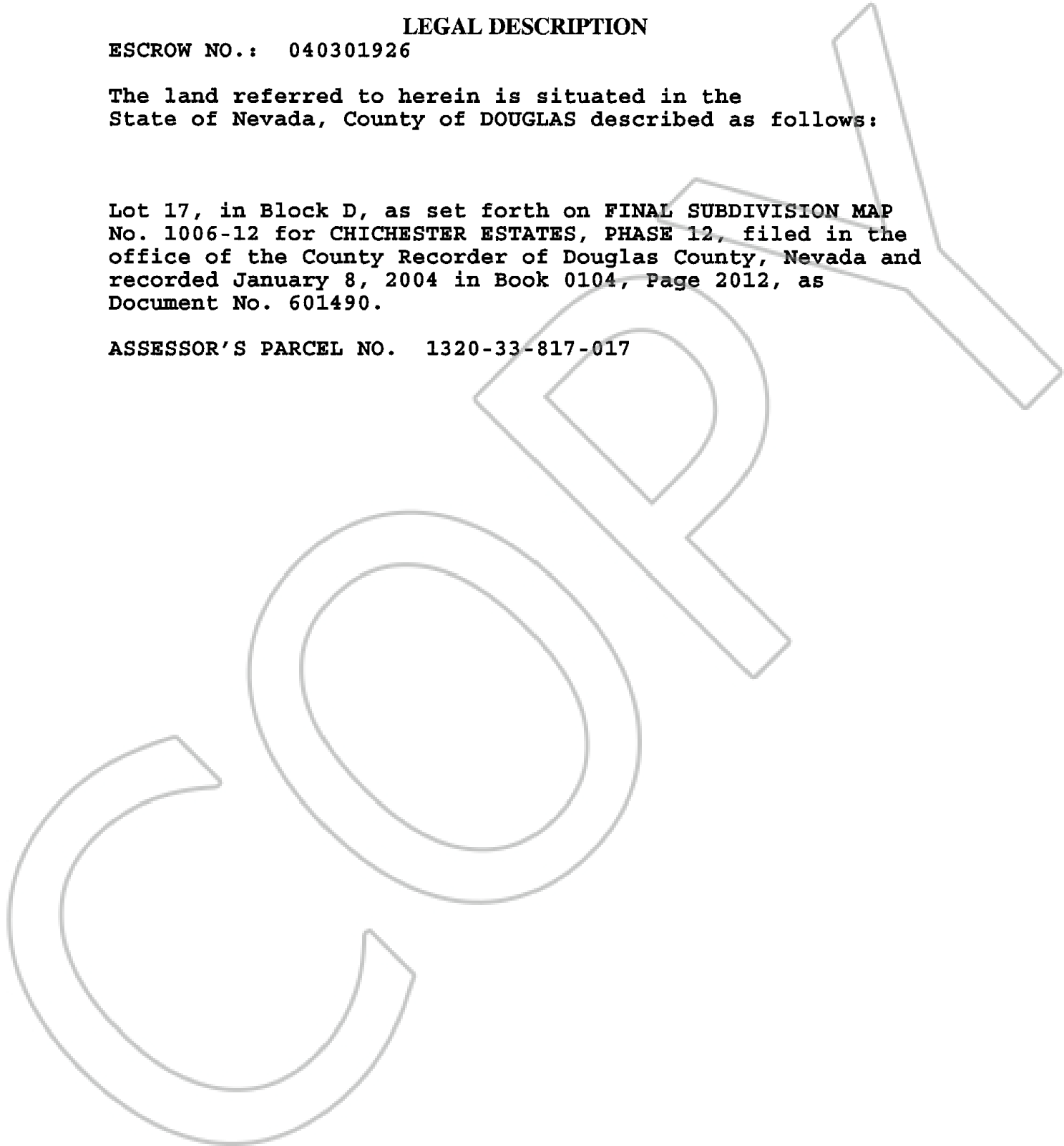

0630279

BK1104PG11786