



**EXHIBIT "A"**

**LEGAL DESCRIPTION**

ESCROW NO.: 040202517

The land referred to herein is situated in the State of Nevada, County of DOUGLAS unincorporated area described as follows:

Lot 17, in Block 2, as shown on the Official Map of OLIVER PARK, and filed in the Office of the County Recorder of Douglas County, Nevada, on February 2, 1958, in Book 1 of Maps, as Document No. 14034 Douglas County, Nevada Records.

Assessor's Parcel No. 1318-22-002-061

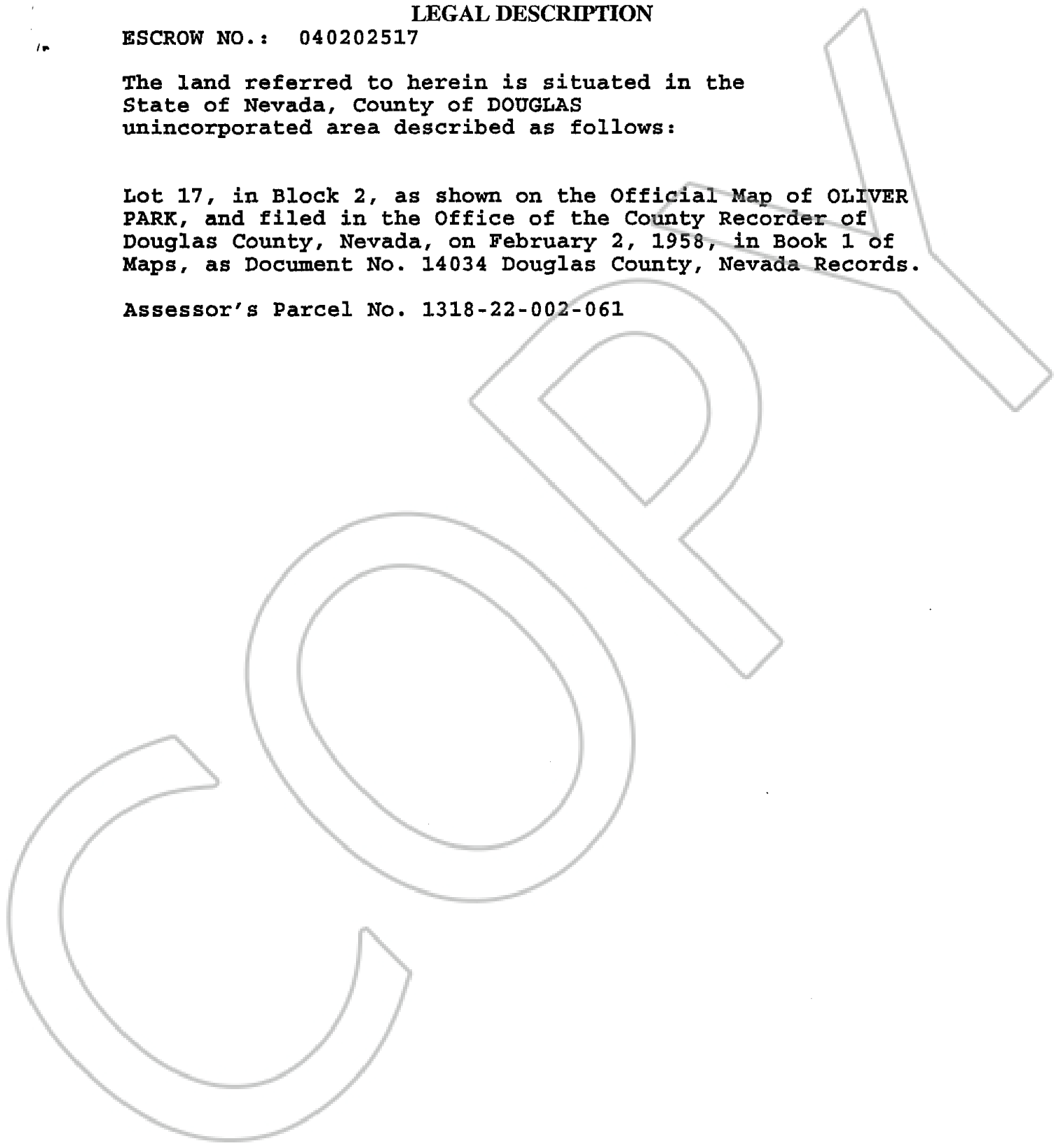

0630332

BK1104PG12115