



**EXHIBIT "A"**

**LEGAL DESCRIPTION**

**ESCROW NO.: 040102950**

**The land referred to herein is situated in the State of Nevada, County of Douglas described as follows:**

**Lot 17, Block F, as said Lot and Block are shown on the Amended map of RANCHOS ESTATES, filed in the office of the County Recorder of Douglas County, State of Nevada, on October 30, 1972, as Document No. 62493.**

**Assessor's Parcel No. 1220-16-210-165**

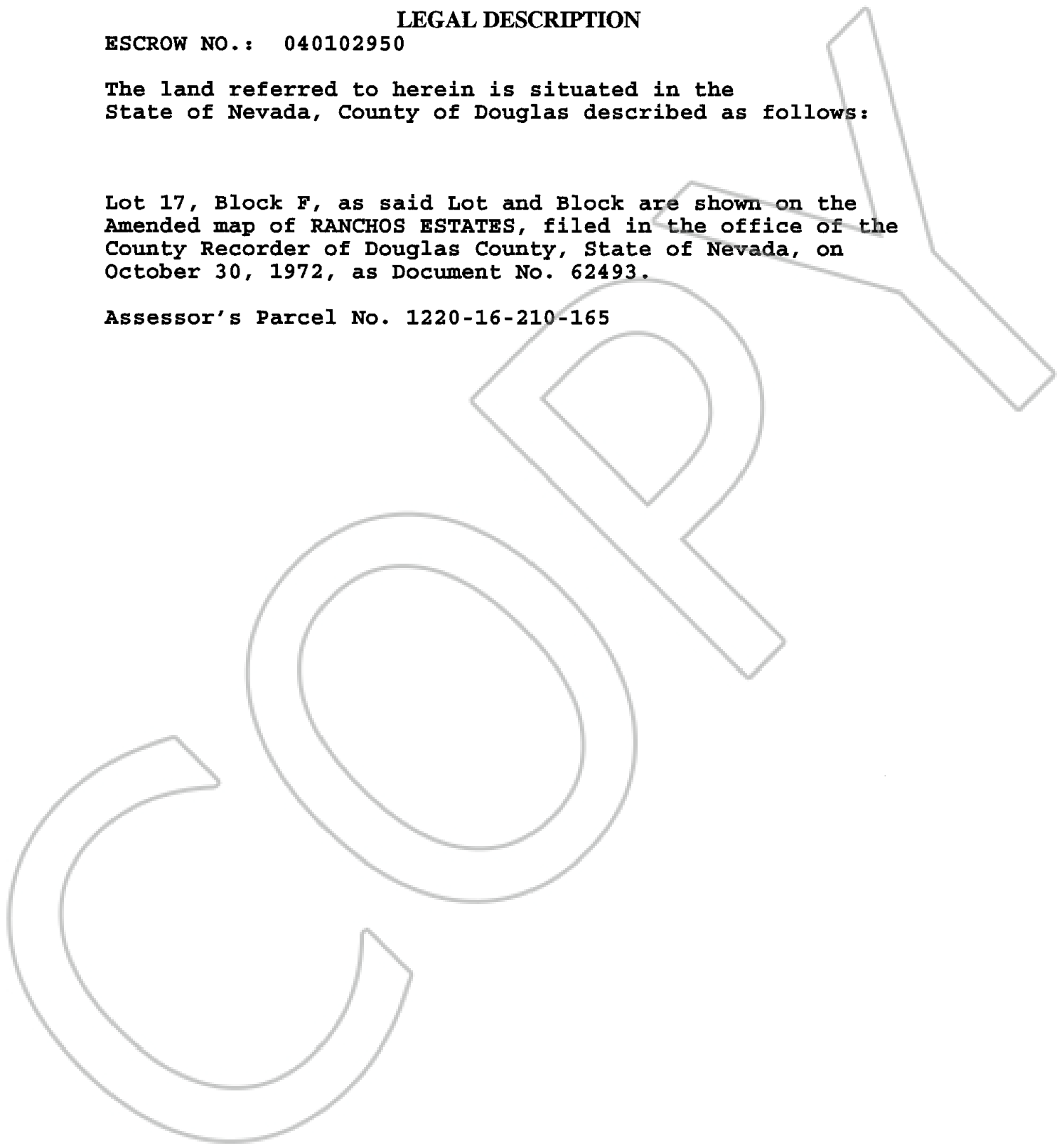

**0630720  
BK1204PG00082**