



**EXHIBIT "A"**

**LEGAL DESCRIPTION**

**ESCROW NO.: 040802770**

**The land referred to herein is situated in the State of Nevada, County of Douglas described as follows:**

**Lot 81, of FISH SPRINGS ESTATES, according to the map thereof, filed for record in the Office of the County Recorder of Douglas County, Nevada, on August 30, 1973, as Document No. 68451.**

**Assessors Parcel No. 1221-05-001-060**

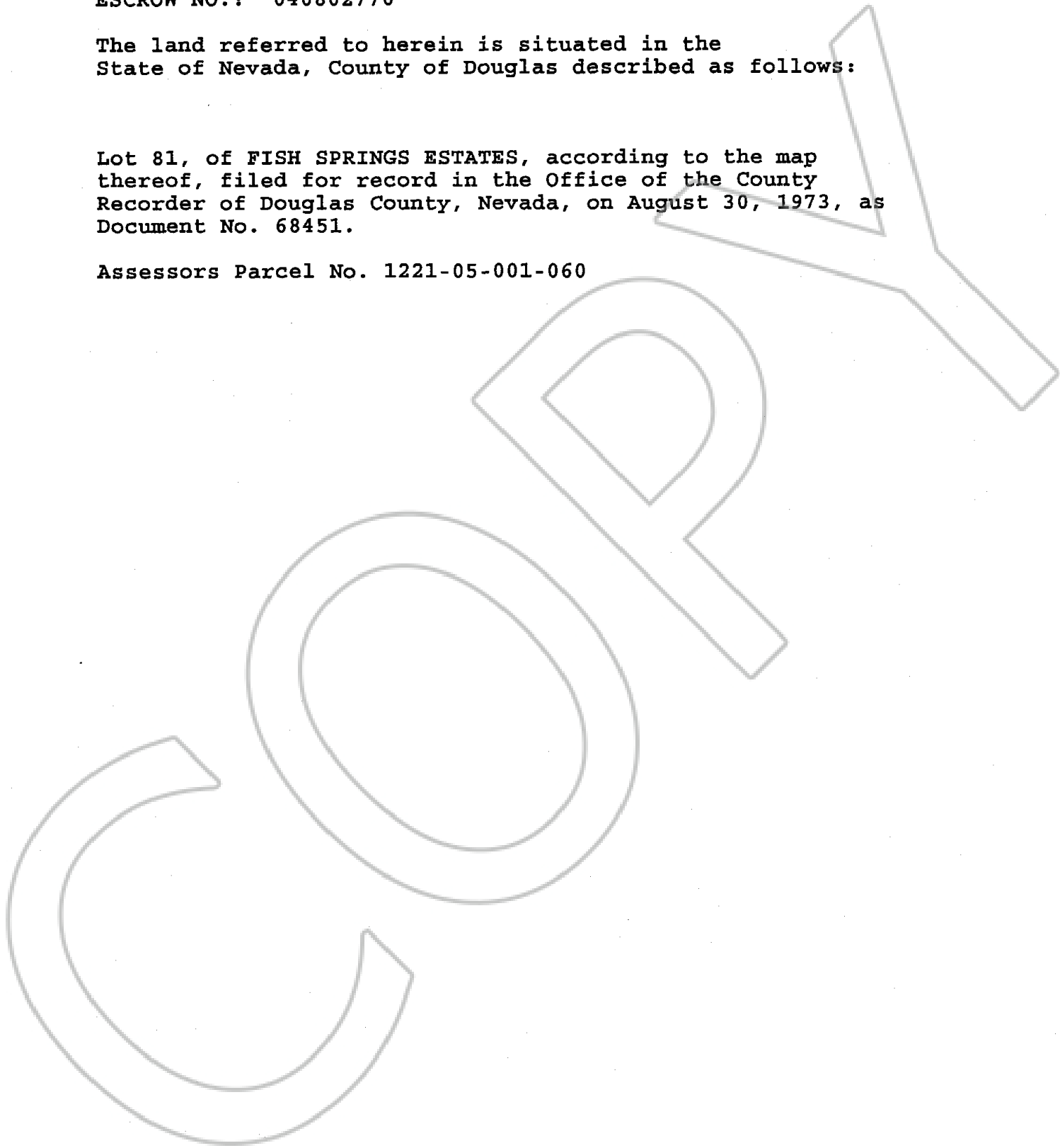

0631205

BK1204PG02620