

EXHIBIT "A"

LEGAL DESCRIPTION

ESCROW NO.: 040203166

The land referred to herein is situated in the State of Nevada, County of DOUGLAS unincorporated area described as follows:

Lot 66A, as shown on the map of LAKE VILLAGE UNIT NO. 2-D, filed in the Office of the County Recorder on June 5, 1972, as Document No. 59803, Official Records of Douglas County, State of Nevada.

Assessor's Parcel No. 1318-23-311-001.

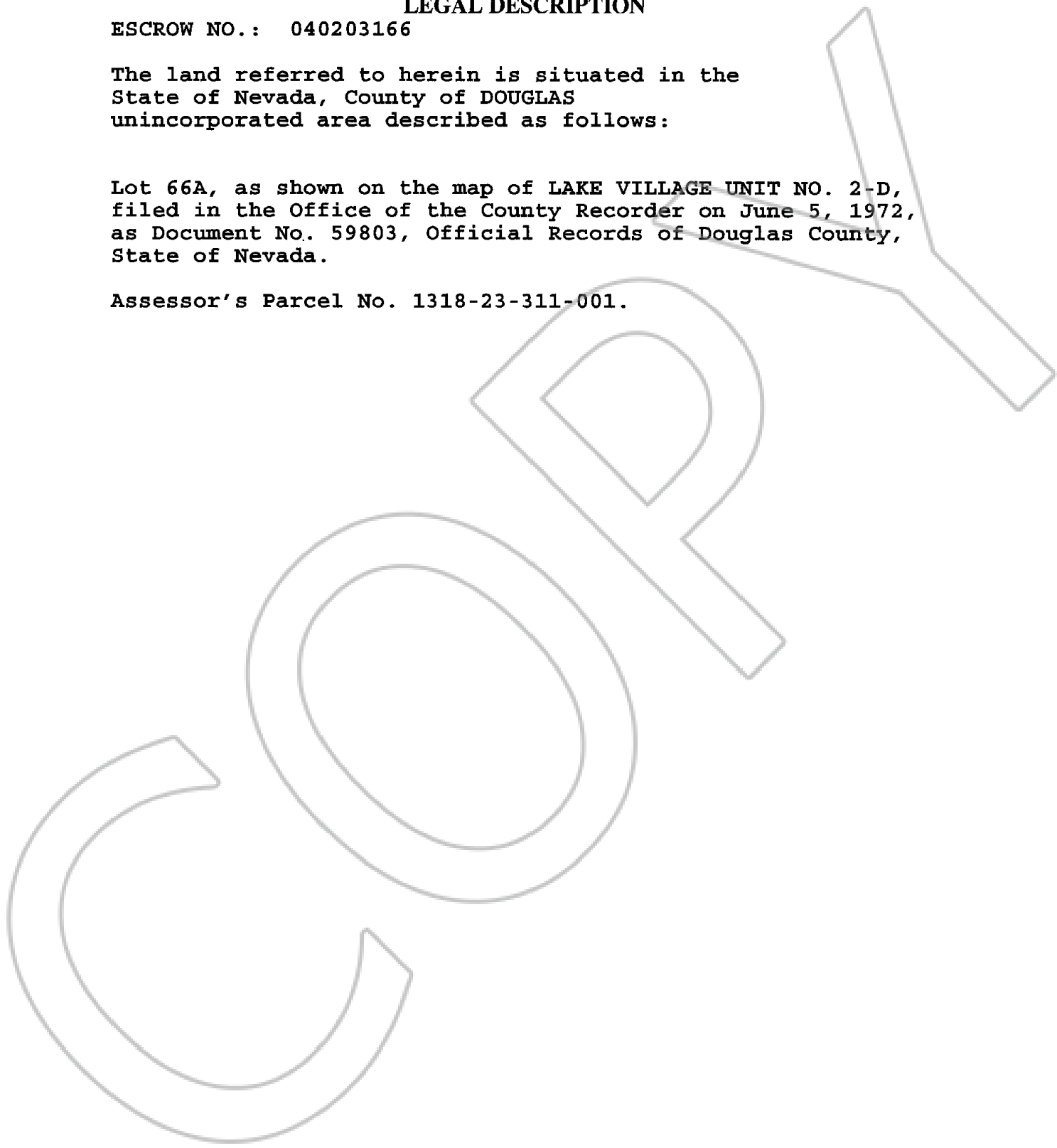

0631620

BK1204PG05073