

A.P.N. 1420-34-501-038 (Portion)

EXHIBIT "A"

**LEGAL DESCRIPTION
(Public Utility Easement)**

That portion of the Northeast ¼ of Section 34, Township 14 North, Range 20 East, M.D.B. & M. in the County of Douglas, State of Nevada being more particularly described as follows:

The Northerly 15.00 feet of Lot 77, Block 3 as said lot is shown on the Final Map for Bramwell Homestead, recorded in Book 0802 at Page 3324 as Document No. 549307 of the Official Records of said Douglas County.

Per NRS 111.312, this legal description was prepared by Western Engineering & Surveying Services, whose mailing address is 3032 Silver Sage Drive, Carson City, Nevada 89701

By: David D. Winchell
David D. Winchell, PLS 3209

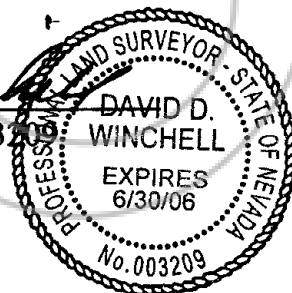

Dated: 12/13/05

0631818
BK 1204 PG 06028