

A.P.N. # 1022-11-002-007

ESCROW NO. 040300879
RECORDING REQUESTED BY:
STEWART TITLE COMPANY

WHEN RECORDED MAIL TO:
FRANK C. CONVERTINO
4041 EAGLE MOUNTAIN ROAD
WELLINGTON, NV 89444

REQUESTED BY
Stewart Title of Douglas County
IN OFFICIAL RECORDS OF
DOUGLAS CO., NEVADA

2004 DEC 15 PM 3:35

WERNER CHRISTEN
RECORDER
\$15⁰⁰ PAID *KJ* DEPUTY

(Space Above for Recorder's Use Only)

NOTICE OF COMPLETION

Must be filed within 15 days after completion NRS 108.228

Individual or Corporation

NOTICE IS HEREBY GIVEN:

1. That the interest or estate stated in paragraph 3 below in the real property hereinafter described is owned by the following:

NAME	STREET AND NO.	CITY	STATE
FRANK C. CONVERTINO	4041 EAGLE MOUNTAIN ROAD	WELLINGTON	NV 89444

(If more than one owner of the interest stated, the name and address of each must be inserted.)

TERESA M. CONVERTINO	4041 EAGLE MOUNTAIN ROAD	WELLINGTON	NV 89444
-----------------------------	---------------------------------	-------------------	-----------------

2. That the full name and address of the owner of said interest or estate, if there is only one owner, and the full names and addresses of all the co-owners who own said interest or estate as joint tenants, as tenants in common or otherwise, if there is more than one owner, are set forth in the preceding paragraph.

3. That the nature of the title of said owner, or if more than one, then of said owner and co-owners is: In Fee.

(If other than fee, strike out "In Fee" and insert for example "purchase under contract of purchase" or "lessee.")

4. That on the 6th day of December, 2004 a work of improvement on the real property hereinafter described was completed.

5. That the name of the original contractor, if any, for such work of improvement was WALTER & WALTER CONSTRUCTION

(If no contractor for work of improvement as a whole, insert "No Contractor.")

That the real property herein referred to is situated in the City of _____
County of DOUGLAS, State of Nevada and is described as follows:

See Exhibit "A" attached hereto and by reference made a part hereof for complete legal description.
Commonly known as: 4041 EAGLE MOUNTAIN ROAD, WELLINGTON, NV 89444

Read this note before signing.

If more than one owner, only one need sign, personally or by an agent. The owner or agent who signs the notice itself must also sign the verification below.

BY *[Signature]*
FRANK C. CONVERTINO

VERIFICATION

The undersigned being duly sworn, says: That he/she/they read the foregoing notice and knows the contents thereof and the same is true of his/her/their own knowledge.

STATE OF Nevada }

BY *[Signature]*
FRANK C. CONVERTINO

COUNTY OF Douglas } ss.

This instrument was acknowledged before me on 12-15-04
by, FRANK C. CONVERTINO

Signature *[Signature]*

Notary Public (One inch Margin on all sides of document for Recorder's Use ONLY)

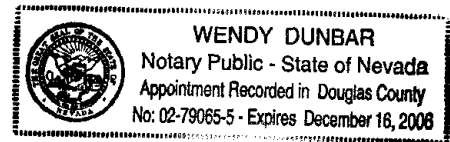

0632029

BK1204 PG07265

EXHIBIT "A"

LEGAL DESCRIPTION

ESCROW NO.: 040300879

The land referred to herein is situated in the State of Nevada, County of DOUGLAS described as follows:

Lot 35, as shown on the map of TOPAZ RANCH ESTATES, UNIT NO. 1, filed in the Office of the County Recorder of Douglas County, Nevada, on December 4, 1963, as Document No. 23962.

Assessors Parcel No. 1022-11-002-007

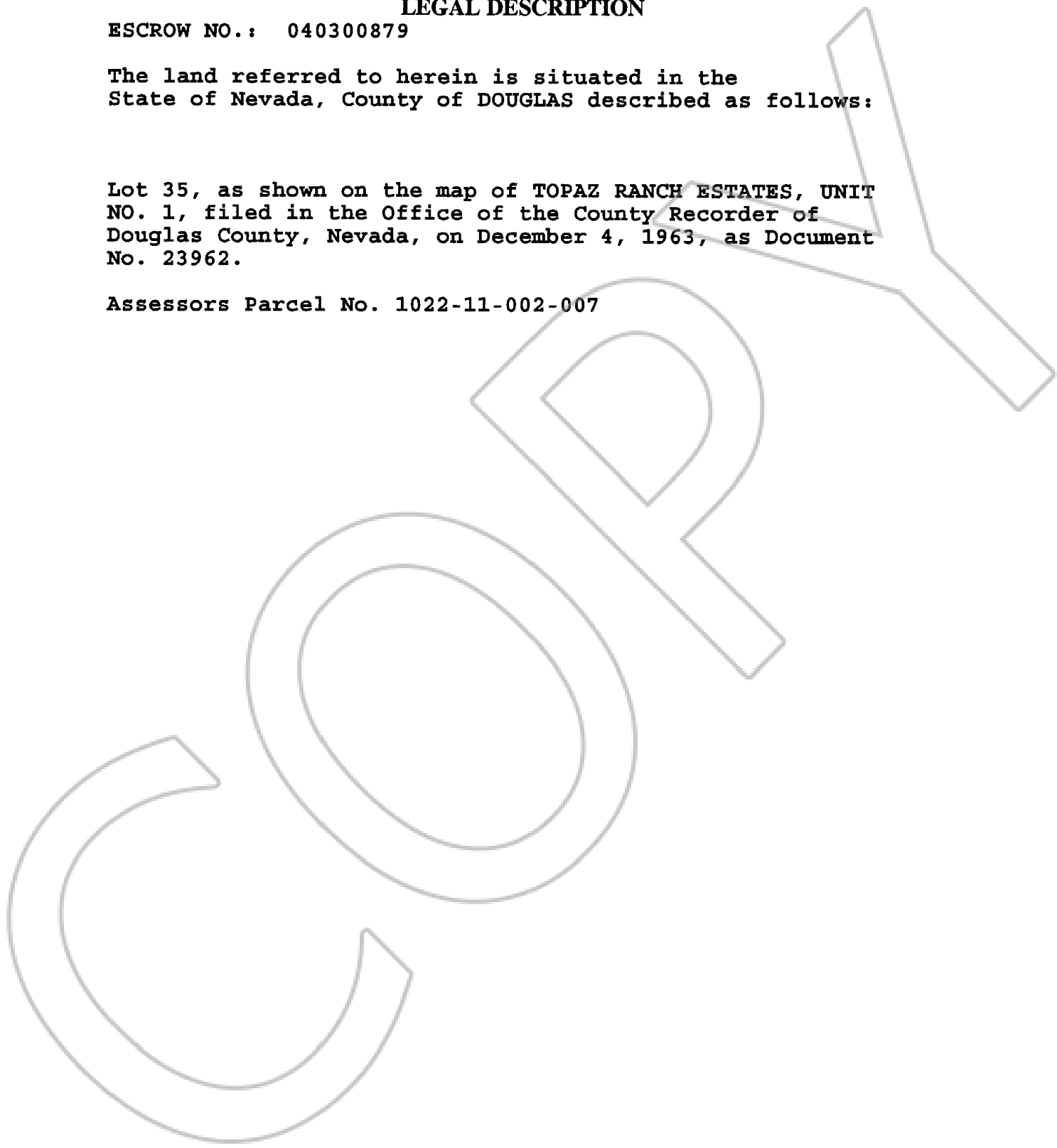

0632029

BK1204PG07266