

REQUESTED BY
MARQUIS TITLE & ESCROW
IN OFFICIAL RECORDS OF
DOUGLAS CO., NEVADA

2004 DEC 17 PM 3: 59

WERNER CHRISTEN
RECORDER

\$16.00 PAID *KJ* DEPUTY

Assessor's Parcel No.: 1319-19-714-023

RPTT: \$ na or Exempt #

Recording Requested by:

Marquis Title & Escrow, Inc.
1520 U.S. Highway 395 North
Gardnerville, NV 89410

Escrow Number: 24-5107

TITLE OF DOCUMENT: POWER OF ATTORNEY

COOPER

0632340
BK1204PG08656

Escrow No. 24-5107
A.P.N. 1319-19-714-03

SPECIAL POWER OF ATTORNEY

KNOWN ALL MEN BY THESE PRESENTS:

That, the undersigned, Richard D. Amos , of P.O. Box 5564, Stateline, NV 89449, does hereby appoint Janet M. Amos, of P.O. Box 5564, Stateline, NV 89449, as my true and lawful attorney, to sell, purchase or encumber that certain real property commonly known as 762 A Bigler Court, Stateline, NV 89449 and being all that real property situated in the County of Douglas , State of Nevada, being Assessor's Parcel Number specifically described as follows:

Giving and granting to my said attorney, full power to execute in my name, contracts, escrow instructions conveyances, bills of sale, mortgages, deed of trust, security agreements, and all other documents necessary to carry out the sale or purchase or refinance as fully to all intents and purposes as the undersigned might or could do if personally present, hereby ratifying and confirming all that my said attorney shall lawfully do, or cause to be done, by virtue of these presents.

The appointment herein, and the powers pursuant to the Special Power of Attorney, shall commence on the date hereof, and shall automatically terminate on March 1, 2005 , unless sooner revoked in writing recorded in the official records of Douglas, County, Nevada.

Dated: December 1, 2004.

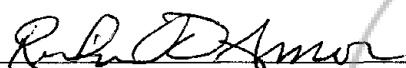
RICHARD D. AMOS

STATE OF NEVADA
COUNTY OF DOUGLAS

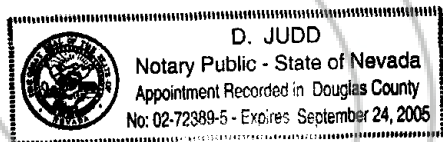

On December 1, 2004 personally appeared before me, a Notary Public, RICHARD D. AMOS , who acknowledged that he executed the above instrument.

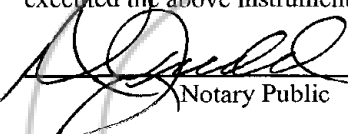
Notary Public

WHEN RECORDED MAIL TO:

JANET M. AMOS
P.O. BOX 5564
STATELINE, NV 89449

0632340
BK1204PG08657

LEGAL DESCRIPTION

All that certain lot, piece or parcel of land situate in the County of Douglas, State of Nevada, described as follows:

Lot 480A, as shown on that certain Parcel Map for BARRY R. BUEHLER, recorded June 10, 1980, in Book 680 of Official Records, at Page 1055, Douglas County, Nevada. Said Map being a Parcel Map of Lot 480, as shown on the amended map of SUMMIT VILLAGE, recorded in the office of the County Recorder of Douglas County, State of Nevada, on September 17, 1968, as Document No. 42231 and on second amended map recorded January 13, 1969, as Document No. 43419, Official Records of Douglas County, Nevada.

Assessor's Parcel No.: 1319-19-714-023

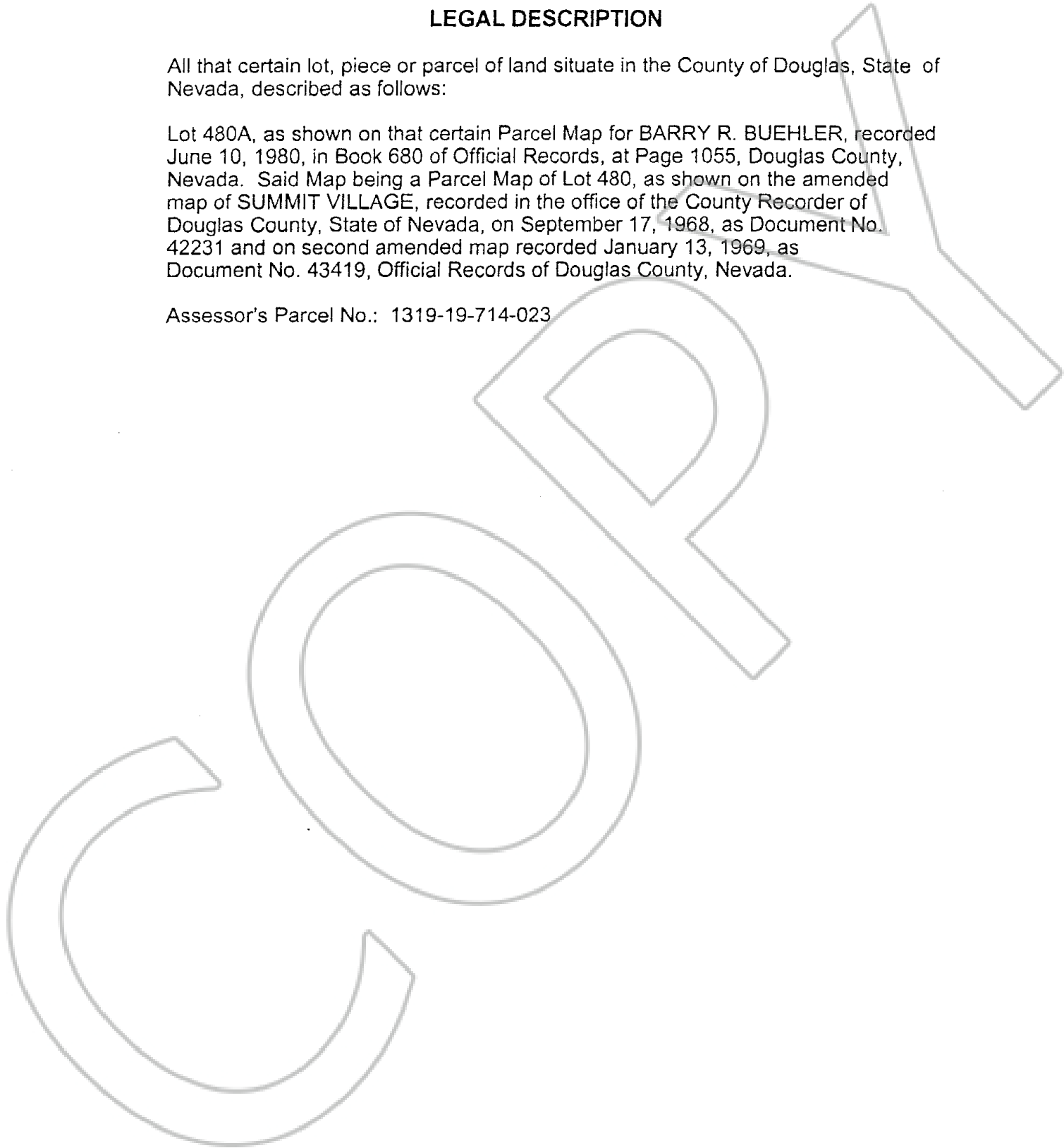

0632340
BK1204PG08658