

APN: 1320-32-210-006
WHEN RECORDED MAIL
TAX STATEMENTS TO:

✓ Ignacio and Gayle Sarratea
1164 Centerville Lane
Gardnerville, NV 89410

165
REQUESTED BY
Rowe + Hales
IN OFFICIAL RECORDS OF
DOUGLAS CO., NEVADA

2004 DEC 20 PM 3:31

WERNER CHRISTEN
RECORDER

\$ ⁰⁰16 PAID KJ DEPUTY

~~P.T.T. \$ #6~~

GRANT, BARGAIN, SALE DEED

THIS INDENTURE made the 10th day of December, Two Thousand Four (2004), for good and valuable consideration, the receipt of which is hereby acknowledged, Grantor IGNACIO SARRATEA and GAYLE SARRATEA, as Grantors (hereinafter GRANTOR) hereby grants, bargains and sells to the Trustees of the IGNACIO and GAYLE SARRATEA FAMILY REVOCABLE TRUST, u.t.d. December 10, 2004, (hereinafter GRANTEE), and to the heirs and assigns of such GRANTEE forever, all of that interest of GRANTOR located in State of Nevada, County of Douglas, Assessor's Parcel No. 1320-32-210-006, commonly known as 1537 Wildrose Street, Minden, Nevada. Such conveyance to GRANTEE is more particularly described as follows:

SEE EXHIBIT "A" ATTACHED HERETO

Together with all and singular the tenements, hereditaments and appurtenances thereunto belonging or in anywise appertaining, and any reversions, remainders, rents, issues or profits thereof.

///

///

0632470

BK1204PG09471

Witness my hand this 10th day of December, 2004.

GRANTOR:

Ignacio Sarratea
IGNACIO SARRATEA

Gayle Sarratea
GAYLE SARRATEA

A C K N O W L E D G E M E N T

STATE OF NEVADA)
) ss.
COUNTY OF DOUGLAS)

On December 10, 2004, before me, the undersigned, a Notary Public in and for said County and State, personally appeared IGNACIO SARRATEA and GAYLE SARRATEA known to me to be the persons whose names are subscribed to the within instrument and acknowledged that they executed the same.

WITNESS my hand and official seal

[Signature]
NOTARY PUBLIC

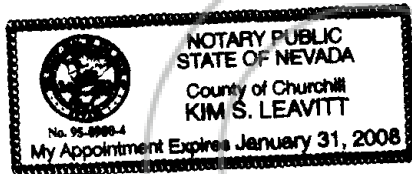
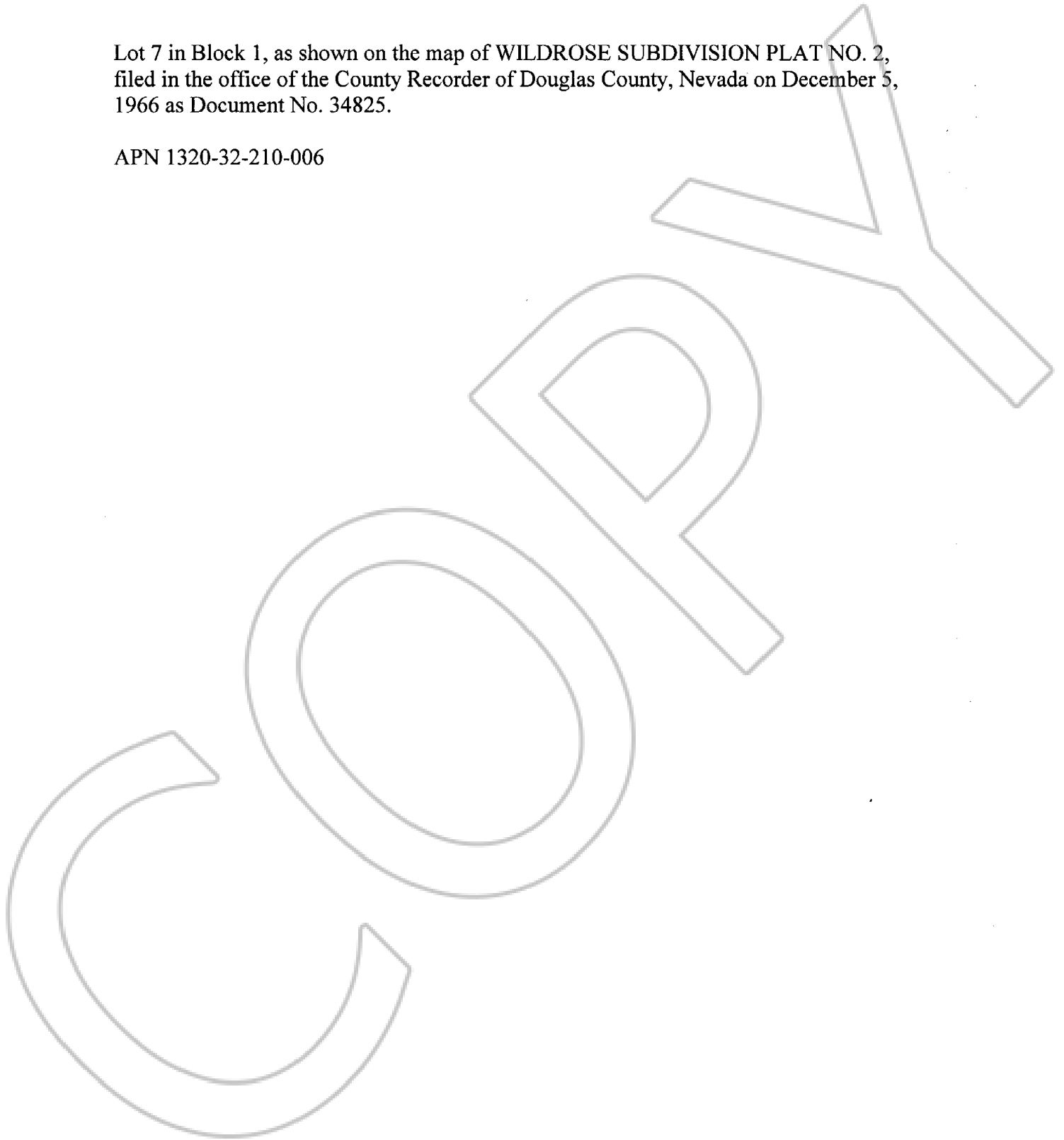

EXHIBIT "A"

Lot 7 in Block 1, as shown on the map of WILDROSE SUBDIVISION PLAT NO. 2,
filed in the office of the County Recorder of Douglas County, Nevada on December 5,
1966 as Document No. 34825.

APN 1320-32-210-006



0632470
BK 1204 PG 09473