

A.P.N. # 1420-33-610-023

R.P.T.T. \$ 1150.50

ESCROW NO. 040103242

RECORDING REQUESTED BY:
STEWART TITLE COMPANY
MAIL TAX STATEMENTS TO:
SAME AS BELOW

WHEN RECORDED MAIL TO:
GRANTEE
1314 CATHY LANE
MINDEN, NEVADA 89423

REQUESTED BY
Stewart Title of Douglas County
IN OFFICIAL RECORDS OF
DOUGLAS CO., NEVADA

2004 DEC 23 PM 2:05

WERNER CHRISTEN
RECORDER

\$15⁰⁰ PAID KY DEPUTY

(Space Above for Recorder's Use Only)

GRANT, BARGAIN, SALE DEED

THIS INDENTURE WITNESSETH: That DONNA HANKINS, A MARRIED WOMAN
AS HER SOLE AND SEPARATE PROPERTY

in consideration of \$10.00, the receipt of which is hereby acknowledged, does hereby Grant, Bargain Sell
and Convey to

ERNEST EDWARD PERKINS AND PAMELA JANE PERKINS, HUSBAND AND
WIFE AS JOINT TENANTS

and to the heirs and assigns of such Grantee forever, all that real property situated in the
County of **Douglas** State of Nevada, bounded and described as:

SEE EXHIBIT "A" ATTACHED HERETO AND MADE A PART HEREOF

Together with all and singular the tenements, hereditaments and appurtenances thereunto belonging or in
anywise appertaining, and any reversions, remainders, rents, issues or profits thereof.

DATE: **November 30, 2004**

Donna Hankins
DONNA HANKINS

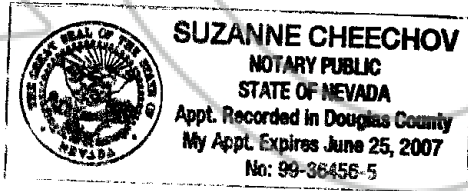

STATE OF NV }
COUNTY OF Douglas } ss.

This instrument was acknowledged before me on 12/20/04
by DONNA HANKINS

Signature Suzanne Cheechov
Notary Public (One inch margin on all sides of document for Recorder's Use Only)

0632821

BK1204PG11460

EXHIBIT "A"

LEGAL DESCRIPTION

ESCROW NO.: 040103242

The land referred to herein is situated in the State of Nevada, County of Douglas described as follows:

Lot 11, Block 3, as shown on the Plat of Mountain View Estates No. 2 recorded October 24, 1979, in Book 1079 of Official Records, at Page 1962, Douglas County, Nevada, as Document No. 38123.

Assessor's Parcel No. 1420-33-610-023

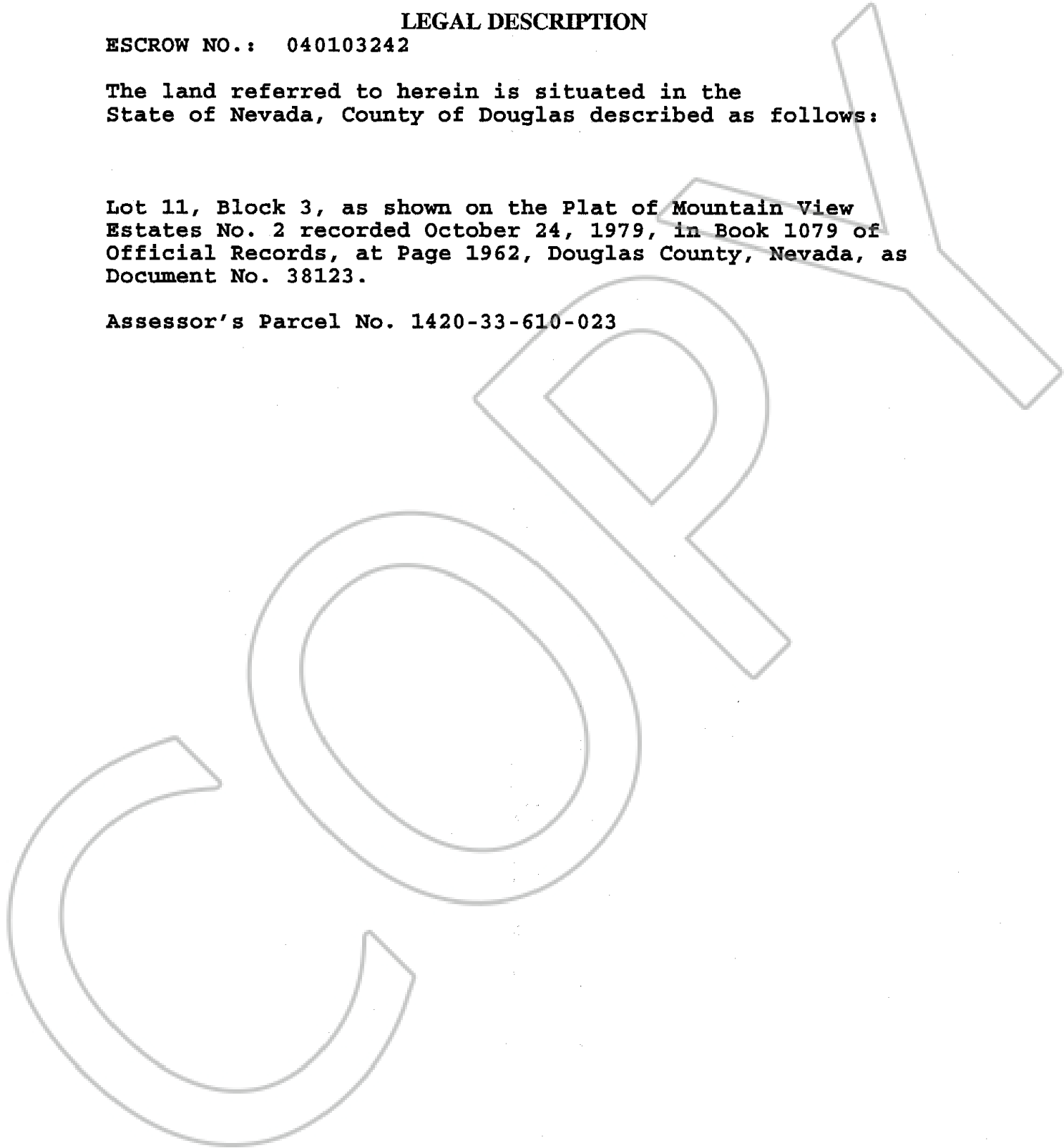

0632821

BK1204PG11461