

A.P.N. # 1320-30-213-006

R.P.T.T. \$ 694.20
ESCROW NO. 04023531

RECORDING REQUESTED BY:
STEWART TITLE COMPANY
MAIL TAX STATEMENTS TO:
SAME AS BELOW

WHEN RECORDED MAIL TO:
GRANTEE
1748 PINWOOD DRIVE, UNIT 6
MINDEN, NEVADA 89423

REQUESTED BY
Stewart Title of Douglas County
IN OFFICIAL RECORDS OF
DOUGLAS CO., NEVADA

2004 DEC 23 PM 2:09

WERNER CHRISTEN
RECORDER

\$ 16 PAID KJ DEPUTY

(Space Above for Recorder's Use Only)

GRANT, BARGAIN, SALE DEED

THIS INDENTURE WITNESSETH: That **ALFRED J. DEL VECCHIO AND LISA D. DEL VECCHIO, HUSBAND AND WIFE**

in consideration of \$10.00, the receipt of which is hereby acknowledged, does hereby Grant, Bargain Sell and Convey to **MARK W. CHARLES**, A MARRIED MAN AS HIS SOLE AND SEPARATE PROPERTY

and to the heirs and assigns of such Grantee forever, all that real property situated in the County of **Douglas** State of Nevada, bounded and described as:

SEE EXHIBIT "A" ATTACHED HERETO AND MADE A PART HEREOF

Together with all and singular the tenements, hereditaments and appurtenances thereunto belonging or in anywise appertaining, and any reversions, remainders, rents, issues or profits thereof.

DATE: **December 13, 2004**

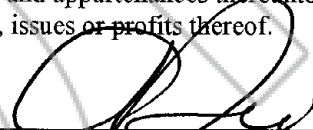
ALFRED J. DEL VECCHIO

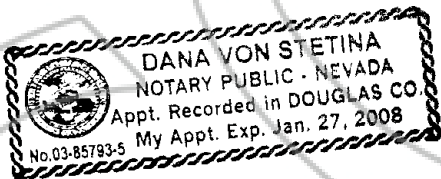

LISA D. DEL VECCHIO



STATE OF Nevada }

COUNTY OF Carson City }^{SS.}

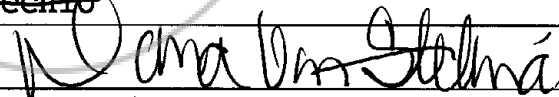
This instrument was acknowledged before me on December 17, 2004
by ALFRED J. DEL VECCHIO and LISA D. DEL VECCHIO

Signature 

Notary Public (One inch margin on all sides of document for Recorder's Use Only)

0632824

BK1204PG11489

STATE OF Nevada }
COUNTY OF Douglas } SS.

This instrument was acknowledged before me on 12/20/04, by
Lise D. Del Vecchio

WITNESS my hand and official seal.

Signature Helen Petri

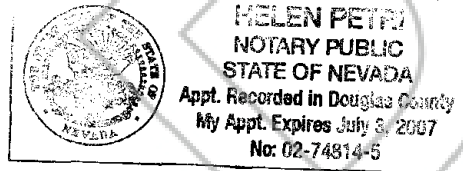

0632824

BK1204PG11490

EXHIBIT "A"
LEGAL DESCRIPTION

Order No.: 040503301

The land referred to herein is situated in the State of Nevada,
County of Douglas, described as follows:

Unit 6, as shown on the Official Map of Westwood Manor,
Phase I, filed for record in the Office of the County
Recorder of Douglas County, Nevada, on September 29, 1981,
as Document No. 60744.

Assessors Parcel No. 1320-30-213-006

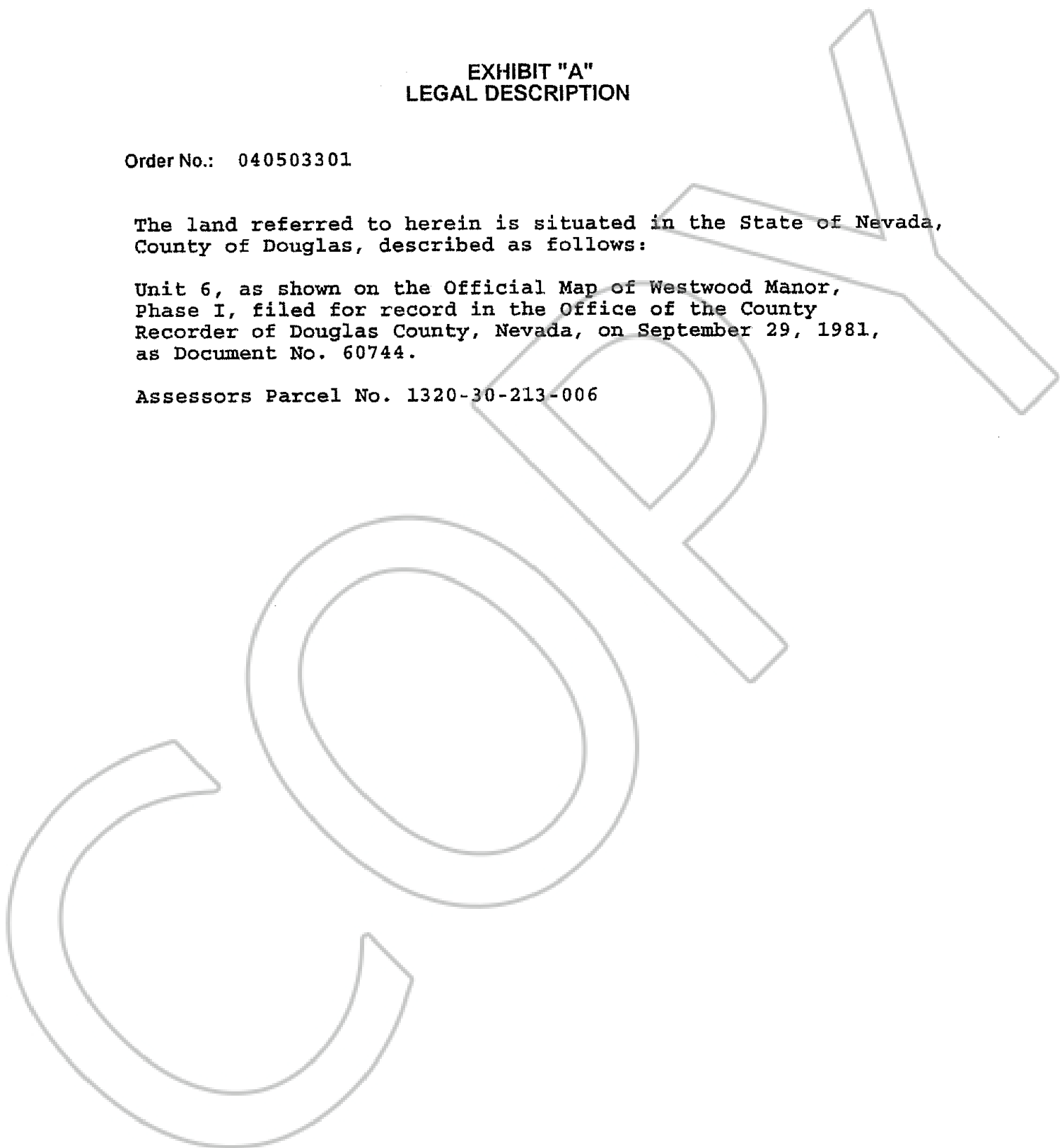

0632824

BK1204PG11491