

A.P.N. # 1022-11-002-031

R.P.T.T. \$ 819.00

ESCROW NO. 040102952

RECORDING REQUESTED BY:
STEWART TITLE COMPANY
MAIL TAX STATEMENTS TO:
SAME AS BELOW

WHEN RECORDED MAIL TO:
GRANTEE
4025 TOPAZ RANCH ROAD
WELLINGTON, NEVADA 89414

REQUESTED BY
Stewart Title of Douglas County
IN OFFICIAL RECORDS OF
DOUGLAS CO., NEVADA

2004 DEC 23 PM 3:37

WERNER CHRISTEN
RECORDER

\$ 15.00 PAID. KO DEPUTY

(Space Above for Recorder's Use Only)

GRANT, BARGAIN, SALE DEED

THIS INDENTURE WITNESSETH: That **JOHN DANIEL ROBINSON AND DOREEN K. ROBINSON, HUSBAND AND WIFE**

in consideration of \$10.00, the receipt of which is hereby acknowledged, does hereby Grant, Bargain Sell and Convey to **JAMES SOUZA AND CONNIE SOUZA, HUSBAND AND WIFE**



AS JOINT TENANTS WITH RIGHTS OF SURVIVORSHIP

and to the heirs and assigns of such Grantee forever, all that real property situated in the County of **Douglas** State of Nevada, bounded and described as:

SEE EXHIBIT "A" ATTACHED HERETO AND MADE A PART HEREOF

Together with all and singular the tenements, hereditaments and appurtenances thereunto belonging or in anywise appertaining, and any reversions, remainders, rents, issues or profits thereof.

DATE: **November 19, 2004**

JOHN DANIEL ROBINSON

DOREEN K. ROBINSON

 **SUZANNE CHEECHOV**
NOTARY PUBLIC
STATE OF NEVADA
Appt. Recorded in Douglas County
My Appt. Expires June 25, 2007
No: 99-36458-5

STATE OF NV }
 } }
COUNTY OF Douglas } } ss.

This instrument was acknowledged before me on 12/23/04
by JOHN DANIEL ROBINSON and DOREEN K. ROBINSON

Signature Suzanne Cheechov
Notary Public (One inch margin on all sides of document for Recorder's Use Only)

0632837
BK1204PG11567

**EXHIBIT "A"
LEGAL DESCRIPTION**

Order No.: 040102952

The land referred to herein is situated in the State of Nevada,
County of DOUGLAS, described as follows:

Lot 49, as shown on the map of TOPAZ RANCH ESTATES, UNIT
NO. 1, filed in the Office of the County Recorder of
Douglas County, Nevada, on December 4, 1963, as Document
No. 23962.

Assessors Parcel No. 1022-11-002-031

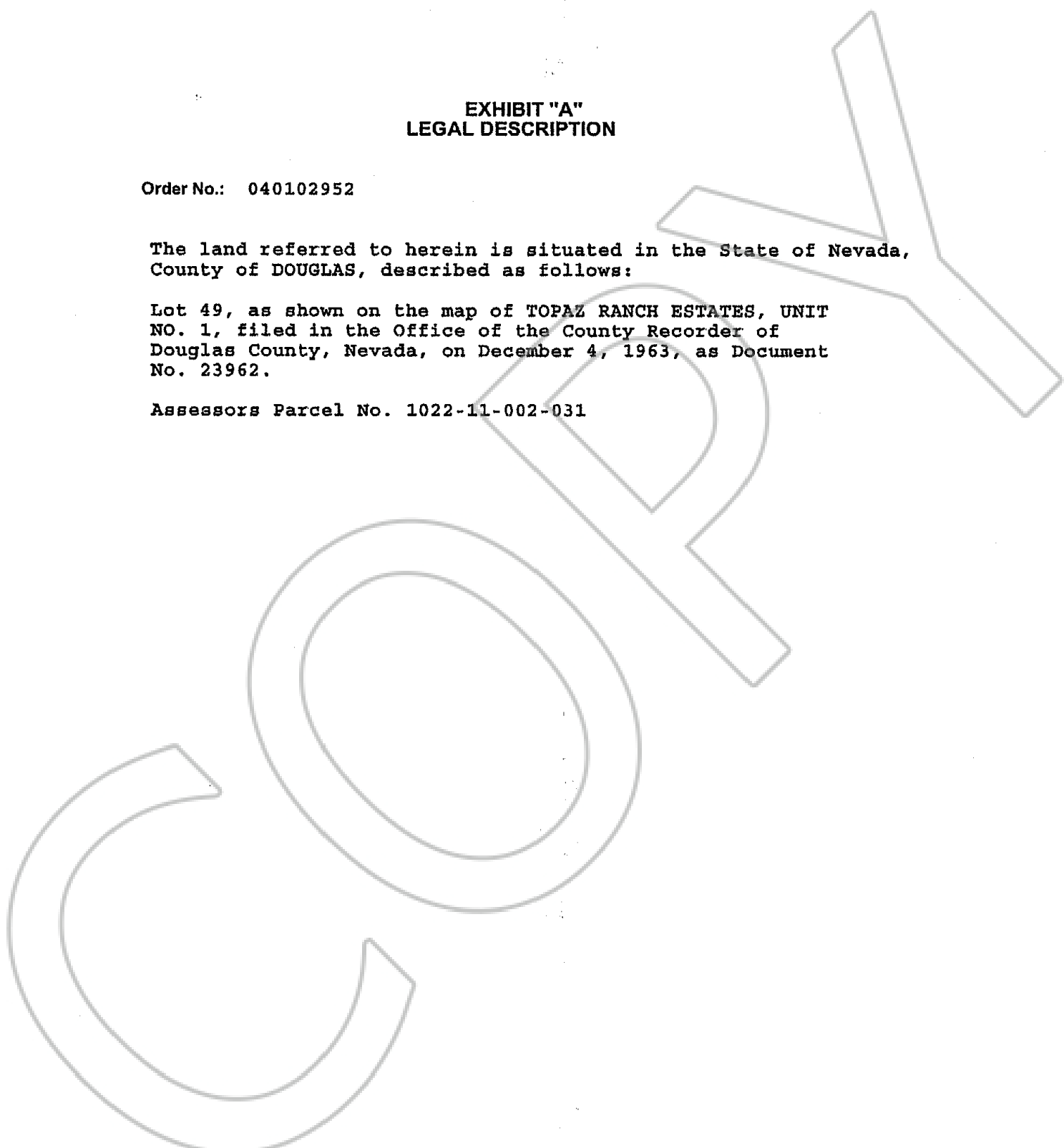

0632837
BK1204PG11568