

A.P.N. # 1320-32-111-011  
R.P.T.T. \$ 1579.50  
ESCROW NO. 040703136  
RECORDING REQUESTED BY:  
**STEWART TITLE COMPANY**  
MAIL TAX STATEMENTS TO:  
**SAME AS BELOW**

REQUESTED BY  
**Stewart Title of Douglas County**  
IN OFFICIAL RECORDS OF  
DOUGLAS CO., NEVADA  
2004 DEC 27 AM 11:33  
WERNER CHRISTEN  
RECORDER  
\$16.50 PAID KJ DEPUTY

WHEN RECORDED MAIL TO:  
**GRANTEE**  
*420 Cutler House*  
**GARDNERVILLE, NV 89460**

(Space Above for Recorder's Use Only)

**GRANT, BARGAIN, SALE DEED**

THIS INDENTURE WITNESSETH: That **GEORGE J. LEVER, IV, AN UNMARRIED MAN AND LYNNE CAULEY, AN UNMARRIED WOMAN**

in consideration of \$10.00, the receipt of which is hereby acknowledged, does hereby Grant, Bargain Sell and Convey to **TIM COHEE AND ANITA COHEE, HUSBAND AND WIFE**  
*B. M.*  
**AS JOINT TENANTS**

and to the heirs and assigns of such Grantee forever, all that real property situated in the County of **Douglas** State of Nevada, bounded and described as:  
**SEE EXHIBIT "A" ATTACHED HERETO AND MADE A PART HEREOF**  
Together with all and singular the tenements, hereditaments and appurtenances thereunto belonging or in anywise appertaining, and any reversions, remainders, rents, issues or profits thereof.

DATE: **November 19, 2004**

By HIS ATT. IN FACT  
**GEORGE J. LEVER IV**  
*GEORGE J. LEVER IV*  
**GEORGE J. LEVER, IV**  
*Lynne Cauley*  
**LYNNE CAULEY**

STATE OF Nevada }  
COUNTY OF Douglas } SS.

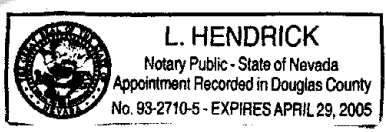

This instrument was acknowledged before me on 12-10-04  
by GEORGE J. LEVER, IV and LYNNE CAULEY

Signature L. Hendrick  
Notary Public (One inch margin on all sides of document for Recorder's Use Only)

0632955  
BK1204PG12119

STATE OF NEVADA )  
 ) SS.  
COUNTY OF DOUGLAS )

This instrument was acknowledged before me this 17<sup>th</sup> day of December, by George J. Lever III, as attorney in fact for George J. Lever IV.

L. Hendrick  
NOTARY PUBLIC

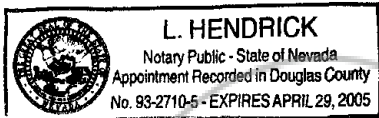

0632955

BK1204PG12120

**EXHIBIT "A"**

**LEGAL DESCRIPTION**

ESCROW NO.: 040703136

The land referred to herein is situated in the State of Nevada, County of Douglas described as follows:

Lots 11, 12, 13, and 14, in Block C, as shown on the map of TOWN OF MINDEN, filed for record in the office of the County Recorder of Douglas County, State of Nevada, in July 2, 1906, as Document No. 20840.

Assessors Parcel No. 1320-32-111-011

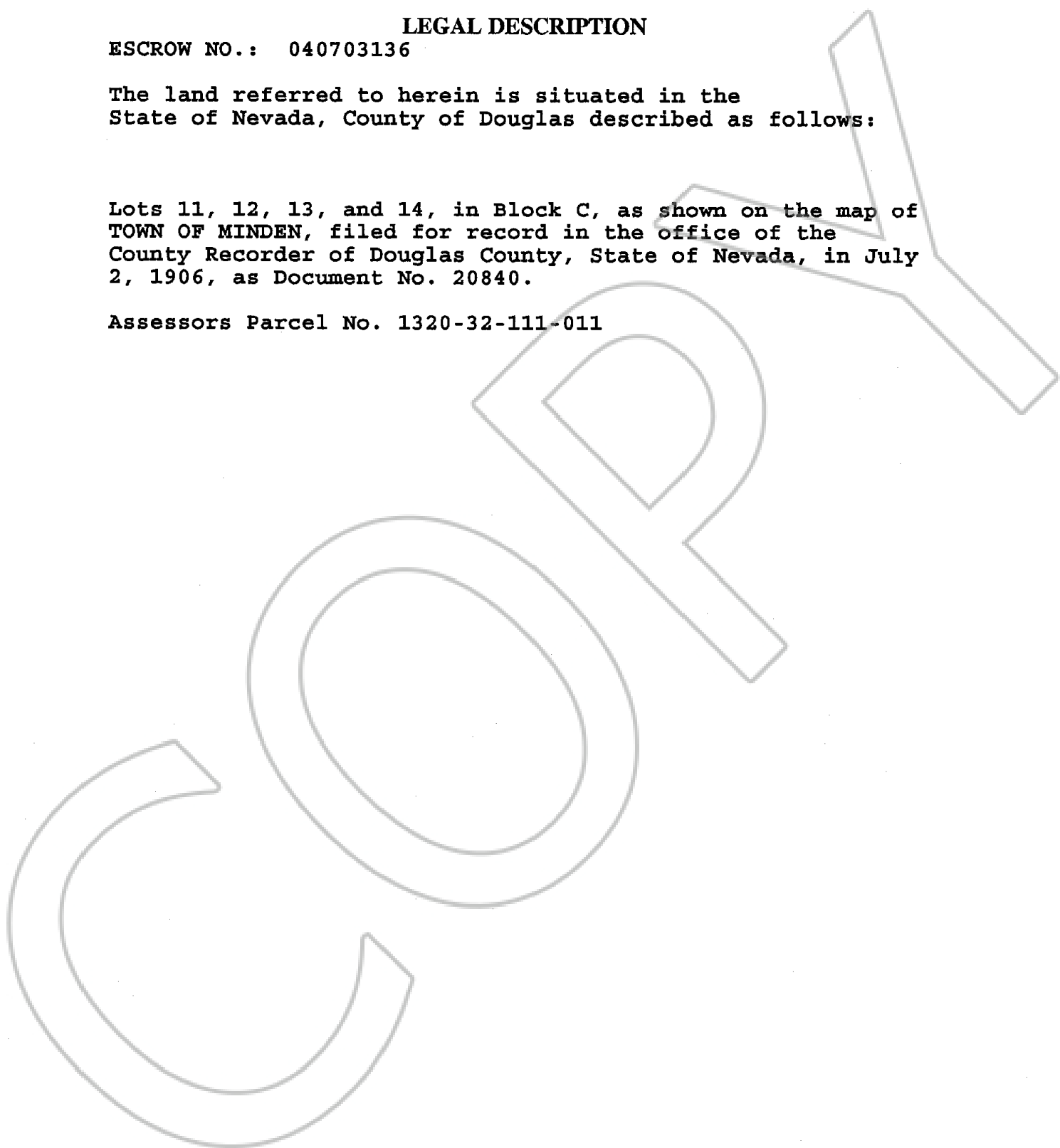

0632955

BK1204PG12121