

REQUESTED BY
WESTERN TITLE COMPANY, INC.
IN OFFICIAL RECORDS OF
DOUGLAS CO., NEVADA

2004 DEC 29 PM 2:54

WERNER CHRISTEN
RECORDER

SD
\$16 PAID *KJ* DEPUTY

APN: 1220-15-110-050
RPTT \$1,345.50

WHEN RECORDED MAIL TO:
Name SHANE MARTIN
Street 1438 TOPAZ LANE
Address
City,State GARDNERVILLE, NV 89410

MAIL TAX STATEMENTS TO:
Name SAME AS ABOVE
Street
Address
City,State

Order No. 00027631-501- CAS / 90589

(SPACE ABOVE THIS LINE FOR RECORDERS USE)

GRANT, BARGAIN AND SALE DEED

THIS INDENTURE WITNESSETH: That

FOR A VALUABLE CONSIDERATION, receipt of which is hereby acknowledged, DANIEL J. BARGER and CAROLYN E. BARGER HUSBAND AND WIFE AS JOINT TENANTS , do(es) hereby GRANT(s) BARGAIN SELL and CONVEY to SHANE MARTIN and SABRINA MARTIN HUSBAND AND WIFE AS JOINT TENANTS WITH RIGHT OF SURVIVORSHIP and to the heirs and assigns of such Grantee forever, all the following real property situated in the City of GARDNERVILLE, County of Douglas, State of Nevada bounded and described as follows:

SEE ATTACHED LEGAL DESCRIPTION

TOGETHER with all tenements, hereditaments and appurtenances, if any, thereto belonging or appertaining, and any reversions, remainders, rents, issues or profits thereof.

Dated: DECEMBER 28, 2004

0633275

BK1204PG13756

Daniel J. Barger
DANIEL J. BARGER

Carolyn E. Barger
CAROLYN E. BARGER

STATE OF NEVADA

COUNTY OF *Douglas* } ss
~~CARSON CITY~~

This instrument was acknowledged before me
on

12-28-04

by DANIEL J. BARGER AND CAROLYN E.
BARGER

L. Currer
Notary Public

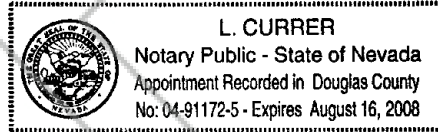

0633275

BK1204PG13757

Legal Description

All that certain lot, piece or parcel of land situate in the County of Douglas, State of Nevada, described as follows:

Lot 68, as shown on the map of GARDNERVILLE RANCHOS UNIT NO. 2, filed in the office of the County Recorder of Douglas County, State of Nevada, on June 1, 1965, in Book 31, Page 686, as Document No. 28309, and Amended Title Sheet recorded on June 4, 1965, in Book 31, Page 797, as Document No. 28377.

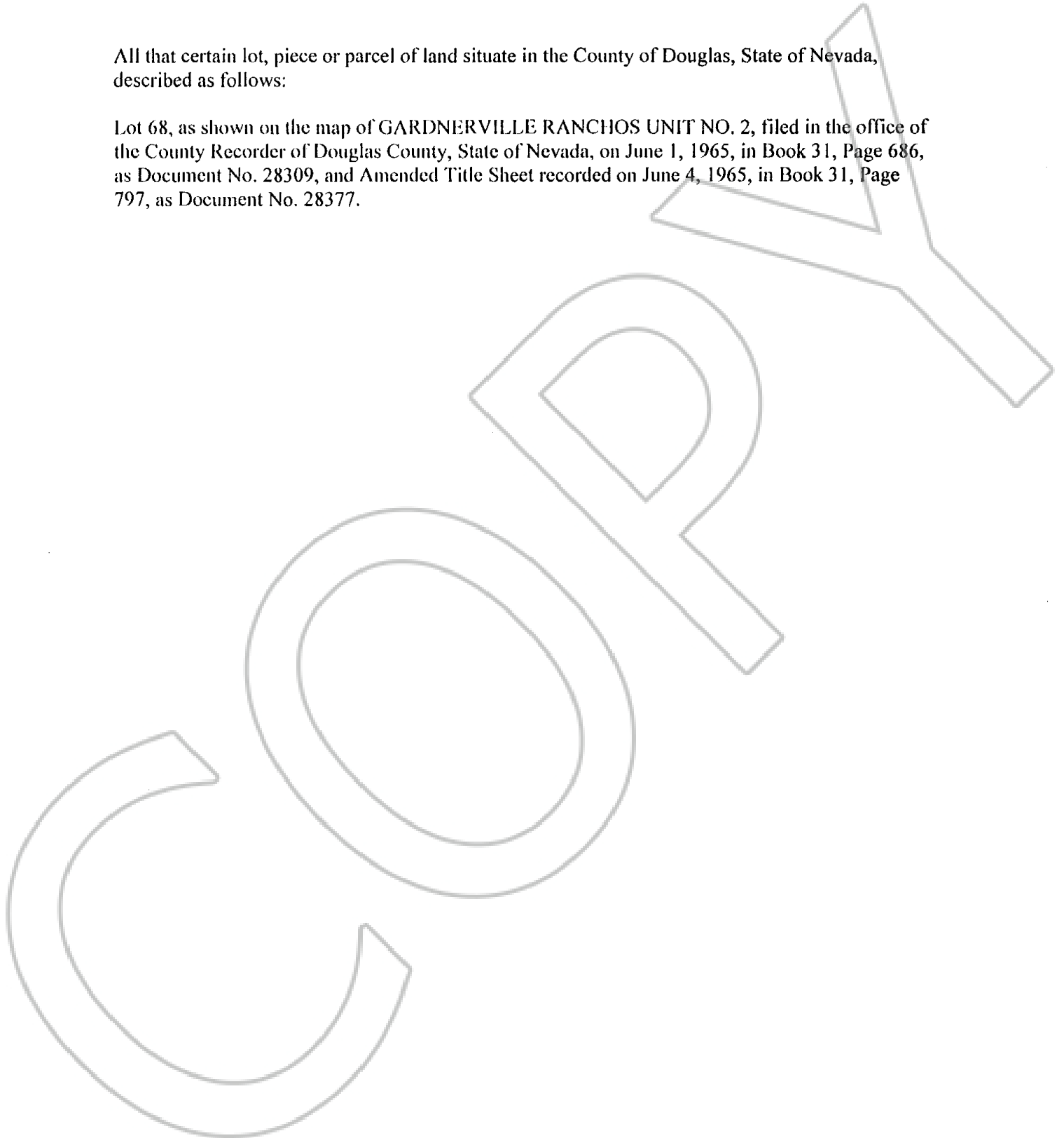

0633275
BK 1204 PG 13758