

TIE: NE Cor Lion 453 bears approx. 450' S from the NE Cor. Sec. 1, T13N-R23E

EXPLANATION

- Monuments of Location are set with 2"x2"x4' wood posts.
 - Claim corners are set with 2"x2"x4' wood posts.
- All claims measure 600' x 1500'.
Monuments of Location are set 10' into claim.

LOCATION DATE:
Lion 444-453 September 25, 2004

LOCATOR:
Nevada Eagle Resources, LLC
P. O. Box 18127
Reno, NV 89511

TIE:
The NE Corner of Lion 453 bears approximately 450' due South from the NE Corner of Section 1, T13N-R23E, Douglas County, Nevada

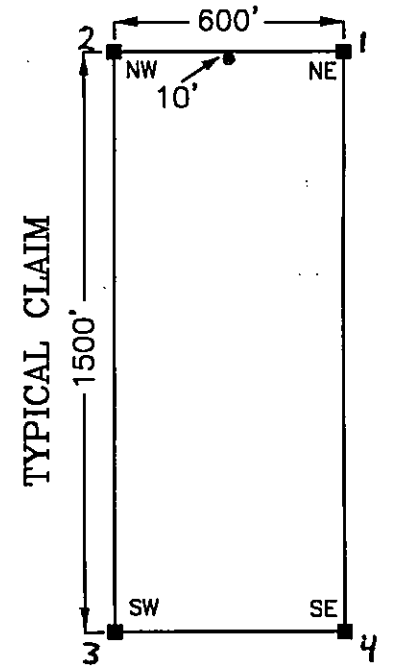

REQUESTED BY
NEVADA EAGLE RESOURCES
IN OFFICIAL RECORDS OF
DOUGLAS CO., NV
2004 DEC 30 AM 9:58
WERNER CHRISTEN
RECORDER
\$154.00 BY KJ
DOCUMENT #633341 - BOOK#1240 - PAGE#14152

Lion 444-453 Lode Mining Claims	
Sec. 1, T13N-R23E and Sec. 36, T14N-R23E, M.D.B.&M. Douglas County, Nevada	
Drawn By: JAT Drawing: Lion444-453Clms.DWG Layout: 500plot	Date: December 18, 2004

35 36
2 1

36 31
1 6
T 14 N
T 13 N

2 1
11 12

1 6
12 7

154⁰⁰

DOUGLAS COUNTY RECORDER

MAP REFERENCE SHEET

REQUESTED BY
Nevada Eagle Resources
IN OFFICIAL RECORDS OF
DOUGLAS CO., NEVADA

2004 DEC 30 AM 9:58

WERNER CHRISTEN
RECORDER

S/154⁰⁰ PAID KJ DEPUTY

MAP TYPE

- ANNEXATION MAP
- BOUNDARY MAP
- CONDOMINIUM MAP
- MINING MAP
 Claim Type: Lode: Placer Millsite Tunnel
 Claim Name(s): LION 444-453
- MISCELLANEOUS MAP
- LAND DIVISION MAP
- PARCEL MAP #
- PLANNED UNIT DEVELOPMENT # NAME:
- SUBDIVISION MAP # NAME:
- RECORD OF SURVEY MAP BLA LLA #

OWNER (S)/LOCATOR (S): (May be attached)

NEVADA EAGLE RESOURCES LLC

LEGAL DESCRIPTION: (May be attached)

SEC 1 T13N R23E MDB & M
SEC 36 T14N R23E MDB & M

RECMAPRE.doc

0633341

BK 1204 PG 14132