

A.P.N. # 1319-19-717-012

R.P.T.T. \$ # 30

ESCROW NO. 040203193

RECORDING REQUESTED BY:
STEWART TITLE COMPANY

MAIL TAX STATEMENTS TO:
MR KAROW
5487 GRACEN WAY
SACRAMENTO CA 95835

WHEN RECORDED MAIL TO:
MR KAROW
5487 GRACEN WAY
SACRAMENTO CA 95835

REQUESTED BY

Stewart Title of Douglas County
IN OFFICIAL RECORDS OF
DOUGLAS CO., NEVADA

2004 DEC 30 PM 1:47

WERNER CHRISTEN
RECORDER

\$ 15.00 PAID CF DEPUTY

(Space Above for Recorder's Use Only)

GRANT, BARGAIN, SALE DEED

THIS INDENTURE WITNESSETH: That **BRYON KAROW, A MARRIED MAN AS HIS SOLE AND SEPARATE PROPERTY**

in consideration of \$10.00, the receipt of which is hereby acknowledged, does hereby Grant, Bargain Sell and Convey to **BRYON KAROW AND HELEN S. KAROW, HUSBAND AND WIFE AS JOINT TENANTS WITH RIGHT OF SURVIVORSHIP**

and to the heirs and assigns of such Grantee forever, all that real property situated in the **unincorporated area** County of **Douglas** State of Nevada, bounded and described as:
SEE EXHIBIT "A" ATTACHED HERETO AND MADE A PART HEREOF

Together with all and singular the tenements, hereditaments and appurtenances thereunto belonging or in anywise appertaining, and any reversions, remainders, rents, issues or profits thereof.

DATE: **December 23, 2004**

Bryon A. Karow
BRYON KAROW

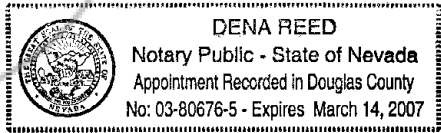

STATE OF Nevada }
COUNTY OF Douglas } ss.

This instrument was acknowledged before me on 12-23-04
by **BRYON KAROW**

Dena Reed
Signature

Notary Public (One inch margin on all sides of document for Recorder's Use Only)

0633435

BK1204PG14644

EXHIBIT "A"

LEGAL DESCRIPTION

ESCROW NO.: 040203193

The land referred to herein is situated in the State of Nevada, County of Douglas described as follows:

Lot 415A, as shown on the Amended Map of SUMMIT VILLAGE recorded in the Office of the County Recorder of Douglas County, Nevada, on September 17, 1968, as Document No. 42231, and on SECOND AMENDED MAP recorded on January 13, 1969, as Document No. 43419, Official Records of Douglas County, Nevada.

Assessor's Parcel No. 1319-19-717-012

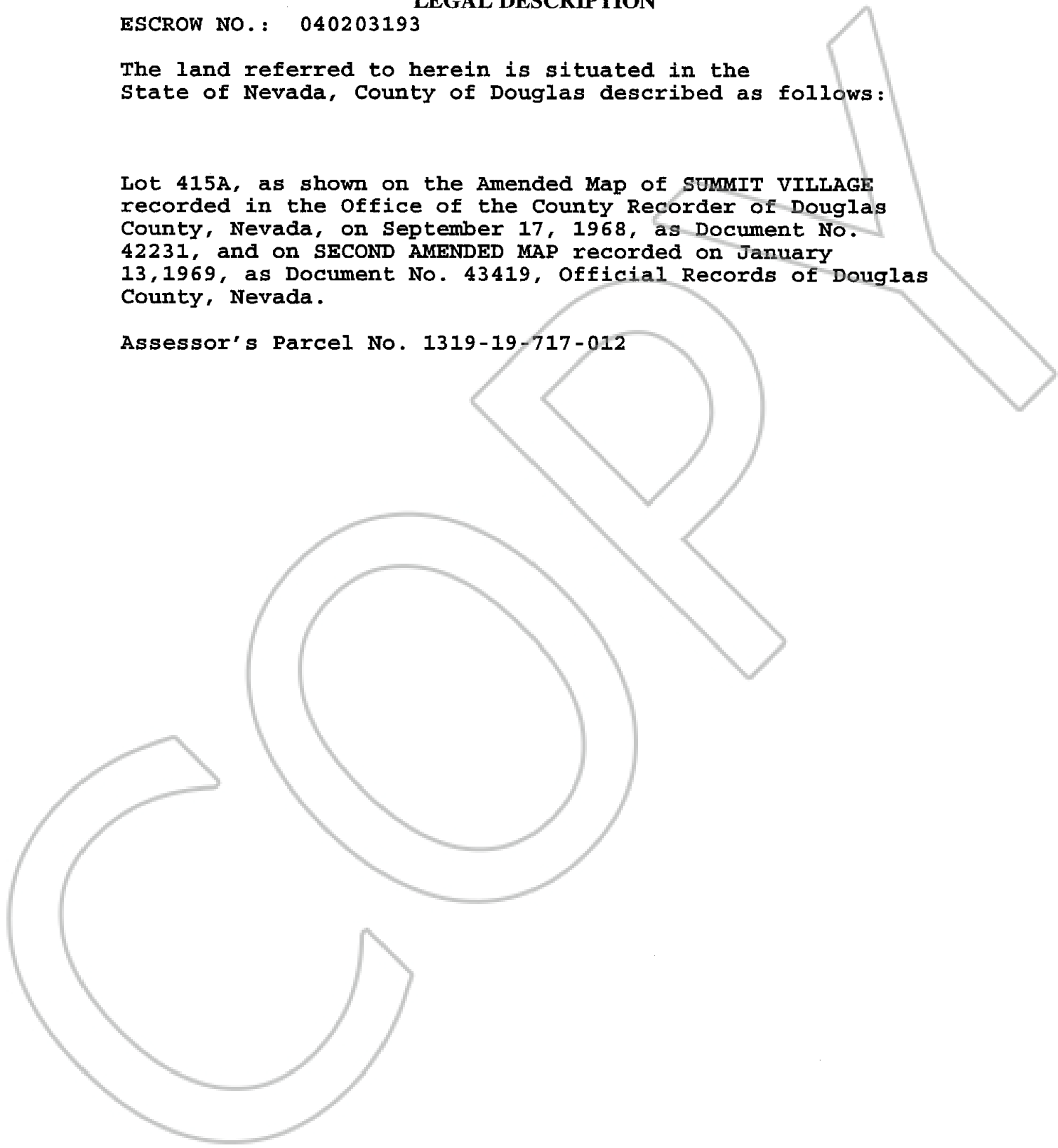

0633435

BK1204PG14645