

OFFICIAL RECORD

Requested By:
STEWART TITLE

APN: 1221-04-001-008

R.P.T.T. #3

ORDER NO. 050800264

Mail tax statements same as below

WHEN RECORDED MAIL TO:

Bently Family Ltd. Partnership

P.O. Box B

Minden, NV 89423

Douglas County - NV
Werner Christen - Recorder

Page: 1 Of 2 Fee: 15.00
BK-0405 PG-00650 RPIT: # 3



**BOUNDARY LINE ADJUSTMENT
GRANT, BARGAIN, SALE DEED**

THIS INDENTURE WITNESSETH: BENTLY FAMILY LIMITED PARTNERSHIP, A NEVADA LIMITED PARTNERSHIP, in consideration of \$10.00, the receipt of which is hereby acknowledged, does hereby Grant, Bargain Sell and Convey to BENTLY FAMILY LIMITED PARTNERSHIP, A NEVADA LIMITED PARTNERSHIP, AND TO THE HEIRS AND ASSIGNS OF SUCH Grantee forever, all that real property situated in the County of Douglas, State of Nevada, bounded and described as follows:

SEE EXHIBIT "A" ATTACHED HERETO AND MADE A PART HEREOF

THIS DEED IS PLACED OF RECORD FOR THE PURPOSE OF FACILITATING A BOUNDARY LINE ADJUSTMENT BETWEEN EXISTING PARCELS OF LAND, AS FURTHER DEPICTED AND SET FORTH ON THAT CERTAIN RECORD OF SURVEY IN SUPPORT OF BOUNDARY LINE ADJUSTMENT, RECORDED CONCURRENTLY HEREWITH.

Date: 4.1.05

BENTLY FAMILY LIMITED
PARTNERSHIP

Donald E Bently
BY:

STATE OF NEVADA } ss.
COUNTY OF DOUGLAS }

This instrument was acknowledged before me on 4.1.05,
By, Donald E Bently

Signature Cynthia L Edwards
Notary Public

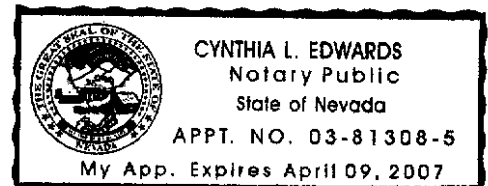

**DESCRIPTION
ADJUSTED PARCEL 3
(A.P.N. 1221-04-001-008)**

All that real property situate in the County of Douglas, State of Nevada, described as follows:

A parcel of land located within a portion of Section 4, Township 12 North, Range 21 East, Mount Diablo Meridian, more particularly described as follows:

Commencing at the southwest corner of Parcel 4 as shown on the Amended Record of Survey for Christoph J. Altemueller filed for record August 9, 1985 in the office of Recorder, Douglas County, Nevada as Document No. 121370, said point also falling on the northerly right-of-way of Jacobsen Lane;

- thence North 44°46'37" West, 43.53 feet to the POINT OF BEGINNING;
- thence continuing North 44°46'37" West, 330.93 feet;
- thence North 62°08'39" West, 16.24 feet to the southwest corner of Parcel 3 as shown on the Map of Division into Large Parcels for the Jacobsen Family Trust filed for record November 21, 1995 in said office of Recorder as Document No. 375343;
- thence North 27°51'53" East, 890.93 feet to the northwest corner of said Parcel 3;
- thence South 89°06'31" East, 1508.90 feet to the northeast corner of said Parcel 3;
- thence South 01°07'39" West, 1502.85 feet to the southeast corner of said Parcel 3;
- thence North 54°31'23" West, 1622.85 feet;
- thence South 36°12'45" West, 552.73 feet to the POINT OF BEGINNING, containing 39.56 acres, more or less.

The Basis of Bearing for this description is South 89°06'31" East, the north line of Parcel 3 as shown on the Map of Division into Large Parcels for the Jacobsen Family Trust filed for record November 21, 1995 in said office of Recorder as Document No. 375343.

Note: Refer this description to your title company before incorporating into any legal document.

Prepared By: R.O. ANDERSON ENGINEERING, INC.
P.O. Box 2229
Minden, Nevada 89423

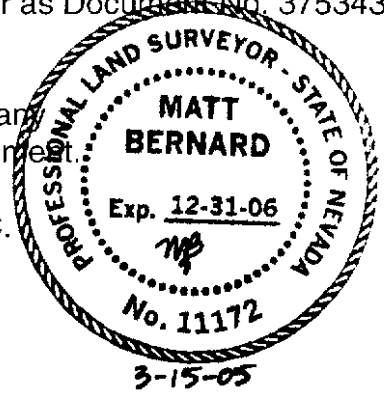

Standard Form 707 (03/01/05) Legal Use