

APN: 1220-22-111-011

Escrow No. 00141979 - JN
RPTT \$1,462.50
When Recorded Return to:
Wallace E. Adams Revocable Trust
PO BOX 315
GENOA, NV 89411

Mail Tax Statements to:

SAME AS ABOVE

Douglas County - NV
Werner Christen - Recorder
Page: 1 Of 6 Fee: 19.00
BK-0605 PG- 4339 RPTT: 1462.50



SPACE ABOVE FOR RECORDERS USE

THIS DOCUMENT IS EXECUTED IN COUNTER PART

Grant, Bargain, Sale Deed

THIS INDENTURE WITNESSETH: That WARREN K. KIRKPATRICK and MARTHA D. KIRKPATRICK, husband and wife and PAUL A. HOSTETLER and JENNIFER S. HOSTETLER, husband and wife, all as joint tenants

In consideration of \$10.00, the receipt of which is hereby acknowledged, do(es) hereby Grant, Bargain, Sell and Convey to Wallace E. Adams, as Trustee, or the Successor Trustee, of the 1999 Wallace E. Adams Revocable Trust dated September 3, 1999

all that real property situated in the County of Douglas, State of Nevada, described as follows:

See Exhibit A attached hereto and made a part hereof.

Together with all and singular the tenements, hereditaments and appurtenances thereunto belonging or in anywise appertaining.

Witness my/our hand(s) this 6 day of June, 2005

EXECUTED IN COUNTER PART

EXECUTED IN COUNTER PART

WARREN K. KIRKPATRICK

MARTHA D. KIRKPATRICK

PAUL A. HOSTETLER

JENNIFER S. HOSTETLER

SPACE BELOW FOR RECORDER

STATE OF
COUNTY OF

This instrument was acknowledged before me on _____,
by WARREN K. KIRKPATRICK and MARTHA D. KIRKPATRICK.

NOTARIZED IN COUNTER PART

NOTARY PUBLIC

STATE OF *Nevada*
COUNTY OF *Carson City*

This instrument was acknowledged before me on 6/6/05,
by PAUL A. HOSTETLER and JENNIFER S. HOSTETLER.

Jeannie Nabicht

NOTARY PUBLIC

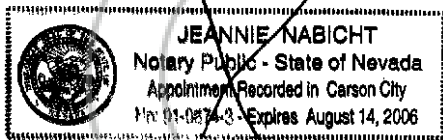

SPACE BELOW FOR RECORDER



0646572

Page: 2 of 6

BK- 0605
PG- 4340
06/10/2005

APN: 1220-22-111-011

Escrow No. 00141979 - JN
RPTT \$1,462.50
When Recorded Return to:
Wallace E. Adams Revocable Trust

Mail Tax Statements to:

SAME AS ABOVE

SPACE ABOVE FOR RECORDERS USE

THIS DOCUMENT IS EXECUTED IN COUNTER PART

Grant, Bargain, Sale Deed

THIS INDENTURE WITNESSETH: That WARREN K. KIRKPATRICK and MARTHA D. KIRKPATRICK, husband and wife and PAUL A. HOSTETLER and JENNIFER S. HOSTETLER, husband and wife, all as joint tenants

In consideration of \$10.00, the receipt of which is hereby acknowledged, do(es) hereby Grant, Bargain, Sell and Convey to Wallace E. Adams, as Trustee, or the Successor Trustee, of the 1999 Wallace E. Adams Revocable Trust dated September 3, 1999

all that real property situated in the County of Douglas, State of Nevada, described as follows:

See Exhibit A attached hereto and made a part hereof.

Together with all and singular the tenements, hereditaments and appurtenances thereunto belonging or in anywise appertaining.

Witness my/our hand(s) this 4th day of JUNE, 2005

Warren K. Kirkpatrick
WARREN K. KIRKPATRICK

Martha D. Kirkpatrick
MARTHA D. KIRKPATRICK

EXECUTED IN COUNTER PART

EXECUTED IN COUNTER PART

PAUL A. HOSTETLER

JENNIFER S. HOSTETLER

SPACE BELOW FOR RECORDER



STATE OF
COUNTY OF

This instrument was acknowledged before me on _____,
by WARREN K. KIRKPATRICK and MARTHA D. KIRKPATRICK.

SEE ATTACHED

NOTARY PUBLIC

STATE OF
COUNTY OF

This instrument was acknowledged before me on _____,
by PAUL A. HOSTETLER and JENNIFER S. HOSTETLER.

NOTARIZED IN COUNTER PART

NOTARY PUBLIC

SPACE BELOW FOR RECORDER _____



CALIFORNIA ALL-PURPOSE ACKNOWLEDGMENT

State of California }
County of LOS ANGELES } ss.

On JUNE 4, 2005 before me, CHRISTOPHER PERRY
Date Name and Title of Officer (e.g., "Jane Doe, Notary Public")
personally appeared WARREN K. KIRKPATRICK & MARITHA KIRKPATRICK
Name(s) of Signer(s)

personally known to me
 proved to me on the basis of satisfactory evidence

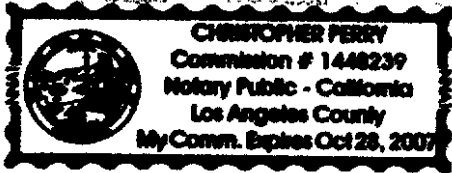

to be the person(s) whose name(s) ~~is~~/are subscribed to the within instrument and acknowledged to me that ~~he~~/she/they executed the same in ~~his~~/her/their authorized capacity(ies), and that by ~~his~~/her/their signature(s) on the instrument the person(s), or the entity upon behalf of which the person(s) acted, executed the instrument.

WITNESS my hand and official seal.

Christopher Perry
Signature of Notary Public

OPTIONAL

Though the information below is not required by law, it may prove valuable to persons relying on the document and could prevent fraudulent removal and reattachment of this form to another document.

Description of Attached Document

Title or Type of Document: _____

Document Date: _____ Number of Pages: _____

Signer(s) Other Than Named Above: _____

Capacity(ies) Claimed by Signer

Signer's Name: _____

- Individual
- Corporate Officer — Title(s): _____
- Partner — Limited General
- Attorney-in-Fact
- Trustee
- Guardian or Conservator
- Other: _____

Signer is Representing: _____

RIGHT THUMBPRINT OF SIGNER

Top of thumb here

Exhibit A

Lot 163, of the Amended Map of GARDNERVILLE RANCHOS UNIT NO. 5, filed in the Office of the County Recorder of Douglas County, Nevada, on August 4, 1994, in Book 894, Page 744, as Document No. 343296.

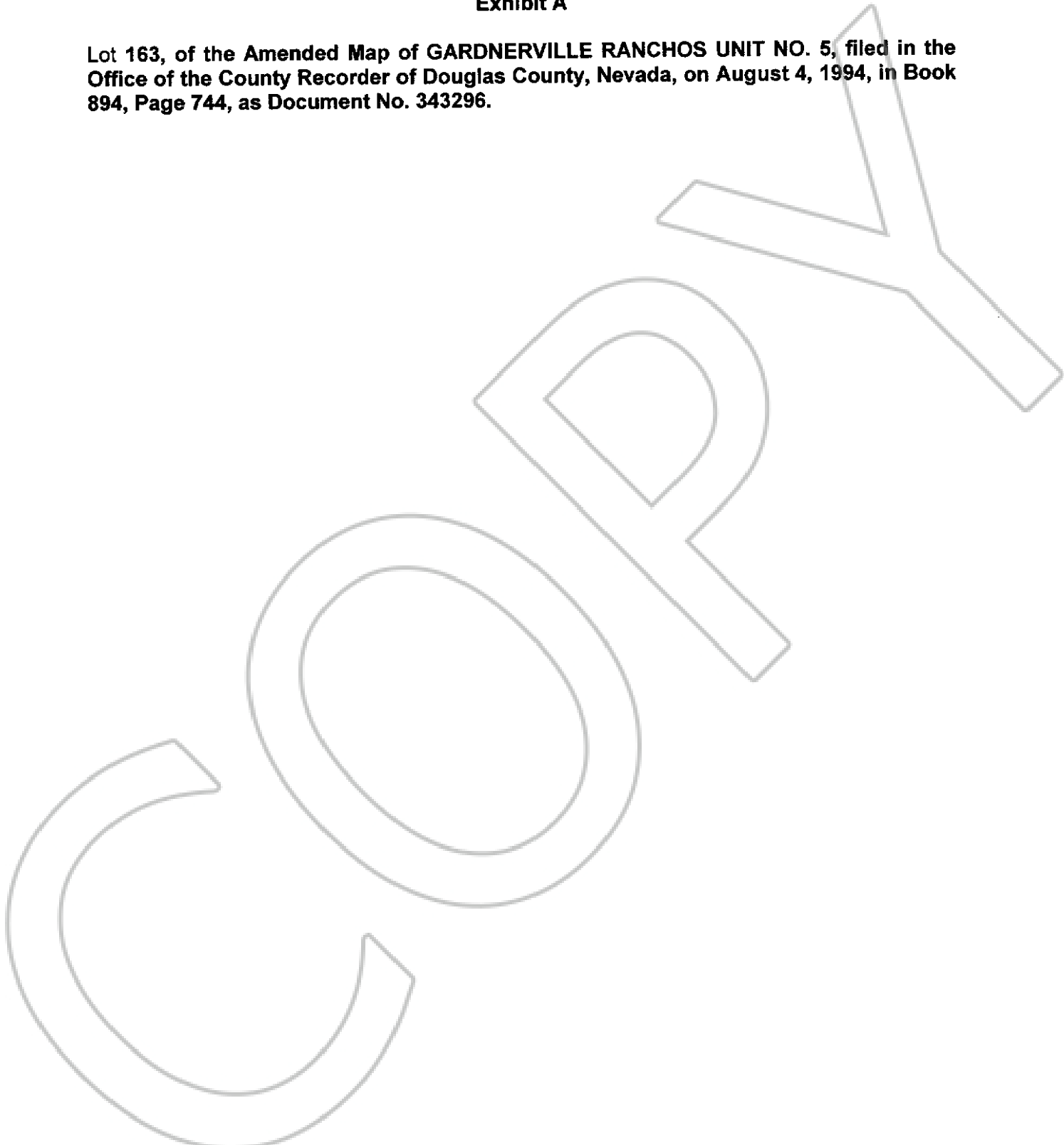

SPACE BELOW FOR RECORDER

