

OFFICIAL RECORD

Requested By:

FIRST CENTENNIAL TITLE

APN: 1320-33-715-025

Escrow No. 00142979 - DXC

RPTT 1552.20

When Recorded Return to:

SYLVIA K. CAIRES
1338 BROOKE WAY
GARDNERVILLE, NV 89410

Mail Tax Statements to:

SAME AS ABOVE

Douglas County - NV
Werner Christen - Recorder
Page: 1 Of 2 Fee: 15.00
BK-0705 PG- 452 RPTT: 1552.20



SPACE ABOVE FOR RECORDERS USE

Grant, Bargain, Sale Deed

THIS INDENTURE WITNESSETH: That THE STONECREST GROUP, LLC, a Nevada limited liability company

In consideration of \$10.00, the receipt of which is hereby acknowledged, do(es) hereby Grant, Bargain, Sell and Convey to SYLVIA K. CAIRES, a Widow

all that real property situated in the County of Douglas, State of Nevada, described as follows:

See Exhibit A attached hereto and made a part hereof.

Together with all and singular the tenements, hereditaments and appurtenances thereunto belonging or in anywise appertaining.

Witness my/our hand(s) this 22nd day of June, 2005.

THE STONECREST GROUP, LLC

ANA AMICARELLA, Manager

STATE OF NEVADA
COUNTY OF CARSON CITY

This instrument was acknowledged before me on 6/22/05,
by ANA AMICARELLA.

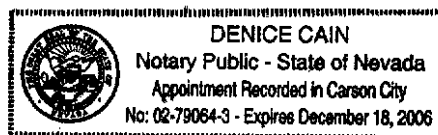

NOTARY PUBLIC



SPACE BELOW FOR RECORDER

Exhibit A

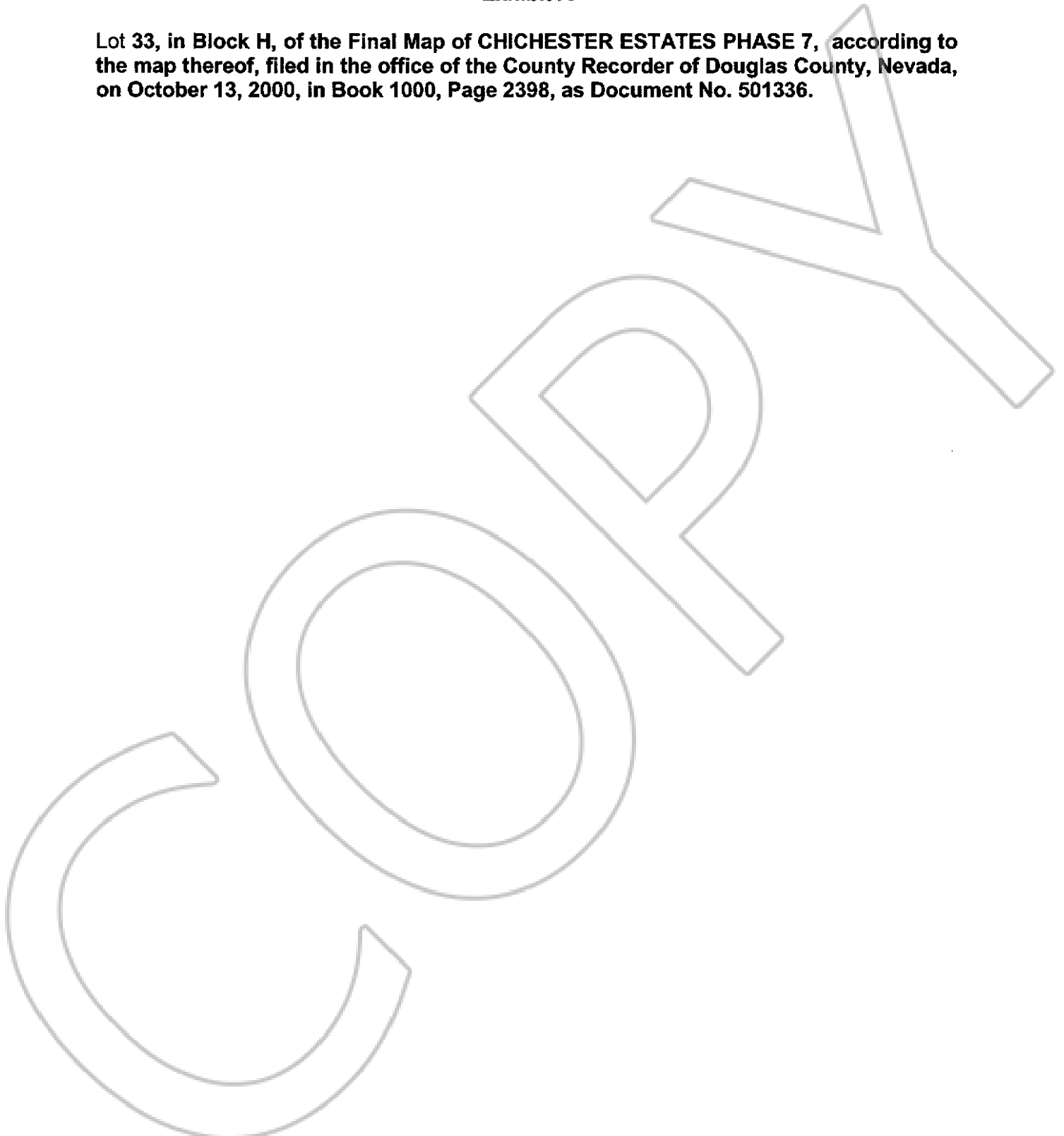
Lot 33, in Block H, of the Final Map of CHICHESTER ESTATES PHASE 7, according to the map thereof, filed in the office of the County Recorder of Douglas County, Nevada, on October 13, 2000, in Book 1000, Page 2398, as Document No. 501336.



SPACE BELOW FOR RECORDER

