

DOC # 0650002  
07/20/2005 10:32 AM Deputy: KLJ

OFFICIAL RECORD  
Requested By:  
STEWART TITLE OF DOUGLAS

Assessor's Parcel Number:  
1318-23-217-001  
After Recording Return To:

COUNTY  
Douglas County - NV  
Werner Christen - Recorder  
Page: 1 Of 11 Fee: 24.00  
BK-0705 PG- 8928 RPTT: 0.00



Prepared By:  
SCME MORTGAGE, INC.  
6265 GREENWICH DRIVE, #200  
SAN DIEGO, CA 92122

Recording Requested By:  
SCME MORTGAGE BANKERS, INC.

050501664 [Space Above This Line For Recording Data]

## DEED OF TRUST

(Line of Credit)

LOAN NO.: 64008885  
ESCROW NO.: 203-5241

MIN: 100031800640088856  
MERS Phone: 1-888-679-6377

THIS DEED OF TRUST, dated JULY 12, 2005, is between  
CHARLES BLAIR, AN UNMARRIED MAN

residing at  
174A TAHOMA CIRCLE, STATELINE, NV 89449  
the person or persons signing as "Grantor(s)" below and hereinafter referred to as "we" or "us" and  
STEWART TITLE COMPANY

as trustee and hereinafter referred to as the "Trustee," with an address at  
1663 US HIGHWAY 395 N, STE 101, MINDEN, NV 89423-  
for the benefit of "Mortgage Electronic Registration Systems, Inc. ("MERS") (solely as nominee for  
SCME MORTGAGE, INC., A CALIFORNIA CORPORATION

(hereinafter "you" or "Lender") and Lender's successors and assigns), with an address at P.O. Box 2026, Flint,  
MI 48501-2026, tel. (888) 679-MERS, referred to as the "Beneficiary."

Borrower understands and agrees that MERS holds only legal title to the interests granted by Borrower in the  
Deed of Trust; but, if necessary to comply with law or custom, MERS, (as nominee for Lender and Lender's  
successors and assigns), has the right: to exercise any or all of those interests, including, but not limited to, the  
right to foreclose and sell the Premises; and to take any action required of Lender including, but not limited to,  
releasing or canceling this Deed of Trust.

Initials:

HELOC - NV Deed of Trust with MERS  
FE - 4331(NV) (0307)

Page 1 of 7

LENDER SUPPORT SYSTEMS, INC. CW31-31NV.CW31 (12/03)

1/98

**RIDERS TO THIS SECURITY INSTRUMENT:** If one or more riders are executed by Borrower and recorded together with this Security Instrument, the covenants and agreements of each such rider shall be incorporated into and shall amend and supplement the covenants and agreements of this Security Instrument as if the rider(s) were a part of this Security Instrument.  
[Check box below]

PUD RIDER

**PREMISES:** In consideration of the loan hereinafter described, we hereby mortgage, grant and convey to the Trustee the premises located at:

174A TAHOMA CIRCLE STATELINE Street, Municipality

DOUGLAS Nevada 89449 (the "Premises").  
County ZIP

and further described as:

SEE COMPLETE LEGAL DESCRIPTION DESCRIBED IN EXHIBIT "A" ATTACHED HERETO AND MADE A PART HEREOF

Parcel ID Number: 1318-23-217-001

The Premises includes all buildings and other improvements now or in the future on the Premises and all rights and interests which derive from our ownership, use or possession of the Premises and all appurtenances thereto.

**LOAN:** The Deed of Trust will secure your loan in the principal amount of \$ 100,000.00 or so much thereof as may be advanced and readvanced from time to time to CHARLES BLAIR

the Borrower(s) under the Home Equity Credit Line Agreement and Disclosure Statement (the "Note") dated JULY 12, 2005, plus interest and costs, late charges and all other charges related to the loan, all of which sums are repayable according to the Note. This Deed of Trust will also secure the performance of all of the promises and agreements made by us and each Borrower and Co-Signer in the Note, all of our promises and agreements in this Deed of Trust, any extensions, renewals, amendments, supplements and other modifications of the Note, and any amounts advanced by you under the terms of the section of this Deed of Trust entitled "Our Authority To You." Loans under the Note may be made, repaid and remade from time to time in accordance with the terms of the Note and subject to the Credit Limit set forth in the Note.

**OWNERSHIP:** We are the sole owner(s) of the Premises. We have the legal right to mortgage, grant and convey the Premises to the Trustee.

**BORROWER'S IMPORTANT OBLIGATIONS:**

(a) **TAXES:** We will pay all real estate taxes, assessments, water charges and sewer rents relating to the Premises when they become due. We will not claim any credit on, or make deduction from, the loan under the Note because we pay these taxes and charges. We will provide you with proof of payment upon request.

FE - 4331(NV) (0307)

Page 2 of 7

Initials: 



BK- 0705  
PG- 8929  
0650002 Page: 2 Of 11 07/20/2005

(b) MAINTENANCE: We will maintain the building(s) on the Premises in good condition. We will not make major changes in the building(s) except for normal repairs. We will not tear down any of the building(s) on the Premises without first getting your consent. We will not use the Premises illegally. If this Deed of Trust is on a unit in a condominium or a planned unit development, we shall perform all of our obligations under the declaration or covenants creating or governing the condominium or planned unit development, the by-laws and regulations of the condominium or planned unit development and constituent documents.

(c) INSURANCE: We will keep the building(s) on the Premises insured at all times against loss by fire, flood and any other hazards you may specify. We may choose the insurance company, but our choice is subject to your reasonable approval. The policies must be for at least the amounts and the time periods that you specify. We will deliver to you upon your request the policies or other proof of the insurance. The policies must name you as "mortgagee" and "loss-payee" so that you will receive payment on all insurance claims, to the extent of your interest under this Deed of Trust, before we do. The insurance policies must also provide that you be given not less than 10 days prior written notice of any cancellation or reduction in coverage, for any reason. Upon request, we shall deliver the policies, certificates or other evidence of insurance to you. In the event of loss or damage to the Premises, we will immediately notify you in writing and file a proof of loss with the insurer. You may file a proof of loss on our behalf if we fail or refuse to do so. You may also sign our name to any check, draft or other order for the payment of insurance proceeds in the event of loss or damage to the Premises. If you receive payment of a claim, you will have the right to choose to use the money either to repair the Premises or to reduce the amount owing on the Note.

(d) CONDEMNATION: We assign to you the proceeds of any award or claim for damages, direct or consequential, in connection with any condemnation or other taking of the Premises, or part thereof, or for conveyance in lieu of condemnation, all of which shall be paid to you, subject to the terms of any Prior Deed of Trust.

(e) SECURITY INTEREST: We will join with you in signing and filing documents and, at our expense, in doing whatever you believe is necessary to perfect and continue the perfection of your lien and security interest in the Premises.

(f) OUR AUTHORITY TO YOU: If we fail to perform our obligations under this Deed of Trust, you may, if you choose, perform our obligations and pay such costs and expenses. You will add the amounts you advance to the sums owing on the Note, on which you will charge interest at the interest rate set forth in the Note. If, for example, we fail to honor our promises to maintain insurance in effect, or to pay filing fees, taxes or the costs necessary to keep the Premises in good condition and repair or to perform any of our other agreements with you, you may, if you choose, advance any sums to satisfy any of our agreements with you and charge us interest on such advances at the interest rate set forth in the Note. This Deed of Trust secures all such advances. Your payments on our behalf will not cure our failure to perform our promises in this Deed of Trust. Any replacement insurance that you obtain to cover loss or damages to the Premises may be limited to the amount owing on the Note plus the amount of any Prior Deeds of Trust.

(g) PRIOR DEED OF TRUST: If the provisions of this paragraph are completed, this Deed of Trust is subject and subordinate to a prior deed of trust dated \_\_\_\_\_ and given by us for the benefit of

as beneficiary, in the original amount of \$ \_\_\_\_\_ (the "Prior Deed of Trust"). We shall not increase, amend or modify the Prior Deed of Trust without your prior written consent and shall upon receipt of any written notice from the holder of the Prior Deed of Trust promptly deliver a copy of such notice to you. We shall pay and perform all of our obligations under the Prior Deed of Trust as and when required under the Prior Deed of Trust.

(h) **HAZARDOUS SUBSTANCES:** We shall not cause or permit the presence, use, disposal, storage, or release of any Hazardous Substances on or in the Premises. We shall not do, nor allow anyone else to do, anything affecting the Premises that is in violation of any Environmental Law. The preceding two sentences shall not apply to the presence, use, or storage on the Premises of small quantities of Hazardous Substances that are generally recognized to be appropriate to normal residential uses and to maintenance of the Premises. As used in this paragraph, "Hazardous Substances" are those substances defined as toxic or hazardous substances by Environmental Law and the following substances: gasoline, kerosene, other flammable or toxic petroleum products, toxic pesticides and herbicides, volatile solvents, materials containing asbestos or formaldehyde, and the radioactive materials. As used in this paragraph, "Environmental Law" means federal laws and laws of the jurisdiction where the Premises are located that relate to health, safety or environmental protection.

(i) **SALE OF PREMISES:** We will not sell, transfer ownership of, mortgage or otherwise dispose of our interest in the Premises, in whole or in part, or permit any other lien or claim against the Premises without your prior written consent.

(j) **DUE-ON-SALE:** In the event that we, or any successor to our interest in the Premises, sells or contracts to sell or transfers any interest in the Premises, either voluntarily or involuntarily, at your option, you may declare the full amount owed under the Note and secured by this Deed of Trust immediately due and payable even though the time for maturity as expressed in the Note may not have arrived.

(k) **INSPECTION:** We will permit you to inspect the Premises at any reasonable time.

**NO LOSS OF RIGHTS:** The Note and this Deed of Trust may be negotiated or assigned by you without releasing us or the Premises. You may add or release any person or property obligated under the Note and this Deed of Trust without losing your rights in the Premises.

**DEFAULT; ACCELERATION:** Except as may be prohibited by applicable law, and subject to any advance notice and cure period if required by applicable law, if any event or condition described in Paragraph 12.A of the Note occurs, you may declare all amounts secured by this Deed of Trust immediately due and payable and the Trustee may foreclose upon this Deed of Trust or sell the Premises at a public sale. This means that you or the Trustee may arrange for the Premises to be sold, as provided by law, in order to pay off what we owe on the Note and under this Deed of Trust. If the money you receive from the sale is not enough to pay off what we owe you, we will still owe you the difference which you may seek to collect from us in accordance with applicable law. In addition, you or the Trustee may, in accordance with applicable law, (i) enter on and take possession of the Premises; (ii) collect the rental payments, including over-due rental payments, directly from tenants; (iii) manage the Premises; and (iv) sign, cancel and change leases. We agree that the interest rate set forth in the Note will continue before and after a default, entry of a judgment and foreclosure or public sale. In addition, you shall be entitled to collect all reasonable fees and costs actually incurred by you in proceeding to foreclosure or to public sale, including, but not limited to, trustee's fees, reasonable attorneys' fees and costs of documentary evidence, abstracts and title reports.



**ABSOLUTE ASSIGNMENT OF RENTS; APPOINTMENT OF RECEIVER:** We hereby unconditionally assign to you the rents of the Premises. Nevertheless, you will allow us to use the rents, if any, until such time as any event or condition of default as described in Paragraph 12.A of the Note occurs. You or a receiver appointed by the courts shall be entitled to enter upon, take possession of and manage the Premises and collect the rents of the Premises including those past due.

**WAIVERS:** To the extent permitted by applicable law, we waive and release any error or defects in proceedings to enforce this Deed of Trust and hereby waive the benefit of any present or future laws providing for stay of execution, extension of time, exemption from attachment, levy and sale and homestead exemption.

**BINDING EFFECT:** Each of us shall be fully responsible for all of the promises and agreements in this Deed of Trust. Until the Note has been paid in full and your obligation to make further advances under the Note has been terminated, the provisions of this Deed of Trust will be binding on us, our legal representatives, our heirs and all future owners of the Premises. This Deed of Trust is for your benefit and for the benefit of anyone to whom you may assign it. Upon payment in full of all amounts owing to you under the Note and this Deed of Trust, and provided any obligation to make further advances under the Note has terminated, this Deed of Trust and your rights in the Premises shall end.

**NOTICE:** Except for any notice required under applicable law to be given in another manner, (a) any notice to us provided for in this Deed of Trust shall be given by delivering it or by mailing such notice by regular first class mail addressed to us at the last address appearing in your records or at such other address as we may designate by notice to you as provided herein, and (b) any notice to you shall be given by certified mail, return receipt requested, to your address at

174A TAHOMA CIRCLE, STATELINE, NV 89449

or to such other address as you may designate by notice to us. Any notice provided for in this Deed of Trust shall be deemed to have been given to us or you when given in the manner designated herein.

**RELEASE:** Upon payment of all sums secured by this Deed of Trust and provided your obligation to make further advances under the Note has terminated, the Trustee shall discharge this Deed of Trust without charge to us, except that we shall pay any fees for recording of a satisfaction of this Deed of Trust.

**GENERAL:** You or the Trustee can waive or delay enforcing any of your rights under this Deed of Trust without losing them. Any waiver by you of any provisions of this Deed of Trust will not be a waiver of that or any other provision on any other occasion.



TRUSTEE: Trustee accepts the trusts herein created when this Deed of Trust, duly executed and acknowledged, is made a public record as provided by law. Trustee, by its acceptance hereof, agrees to perform and fulfill the trusts herein created, and shall be liable only for its negligence or misconduct. The Trustee waives any statutory fee and agrees to accept reasonable compensation from Grantor for any services rendered by it in accordance with the terms of this Deed of Trust. Upon receipt by Trustee of instructions from Beneficiary at any time or from time to time, Trustee shall (a) give any notice or direction or exercise any right, remedy or power hereunder or in respect of the Premises as shall be specified in such instructions, and (b) approve as satisfactory all matters required by the terms hereof to be satisfactory to Trustee or Beneficiary. Trustee may, but need not, take any of such actions in the absence of such instructions. Trustee may resign at any time upon giving of not less than 30 days' prior notice to Beneficiary, but will continue to act as trustee until its successor shall have been chosen and qualified. In the event of the death, removal, resignation, or refusal or inability to act of Trustee, Beneficiary shall have the irrevocable power, with or without cause, without notice of any kind, without specifying any reason therefor, and without applying to any court, to select and appoint a successor trustee by filing a deed or other instrument of appointment for record in each office in which this Deed of Trust is recorded, and upon such recordation the successor trustee shall become vested with the same powers, rights, duties and authority of the Trustee with the same effect as if originally made Trustee hereunder. Such successor shall not be required to give bond for the faithful performance of its duties unless required by Beneficiary.

THIS DEED OF TRUST has been signed by each of us under seal on the date first above written.

WITNESS:

\_\_\_\_\_  
-Witness

\_\_\_\_\_  
-Witness

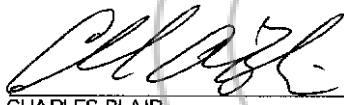
  
\_\_\_\_\_  
CHARLES BLAIR (Seal)  
-Borrower

\_\_\_\_\_  
(Seal)  
-Borrower

\_\_\_\_\_  
(Seal)  
-Borrower

\_\_\_\_\_  
(Seal)  
-Borrower

\_\_\_\_\_  
(Seal)  
-Borrower

\_\_\_\_\_  
(Seal)  
-Borrower

\_\_\_\_\_  
(Seal)  
-Borrower

\_\_\_\_\_  
(Seal)  
-Borrower



STATE OF ~~NEVADA~~ *California*  
COUNTY OF *El Dorado*

This instrument was acknowledged before me on *July 13, 2005* by  
CHARLES BLAIR



*Erika Stefka Brownell*

Mail Tax Statements To:  
SCME MORTGAGE, INC.  
6265 GREENWICH DRIVE, #200  
SAN DIEGO, CA 92122

*COPIES*

Order No.: 050501664

**LEGAL DESCRIPTION**

The land referred to herein is situated in the State of Nevada,  
County of DOUGLAS, described as follows:

Lot 6A, of LAKE VILLAGE, UNIT NO. 2-B, as shown on the  
Official Map filed in the Office of the County Recorder of  
Douglas County, Nevada, on December 28, 1971, in Book 2 of  
Maps, as Document No. 56076.

Assessment Parcel No. 1318-23-217-001

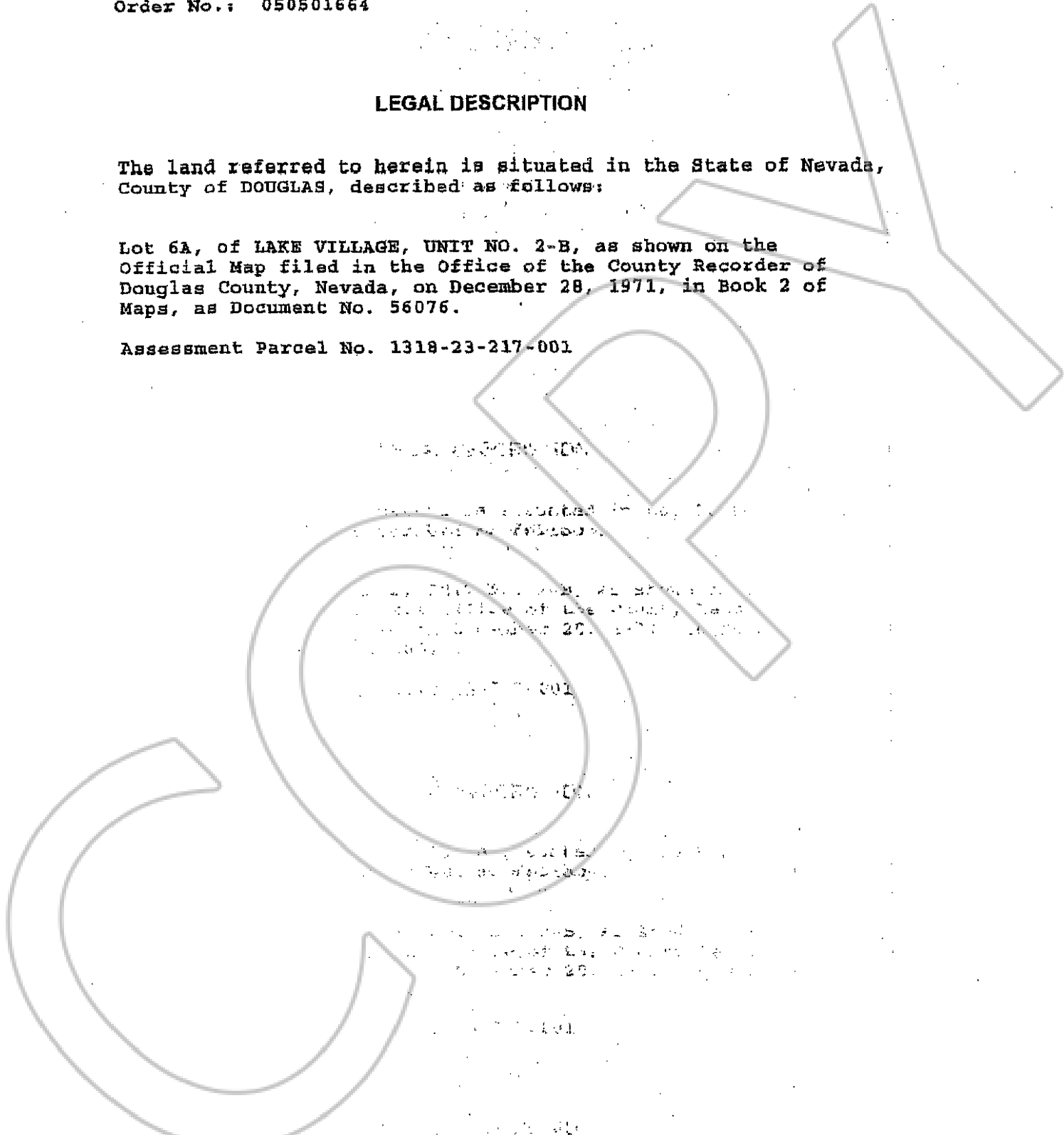

SCHEDULE A  
CLTA PRELIMINARY REPORT  
(12/92)

**STEWART TITLE**  
Guaranty Company





Return To:  
SCME MORTGAGE, INC.

6265 GREENWICH DRIVE, #200  
SAN DIEGO, CA 92122

[Space Above This Line For Recording Data]

## PLANNED UNIT DEVELOPMENT RIDER

MIN: 100031800640088856  
MERS Phone: 1-888-679-6377

Prepared By:

DOC ID# 64008885

THIS PLANNED UNIT DEVELOPMENT RIDER is made this 12th day of JULY, 2005, and is incorporated into and shall be deemed to amend and supplement the Mortgage, Deed of Trust or Security Deed (the "Security Instrument") of the same date, given by the undersigned (the "Borrower") to secure Borrower's Note to SCME MORTGAGE, INC.

(the "Lender") of the same date and covering the Property described in the Security Instrument and located at:

174A TAHOMA CIRCLE, STATELINE, NV 89449

[Property Address]

Initials: 

3/99

MULTISTATE PUD RIDER - Single Family/Second Mortgage  
FE-4256 (0207)

Page 1 of 3

LENDER SUPPORT SYSTEMS, INC. CWH-4256.CWH (07/03)



BK- 0705  
PG- 8936  
0650002 Page: 9 Of 11 07/20/2005

The Property includes, but is not limited to, a parcel of land improved with a dwelling, together with other such parcels and certain common areas and facilities, as described in  
SEE COMPLETE LEGAL DESCRIPTION DESCRIBED IN EXHIBIT "A" ATTACHED HERETO AND MADE A PART HEREOF

(the "Declaration"). The Property is a part of a planned unit development known as  
LAKE VILLAGE  
[Name of Planned Unit Development]

(the "PUD"). The Property also includes Borrower's interest in the homeowners association or equivalent entity owning or managing the common areas and facilities of the PUD (the "Owners Association") and the uses, benefits and proceeds of Borrower's interest.

**PUD COVENANTS.** In addition to the covenants and agreements made in the Security Instrument, Borrower and Lender further covenant and agree as follows:

A. **PUD Obligations.** Borrower shall perform all of Borrower's obligations under the PUD's Constituent Documents. The "Constituent Documents" are the: (i) Declaration; (ii) articles of incorporation, trust instrument or any equivalent document which creates the Owners Association; and (iii) any by-laws or other rules or regulations of the Owners Association. Borrower shall promptly pay, when due, all dues and assessments imposed pursuant to the Constituent Documents.

B. **Hazard Insurance.** So long as the Owners Association maintains, with a generally accepted insurance carrier, a "master" or "blanket" policy insuring the Property which is satisfactory to Lender and which provides insurance coverage in the amounts (including deductible levels), for the periods, and against loss by fire, hazards included within the term "extended coverage," and any other hazards, including, but not limited to, earthquakes and floods, for which Lender requires insurance, then: (i) Lender waives the provision in Uniform Covenant 2 for the monthly payment to Lender of the yearly premium installments for hazard insurance on the Property; and (ii) Borrower's obligation under Uniform Covenant 5 to maintain hazard insurance coverage on the Property is deemed satisfied to the extent that the required coverage is provided by the Owners Association policy.

What Lender requires as a condition of this waiver can change during the term of the loan.

Borrower shall give Lender prompt notice of any lapse in required hazard insurance coverage provided by the master or blanket policy.

In the event of a distribution of hazard insurance proceeds in lieu of restoration or repair following a loss to the Property, or to common areas and facilities of the PUD, any proceeds payable to Borrower are hereby assigned and shall be paid to Lender. Lender shall apply the proceeds to the sums secured by the Security Instrument, with the excess, if any, paid to Borrower.

C. **Public Liability Insurance.** Borrower shall take such actions as may be reasonable to insure that the Owners Association maintains a public liability insurance policy acceptable in form, amount, and extent of coverage to Lender.

D. Condemnation. The proceeds of any award or claim for damages, direct or consequential, payable to borrower in connection with any condemnation or other taking of all or any part of the Property or the common areas and facilities of the PUD, or for any conveyance in lieu of condemnation, are hereby assigned and shall be paid to Lender. Such proceeds shall be applied by Lender to the sums secured by the Security Instrument as provided in Uniform Covenant 9.

E. Lender's Prior Consent. Borrower shall not, except after notice to Lender and with Lender's prior written consent, either partition or subdivide the Property or consent to: (i) the abandonment or termination of the PUD, except for abandonment or termination required by law in the case of substantial destruction by fire or other casualty or in the case of a taking by condemnation or eminent domain; (ii) any amendment to any provision of the "Constituent Documents" if the provision is for the express benefit of Lender; (iii) termination of professional management and assumption of self-management of the Owners Association; or (iv) any action which would have the effect of rendering the public liability insurance coverage maintained by the Owners Association unacceptable to Lender.

F. Remedies. If Borrower does not pay PUD dues and assessments when due, then Lender may pay them. Any amounts disbursed by Lender under this paragraph F shall become additional debt of Borrower secured by the Security Instrument. Unless Borrower and Lender agree to other terms of payment, these amounts shall bear interest from the date of disbursement at the Note rate and shall be payable, with interest, upon notice from Lender to Borrower requesting payment.

BY SIGNING BELOW, Borrower accepts and agrees to the terms and provisions contained in this PUD Rider.

  
CHARLES BLAIR

(Seal)  
-Borrower

(Seal)  
-Borrower

(Seal)  
-Borrower

(Seal)  
-Borrower

(Seal)  
-Borrower

(Seal)  
-Borrower

(Seal)  
-Borrower

(Seal)  
-Borrower

