

**OFFICIAL RECORD**

Requested By:

FIRST CENTENNIAL TITLE

APN: 1420-34-201-018

Escrow No. 00144763 - CT  
RPTT \$0.00#5

When Recorded Return to:

Mail Tax Statements to:

James Gentry  
2743 Kayne Ave  
Minden, NV 89423

Douglas County - NV  
Werner Christen - Recorder  
Page: 1 Of 2 Fee: 15.00  
BK-0705 PG- 9740 RPTT: # 5



144763-CT

SPACE ABOVE FOR RECORDERS USE

**Grant, Bargain, Sale Deed**

THIS INDENTURE WITNESSETH: That  
James Gentry, an unmarried man

In consideration of \$10.00, the receipt of which is hereby acknowledged, do(es) hereby  
Grant, Bargain, Sell and Convey to  
James Gentry and Kelly M. Gentry, husband and wife as joint tenants

all that real property situated in the City of Minden, County of Douglas,  
State of Nevada, described as follows:

See Exhibit A attached hereto and made a part hereof.

Together with all and singular the tenements, hereditaments and appurtenances thereunto  
belonging or in anywise appertaining.

Witness my/our hand(s) this

James Gentry

Kelly M. Gentry

STATE OF NEVADA  
COUNTY OF DOUGLAS

This instrument was acknowledged before me on July 20, 2005  
by James Gentry and Kelly M. Gentry

NOTARY PUBLIC



SPACE BELOW FOR RECORDER

Exhibit A

PARCEL B as set forth on that certain Parcel Map for Gerald C. Kiliszewski, et ux, filed for record in the Office of the County Recorder of Douglas County, State of Nevada, on August 8, 1990 as Document No. 231922.

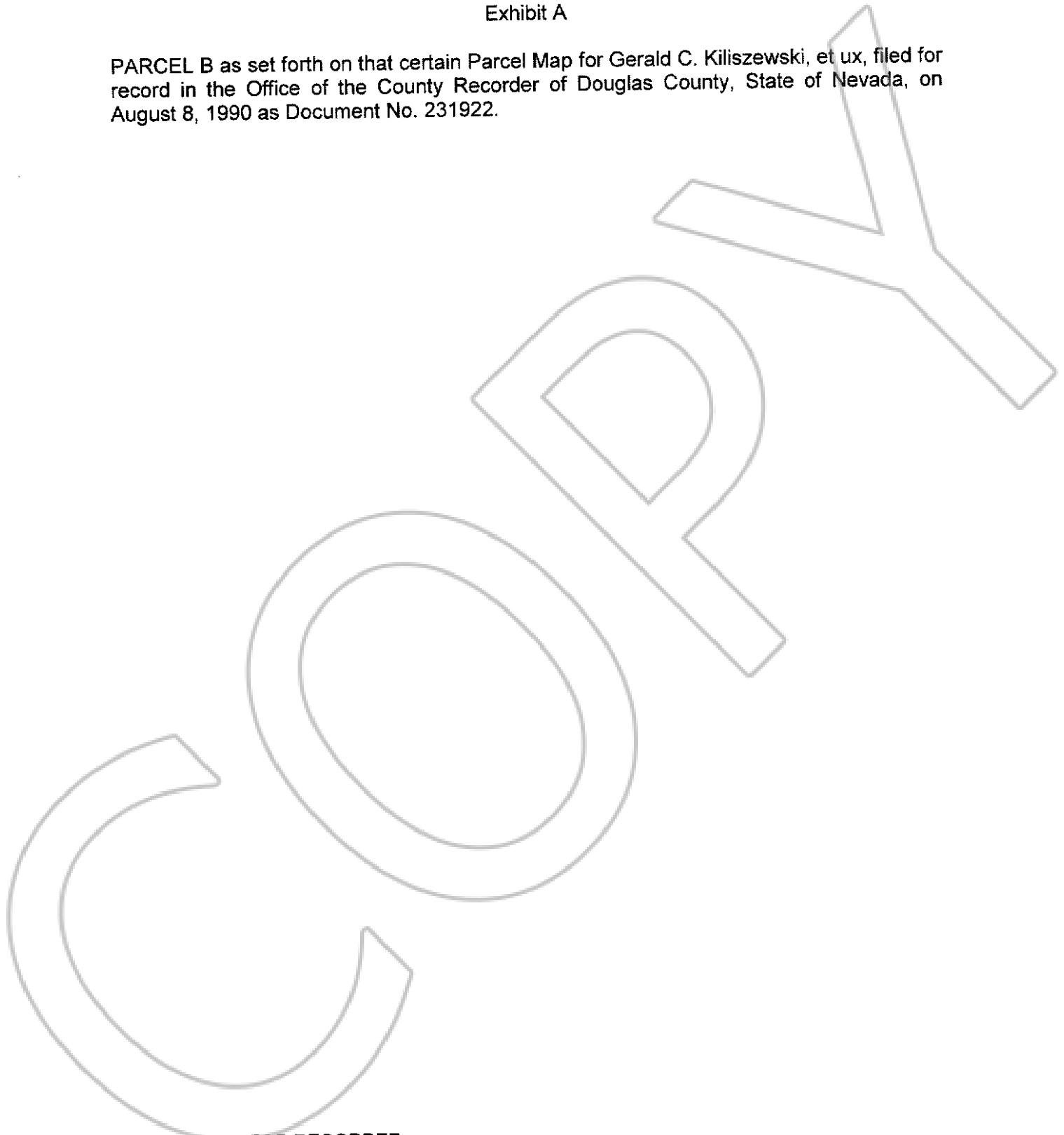

SPACE BELOW FOR RECORDER

